

**ABUTMENT #2 PLAN**

SCALE 1/4" = 1'-0"  
 1 0 2 4 6

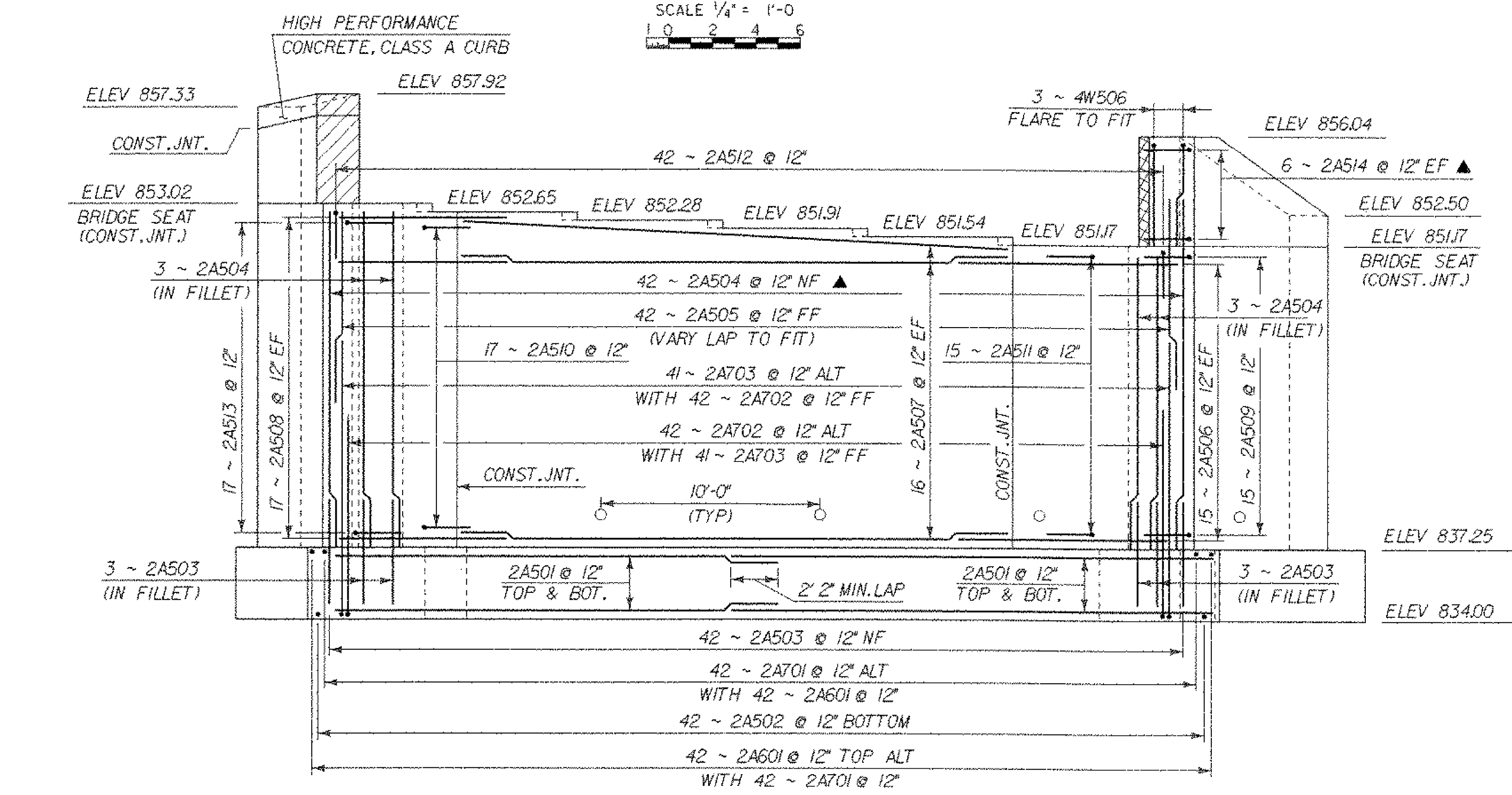

**ABUTMENT #2 ELEVATION**

SCALE 1/4" = 1'-0"  
 1 0 2 4 6

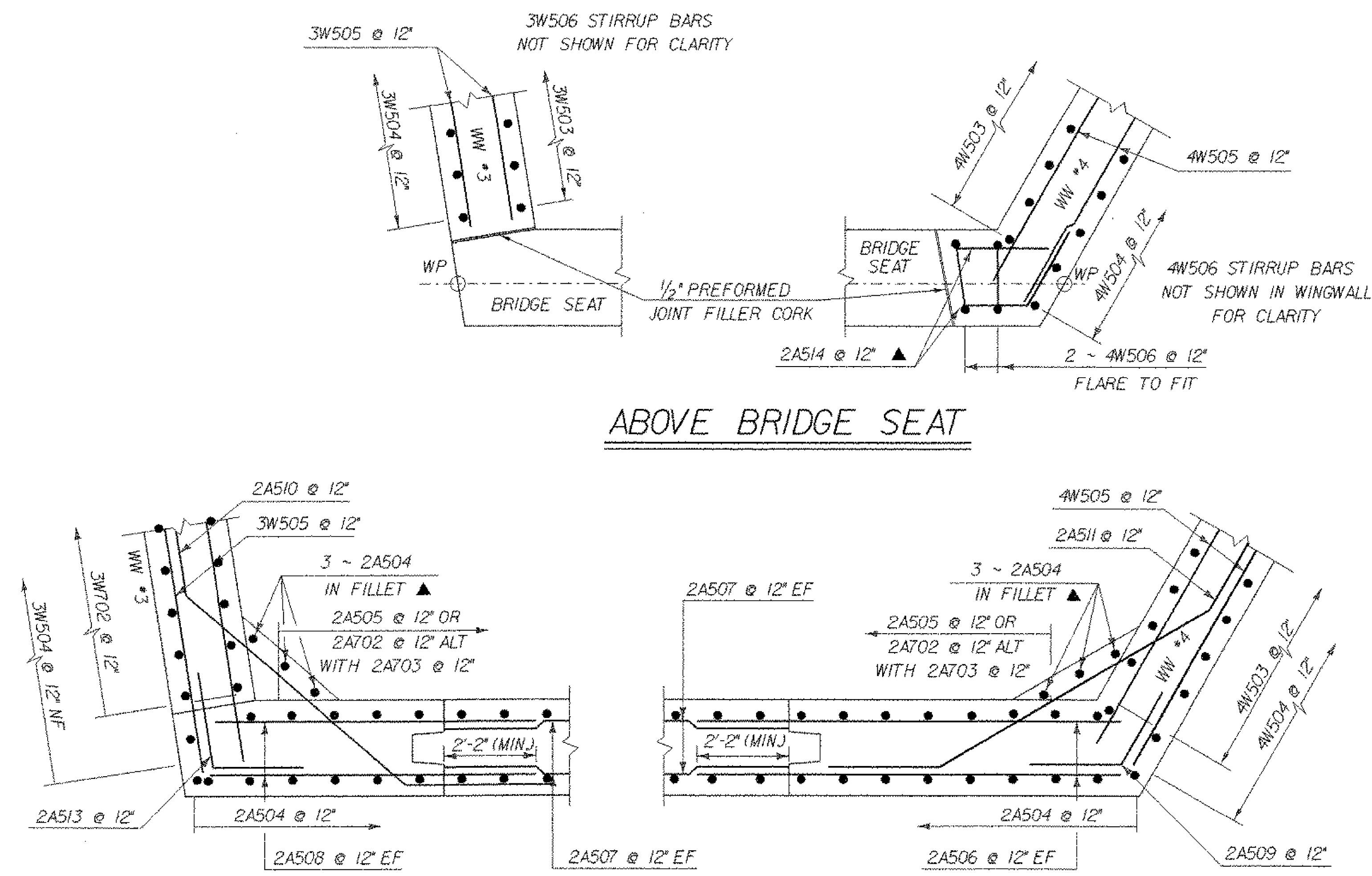

**ABOVE BRIDGE SEAT**

**BELOW BRIDGE SEAT**  
**ABUTMENT #2 CORNER DETAILS**

NOTE - STIRRUP BARS OMITTED FOR CLARITY

SCALE 1/2" = 1'-0"  
 1 0 1 2

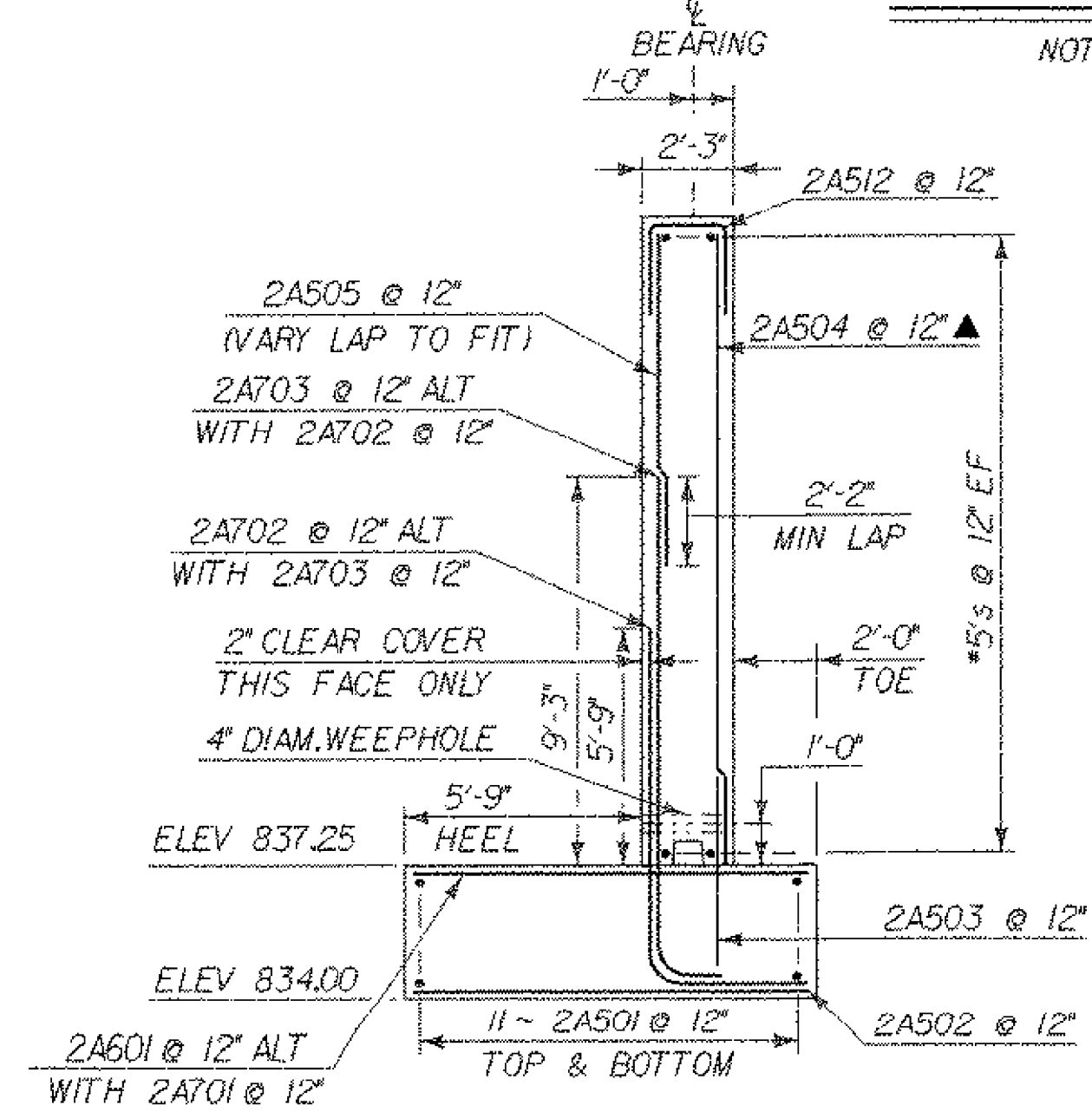

**ABUTMENT #2 TYPICAL SECTION**

SCALE 1/4" = 1'-0"  
 1 0 2 4 6

- NOTES:**
1. NF = NEAR FACE
  2. FF = FAR FACE
  3. EF = EACH FACE
  4. ▲ = CUT TO FIT IN FIELD
  5. 3' CLR. UNLESS OTHERWISE SPECIFIED ON THE PLANS.
  6. LAP SPLICES ARE 2'-2" UNLESS OTHERWISE NOTED.
  7. SEE SHT. 56 FOR SCORE MARK DETAILS

SHEET NAME: <b>ABUTMENT #2 DETAILS</b>	
PROJECT NAME: <b>READING</b>	HIGHWAY NO.: <b>VT 44</b>
PROJECT NUMBER: <b>BRS 0148(6)S</b>	BRIDGE NO.: <b>1</b>
	OVER: <b>THE MILL BROOK</b>
FILE NAME: <b>PW/85e034/Structures/se034sub.dgn</b>	PLOT DATE: <b>17-FEB-2006</b>
PROJECT MANAGER: <b>R. WHITCOMB</b>	DRAWN BY: <b>T. FILLBACH</b>
DESIGNED BY: <b>C. CARLSON</b>	IPARM NAME: <b>se034ab2.i</b>
BRIDGE SHEET NUMBER:	SHEET <b>54</b> OF <b>83</b>