

LEGEND	
	EXISTING
	NEW
R	REMOVE
N	NEW

DURABLE LETTERS (THERMOPLASTIC)  
 (STOP) § STA 100+25-35  
 (AHEAD) STA 15+58-57  
 (STOP) STA 15+89-97

DURABLE 4" WHITE LINE (THERMOPLASTIC)  
 STA 14+75 LT TO § STA 100+25 LT  
 § STA 100+25 RT TO STA 18+50 LT  
 STA 14+75 RT TO STA 18+50 RT

DURABLE 24" STOP BAR (THERMOPLASTIC)  
 § STA 100+25

DURABLE 4" YELLOW LINE (THERMOPLASTIC) (DOUBLE)  
 STA 14+75 TO STA 15+18-15  
 § STA 15+57 TO STA 18+50 §  
 § STA 100+25 - 100+75

REMOVING SIGNS  
 STA 15+02 LT (1 EA)  
 STA 15+04 LT (1 EA)  
 STA 15+04 LT (1 EA)  
 STA 15+16 LT (2 EA)  
 STA 15+55 LT (1 EA)  
 STA 15+62 LT (1 EA)  
 STA 16+50 LT (2 EA)  
 STA 16+50 LT (2 EA)  
 STA 17+25 RT (1 EA)  
 STA 17+50 LT (1 EA)

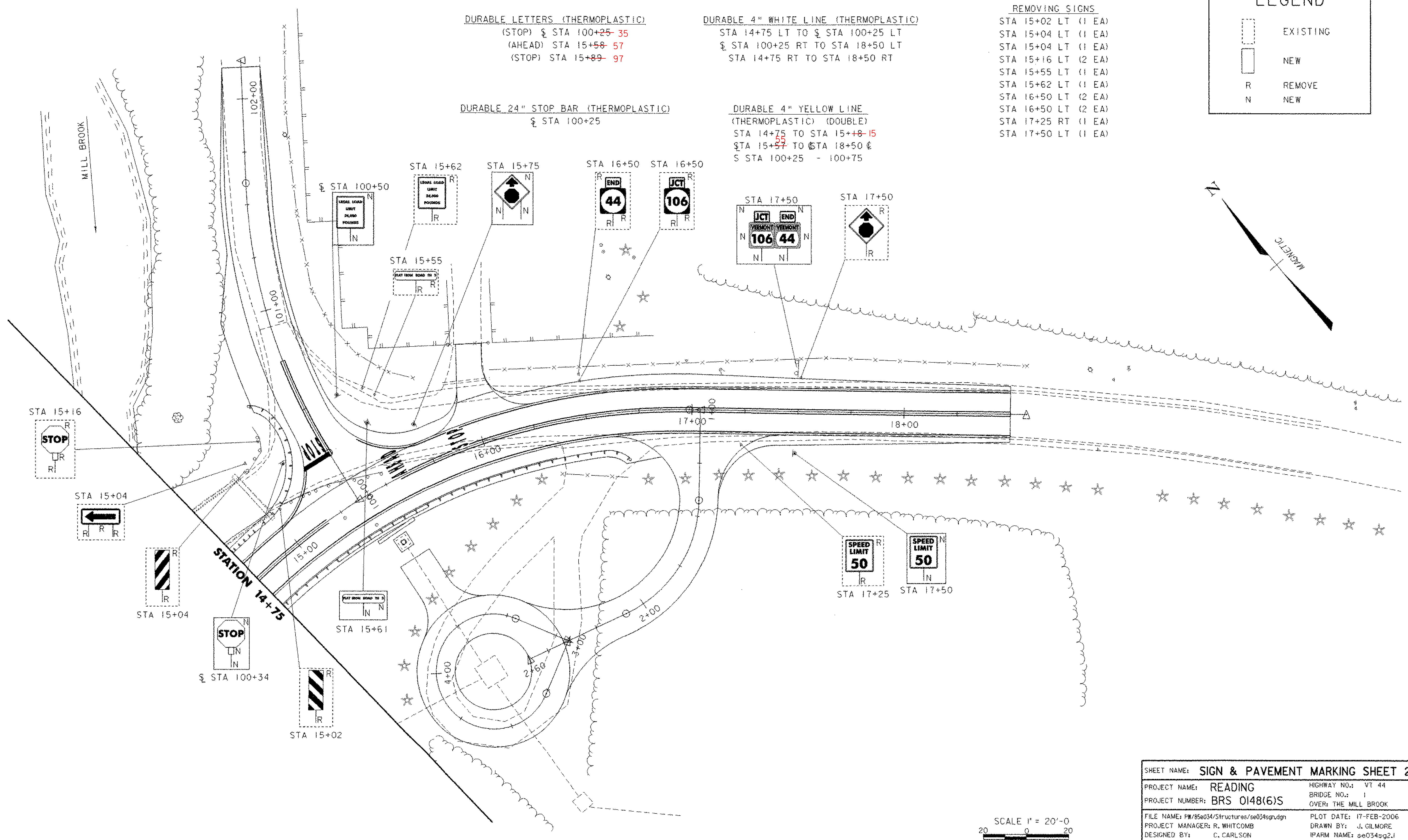

SHEET NAME: SIGN & PAVEMENT MARKING SHEET 2	
PROJECT NAME: READING	HIGHWAY NO.: VT 44
PROJECT NUMBER: BRS 0148(6)S	BRIDGE NO.: 1
	OVER: THE MILL BROOK
FILE NAME: PW/85e034/Structures/ee034sgndgn	PLOT DATE: 17-FEB-2006
PROJECT MANAGER: R. WHITCOMB	DRAWN BY: J. GILMORE
DESIGNED BY: C. CARLSON	IPARM NAME: ee034sg2.i
BRIDGE SHEET NUMBER:	SHEET 38 OF 83

SCALE 1" = 20'-0"  
 20 0 20