

LEGEND	
	EXISTING
	NEW
R	REMOVE
N	NEW

DURABLE 4" WHITE LINE (THERMOPLASTIC)
 STA 10+06 RT TO STA 14+75 RT
 STA 10+11⁰ LT TO STA 14+75 LT

DURABLE 4" YELLOW LINE (THERMOPLASTIC) (DOUBLE LINE)
 STA 10+50²⁷ TO STA 14+75

DURABLE LETTERS (THERMOPLASTIC)
 (STOP) STA 10+58³⁷

DURABLE 24" STOP BAR (THERMOPLASTIC)
 STA 10+50²⁸

REMOVING SIGNS

- STA 9+71 RT (3 EA)
- STA 9+72 LT (3 EA)
- STA 10+53 LT (1 EA)
- STA 10+49 RT (1 EA)
- STA 11+10 LT (2 EA)
- STA 12+64 LT (2 EA)
- STA 13+60 LT (2 EA)
- STA 13+84 LT (1 EA)
- STA 13+75 LT (1 EA)

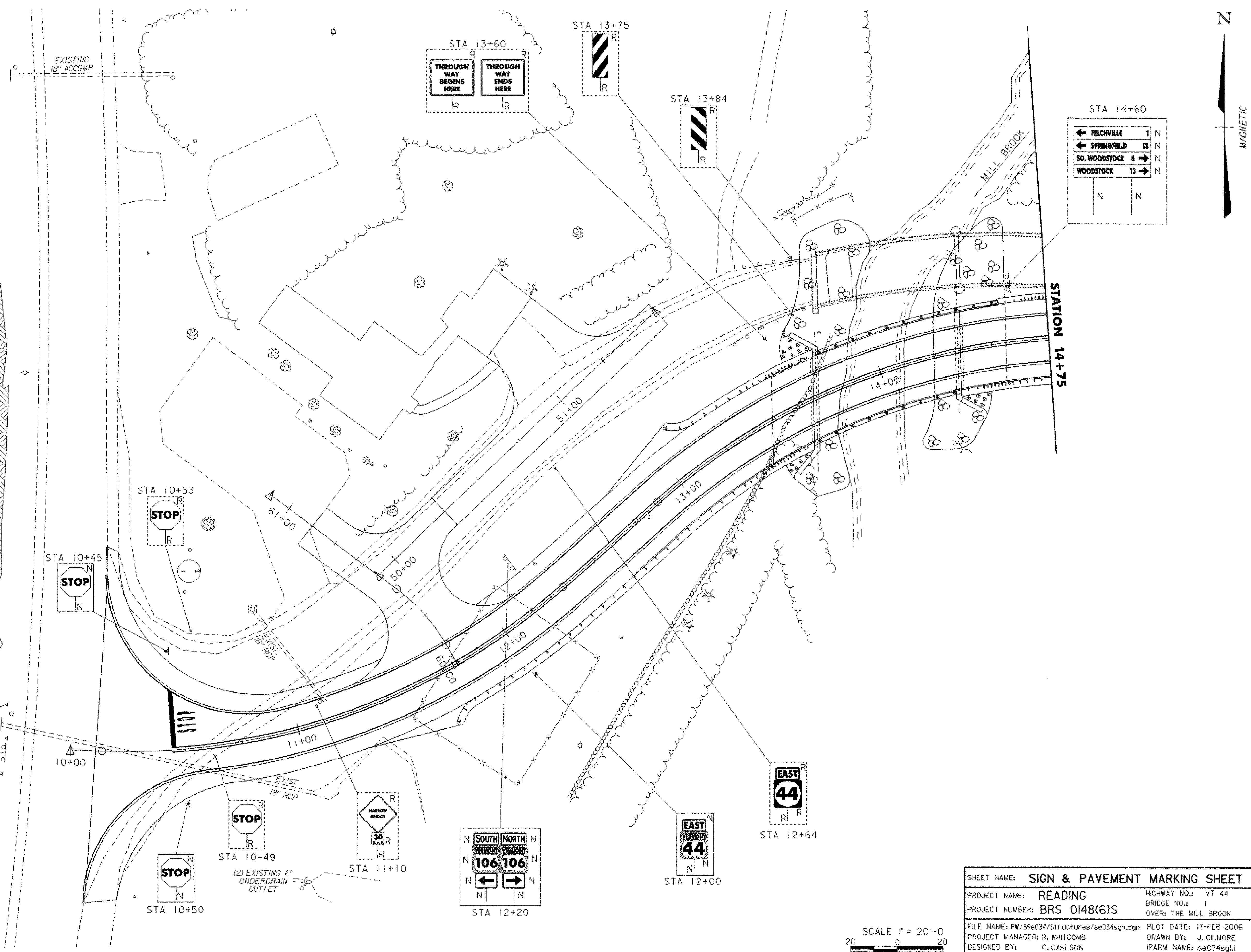
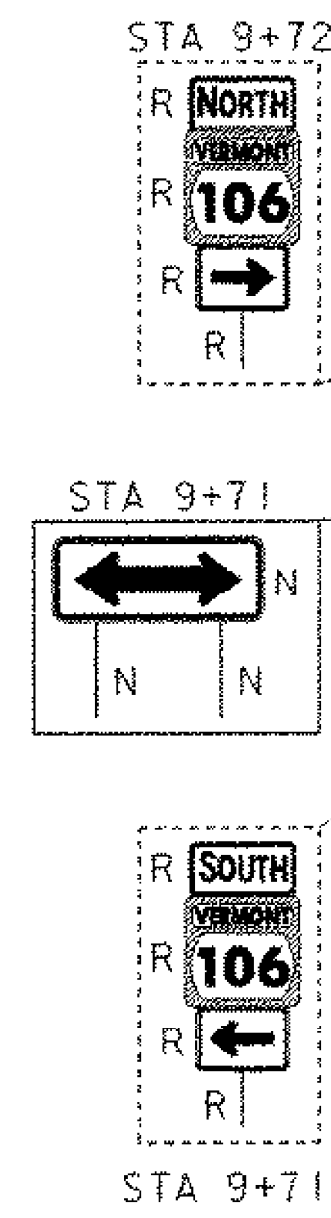

STA 14+60	
← FELCHVILLE	1 N
← SPRINGFIELD	13 N
← SO. WOODSTOCK	8 N
← WOODSTOCK	13 N
	N
	N

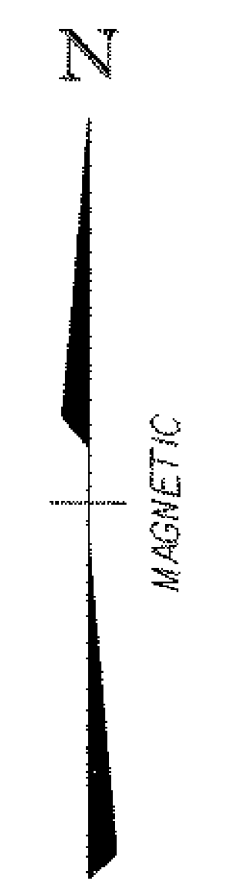

SHEET NAME: SIGN & PAVEMENT MARKING SHEET I	
PROJECT NAME: READING	HIGHWAY NO.: VT 44
PROJECT NUMBER: BRS 0148(6)S	BRIDGE NO.: 1
	OVER: THE MILL BROOK
FILE NAME: PW/85e034/Structures/se034sgn.dgn	PLOT DATE: 17-FEB-2006
PROJECT MANAGER: R. WHITCOMB	DRAWN BY: J. GILMORE
DESIGNED BY: C. CARLSON	IPARM NAME: se034sgl1
BRIDGE SHEET NUMBER:	SHEET 37 OF 83

