

STATION #	MARK	QTY	"A"	"C"	PANELS	"D"	"E"	"F"	"G"	"H"	"J"	"K"	"L"	"M"	"N"	"P"
112+12.6 RT	7T1	1	39'-2 3/4"	3'-6"	12 @ 3'-0" (±) = 36'-0 1/4"	3'-3"	1'-2 3/16"	2 @ 5 = 0'-10"	2'-8 1/2"	2 @ 5 = 0'-10"	18'-9 1/2"	2'-5 1/2"	3 3/16"	3/8"	2 3/16"	3 3/16"
11+49.5 LT	7T2	1	39'-11 3/4"	3'-6"	12 @ 3'-0 3/4" (±) = 36'-9 1/4"	3'-3"	1'-2 3/16"	2 @ 5 = 0'-10"	2'-8 1/2"	2 @ 5 = 0'-10"	19'-1 1/8"	2'-5 1/2"	3 3/16"	3/8"	2 3/16"	3 3/16"

MARK	"R"	"S"	"T"	"V"	(1)	(2)	(3)	(4)	(5)	(6)	(7)	(8)	(9)	(11)
7T1	2'-11 1/2"	14'-5 3/16"	26'-5 1/16"	35'-5 3/4"	a	b	d	f	h	k	m	n	p	z1
7T2	2'-11 1/2"	17'-9 3/8"	26'-11 1/16"	36'-2"	aa	b	ad	f	ah	k	m	n	p	z1

WEB MEMBER (OD)	HOLE DIA ± 1/4"
< 3.500	3/4"
3.500	1 1/4"
4.000	2"
4.500	2 1/4"
5.563	2 3/4"
6.625	3 1/4"

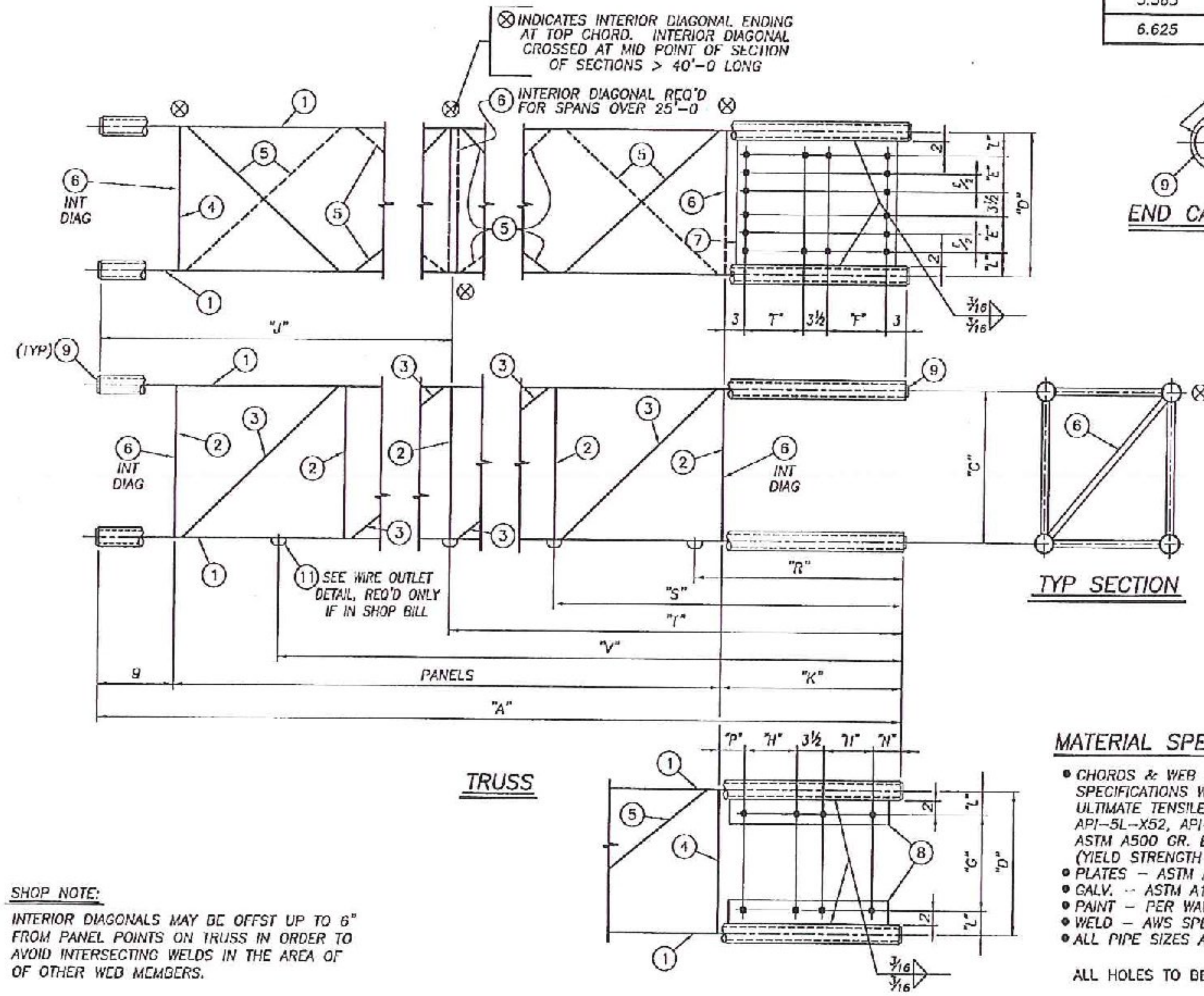

SHOP NOTE:
 INTERIOR DIAGONALS MAY BE OFFST UP TO 6" FROM PANEL POINTS ON TRUSS IN ORDER TO AVOID INTERSECTING WELDS IN THE AREA OF OTHER WEB MEMBERS.

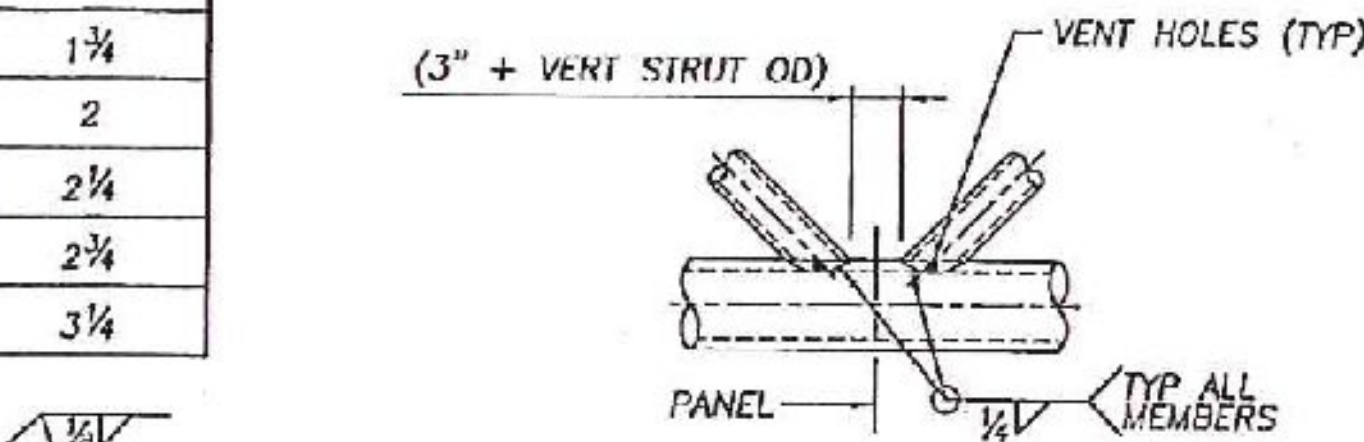

JOINT DETAIL

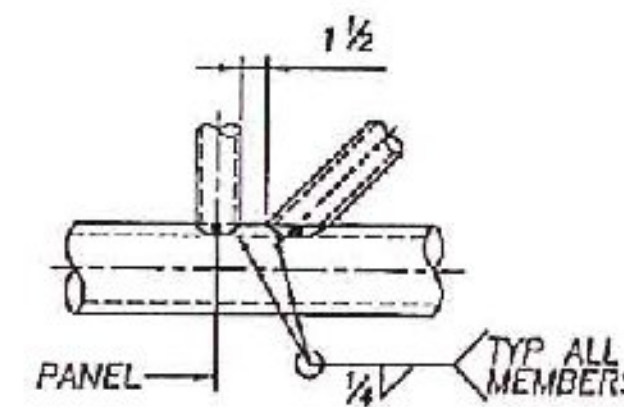

JOINT DETAIL

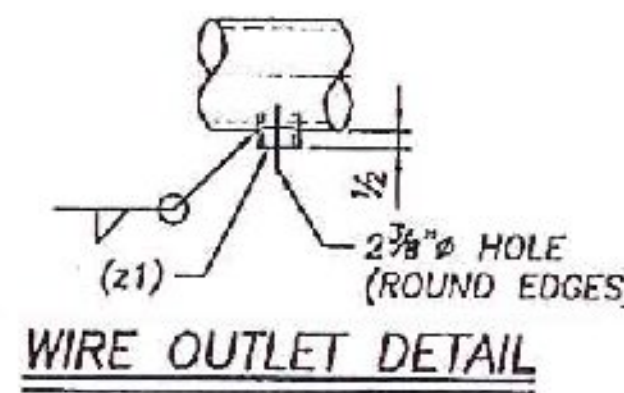

WIRE OUTLET DETAIL

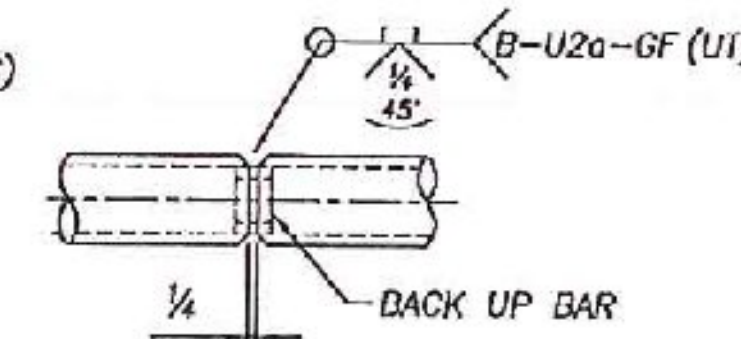

OPTIONAL CHORD SPLICE
 (FOR WALL THK 3/8" OR GREATER ONLY)

MATERIAL SPEC'S

- CHORDS & WEB MEMBERS - STEEL PIPE SHALL MEET THE FOLLOWING SPECIFICATIONS WITH THE PROPERTIES (52 KSI MIN. YIELD, 60 KSI MIN. ULTIMATE TENSILE AND MIN. ELONGATION EQUAL TO 20% IN 2 IN.). API-5L-X52, API-5L-X42, API-5L-X60, ASTM A252 GR. 3, ASTM A500 GR. B/C, OR ASTM A53 GR. B, (YIELD STRENGTH SHALL NOT EXCEED 82 KSI).
- PLATES - ASTM A572, GR. 50
- GALV. - ASTM A123
- PAINT - PER WALPAR COATING SYSTEM #3 - COLOR BLACK
- WELD - AWS SPEC. D1.1 - LATEST REV.
- ALL PIPE SIZES ARE OUTSIDE DIAMETER

ALL HOLES TO BE 1 3/16" UNLESS NOTED

C1181-7									
PARTS FOR CONC	PART MARK NO	NO OF PARTS REQ'D	DESIGN SIZE	DESCRIPTION OF MATERIAL	FEET	POUNDS	FAIR PLAY UNIT	FAIR PLAY UNIT	FAIR PLAY UNIT
	7T1	1		TRUSS					
	a	4	PIPE	2.875 x .203	39	2 3/4			
	b	26	PIPE	1.315 x .133	3	3 3/8			
	d	24	PIPE	1.315 x .133	4	2 1/8			
	f	3	PIPE	1.315 x .133	3	0 3/8			
	h	24	PIPE	1.315 x .133	4	0 1/8			
	k	3	PIPE	1.315 x .133	4	6 3/8			
	m	1	PL	1/2 x 26	3	0 1/2			
	n	2	PL	1/2 x 3 1/4	2	2			
	p	8	PL	1/4 x 3/8	0	2 3/8			
	z1	4	OP	1 1/4 EX HVY HALF COUPLING					
	7T2	1		TRUSS					
	aa	4	PIPE	2.875 x .203	39	11 1/4			
	b	26	PIPE	1.315 x .133	3	3 3/8			
	ad	24	PIPE	1.315 x .133	4	2 1/8			
	f	3	PIPE	1.315 x .133	3	0 3/8			
	ah	24	PIPE	1.315 x .133	4	0 1/8			
	k	3	PIPE	1.315 x .133	4	6 3/8			
	m	1	PL	1/2 x 26	3	0 1/2			
	n	2	PL	1/2 x 3 1/4	2	2			
	p	8	PL	1/4 x 3/8	0	2 3/8			
	z1	4	OP	1 1/4 EX HVY HALF COUPLING					



REF DWG: E3, & E5

AASHTO 5th Edition Spec's



POST OFFICE BOX 28650
 BIRMINGHAM ALABAMA 35228
 1900 JEFFERSON AVENUE
 BIRMINGHAM ALABAMA 35221
 PHONE (205) 925 4950
 FAX (205) 925 7273

STATE: Vermont
 PROJECT: Barre City
 PROJ No: FFGC F 026-1(34) C/2
 COUNTY: Washington
 ROUTE: US-302

SUBJECT: CANTILEVER SIGN SUPPORT
 DETAIL OF TRUSS
 FOR: F.R. Lafayette, Inc.

DRAWN BY: JLS DATE: 8/19/11
 CHECKED BY: RRW DATE: 8/22/11
 RELEASE FOR CONSTRUCTION: DWG NO: C1181-7

NO.	REVISIONS	DATE	MADE	CHECKED

FOR APPROVAL: 8/22/11 JLS RRW

BTCTDET