

ADVANCED SIGNING ALONG ROUTE 62
(MIRROR FOR LEFT LANE CLOSURES)

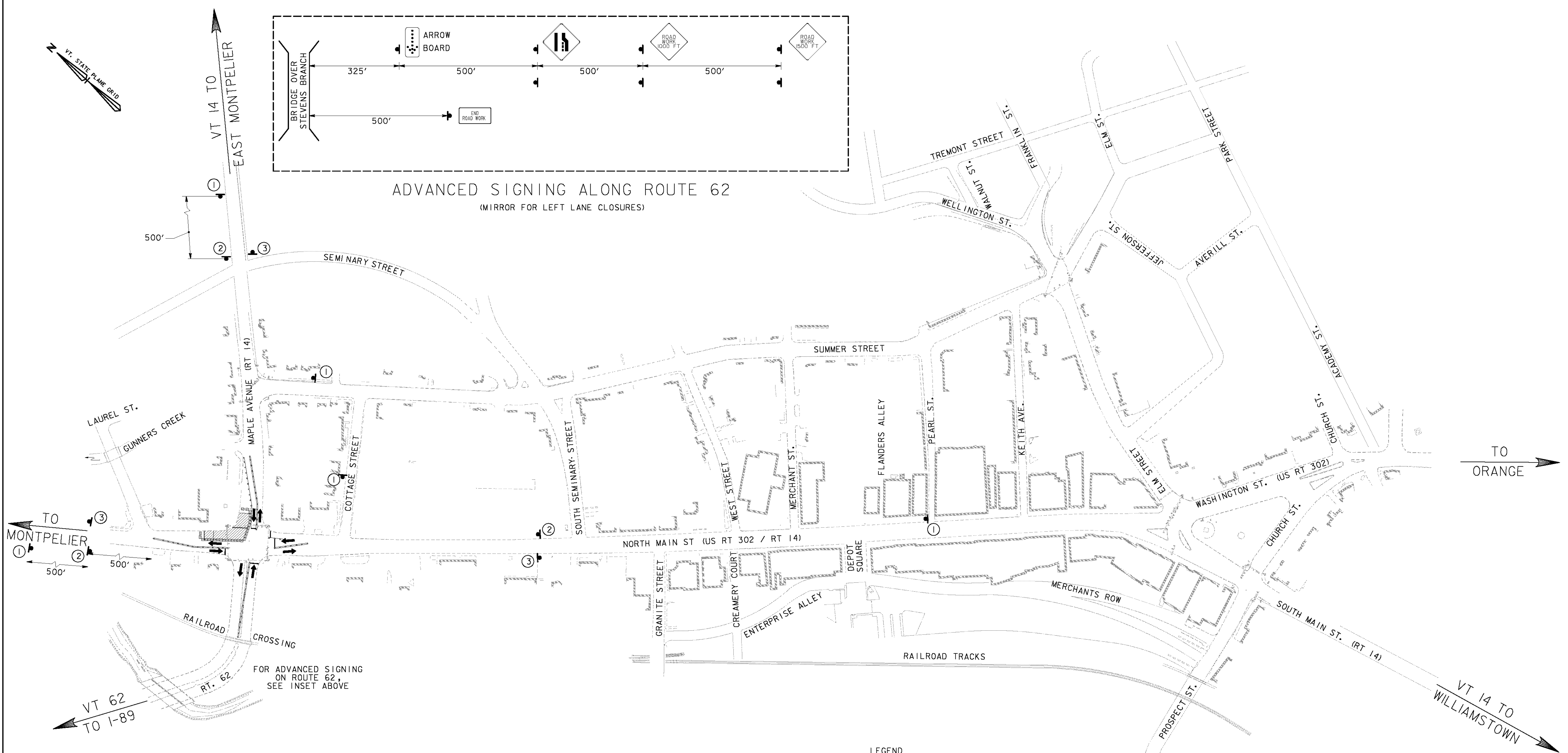

FOR ADVANCED SIGNING ON ROUTE 62, SEE INSET ABOVE

LEGEND

- PLASTIC DRUM AND YELLOW TEMPORARY PAVEMENT MARKINGS.
- PLASTIC DRUM AND WHITE TEMPORARY PAVEMENT MARKINGS.
- CONSTRUCTION AREA
- DESIGNATED DETOUR ROUTE
- CONSTRUCTION SIGN
- TYPE 1/2/3 BARRICADE
- BARRICADE WITH SIGNS
- LOCAL TRAFFIC ACCESS



| CONSTRUCTION SIGNS | | | | ARROW LEGEND | |
|--------------------|--|--|--|--------------|--|
| | | | | | |
| | | | | | |
| | | | | | |
| | | | | | |

PHASE IA

PROJECT NAME: BARRE CITY
 PROJECT NUMBER: FEGC F 026-1(34) C/2

FILE NAME: 856010_DTRI_C2
 PROJECT LEADER: G. BAKOS
 DESIGNED BY: DMP / MDS
 CONST. & DETOUR SIGNING PLAN PHASE IA

PLOT DATE: 3/31/2011
 DRAWN BY: DMP / JAR
 CHECKED BY:
 SHEET 173 OF 339