

DRAINAGE RUN 55 TO 60

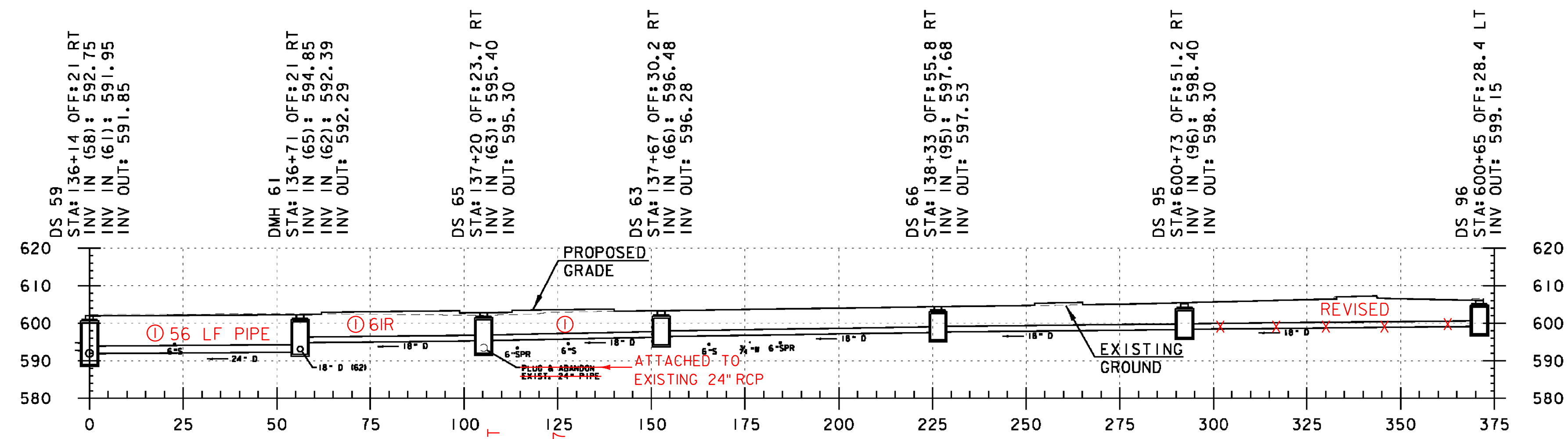

DRAINAGE RUN 96 TO 59

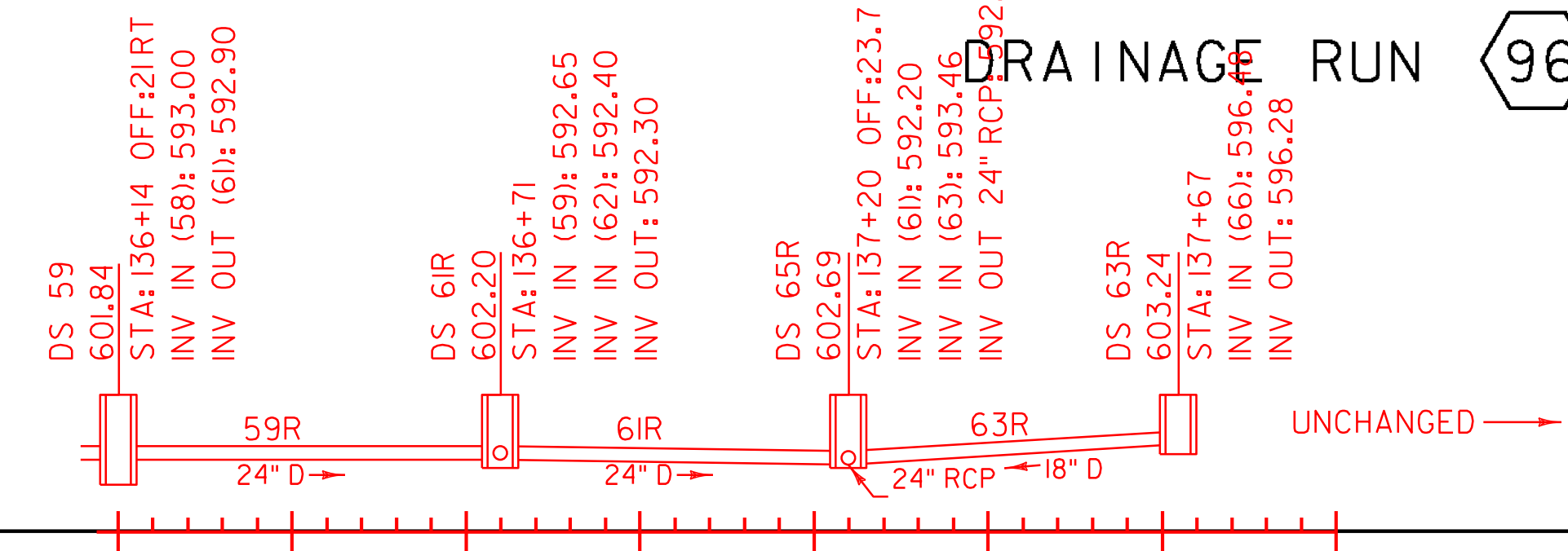

NOTE:
INFORMATION REGARDING ROOF DRAINS IS NOT DISPLAYED ON THESE SHEETS. SEE ROOF DRAIN PROFILES.

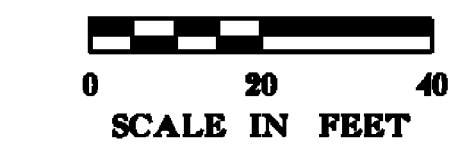

VHB Vanasse Hangen Brustlin, Inc.

ALLEY WAY OUTLET

PROJECT NAME:	BARRE CITY	PLOT DATE:	3/9/2011
PROJECT NUMBER:	FEGC F 026-(134) C/2	DRAWN BY:	DMP / JAR
FILE NAME:	85b010_PROJ.C2	CHECKED BY:	
PROJECT LEADER:	G. BAKOS	DRAINAGE PROFILES	
DESIGNED BY:	DMP / MDS		
			SHEET 78 OF 339

① DRAINAGE RUN REVISED TO UTILIZE EXISTING 24" RCP RATHER THAN INSTALL DRAINAGE RUN #59. DRAINAGE RUN #59 COULD NOT BE CONSTRUCTED DUE TO UNKNOWN OBSTACLES BENEATH THE PEDESTRIAN WALKWAY.