

■	PROPOSED GRANITE POST AND CHAIN FENCE	●	PROPOSED TRASH RECEPTACLE
*	PROPOSED ORNAMENTAL STREET LIGHT	○	PROPOSED PARKING METER POST
⬇	PROPOSED SIGNAL POLE WITH LUMINAIRE	⊗	PROPOSED TREE LOCATION
⊕	BORING/AUGER LOCATIONS	⊠	4' x 5' PROPOSED TREE PIT
		⊙	PROPOSED FIRE HYDRANT

- NOTES:**
1. SAWCUT OF EXISTING PAVEMENT & SIDEWALK SHALL BE INCIDENTAL TO ALL EXCAVATION PAY ITEMS.
  2. REMOVE ABANDONED GAS LINES TO LIMITS OF FULL DEPTH CONSTRUCTION (INCIDENTAL TO ALL EXCAVATION PAY ITEMS). PLUG EXISTING LINES AT LIMITS OF CONSTRUCTION.
  3. THE PROPOSED SEWER AND WATER UTILITIES SHOWN ON THESE GENERAL PLANS ARE FOR INFORMATIONAL PURPOSES. REFER TO THE SEWER AND WATER PLANS BY DUFRESNE GROUP FOR ACTUAL CONSTRUCTION INFORMATION.
  4. SEE THE ITEM DETAIL & DRAINAGE SHEETS, DRAINAGE PROFILES, AND CROSS SECTIONS FOR PROPOSED DRAINAGE INFORMATION CORRESPONDING TO NOTE NUMBERS SHOWN BY: #
  5. ALL EXISTING TELEPHONE & ELECTRIC MANHOLES SHALL BE ADJUSTED BY OTHERS.

**COLD PLANING, BITUMINOUS PAVEMENT**  
 STA 140+25 - 141+00  
 SL STA 603+75 - 604+25

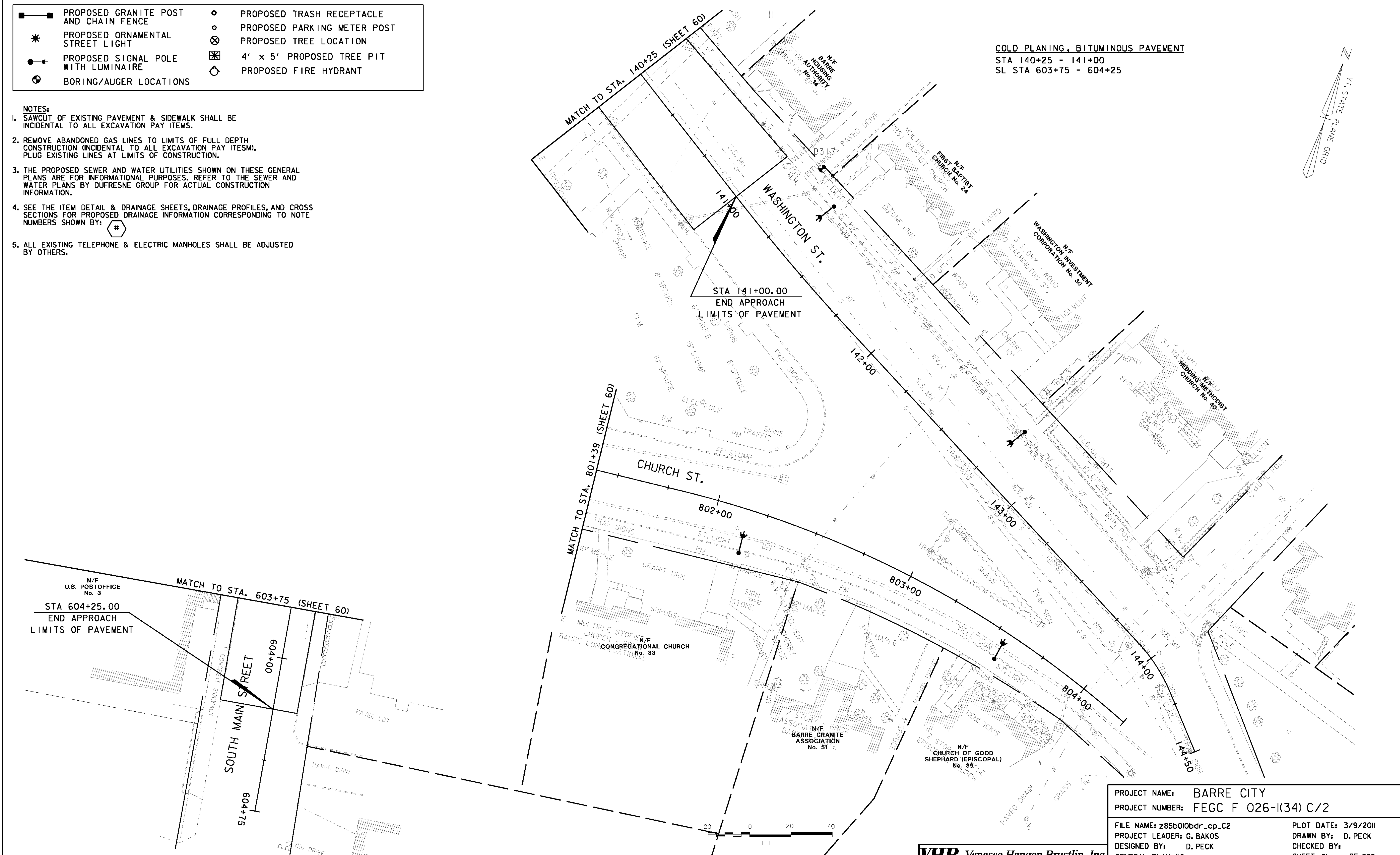
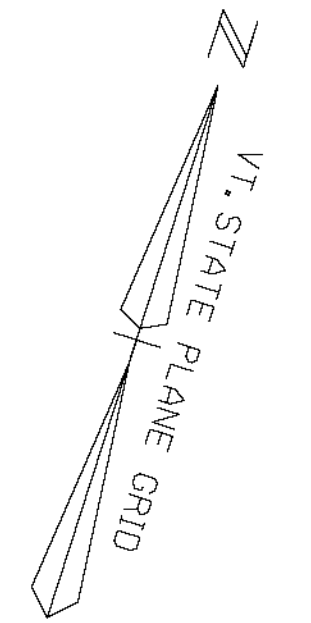

PROJECT NAME:	BARRE CITY	FILE NAME:	z85b010bdr_cp_C2	PLOT DATE:	3/9/2011
PROJECT NUMBER:	FEGC F 026-(K34) C/2	PROJECT LEADER:	G. BAKOS	DRAWN BY:	D. PECK
DESIGNED BY:	D. PECK	CHECKED BY:		GENERAL PLAN #6	SHEET 61 OF 339

**VHB** Vanasse Hangen Brustlin, Inc.