

CURVE DATA #S3  
 $\Delta = 2^{\circ}17'41.82''$  R  
 $D = 1^{\circ}54'35.49''$   
 $R = 3000.00'$   
 $T = 60.09'$   
 $L = 120.16'$   
 $E = 0.60'$   
 BANK = NC

CURVE DATA #S4  
 $\Delta = 24^{\circ}22'51.65''$  L  
 $D = 28^{\circ}38'52.40''$   
 $R = 200.00'$   
 $T = 43.21'$   
 $L = 85.11'$   
 $E = 4.61'$   
 BANK = NC

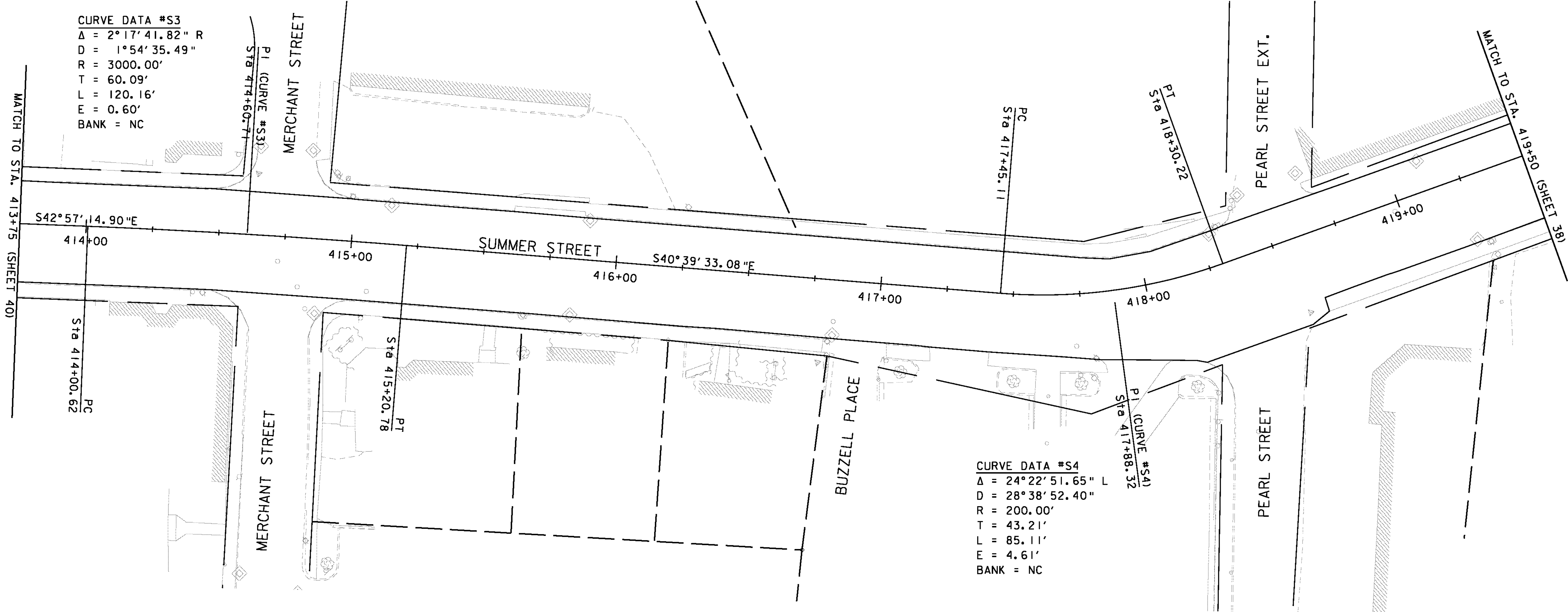

**VHB** Vanasse Hangen Brustlin, Inc.

|                                      |                     |
|--------------------------------------|---------------------|
| PROJECT NAME: BARRE CITY             | PLOT DATE: 3/9/2011 |
| PROJECT NUMBER: FECC F 026-I(34) C/2 | DRAWN BY: D. PECK   |
| FILE NAME: z85b010bdr_nu_C2          | CHECKED BY:         |
| PROJECT LEADER: G. BAKOS             | SHEET 41 OF 339     |
| DESIGNED BY: D. PECK                 |                     |
| ALIGNMENT AND CURB LAYOUT PLAN #12   |                     |