

127+09

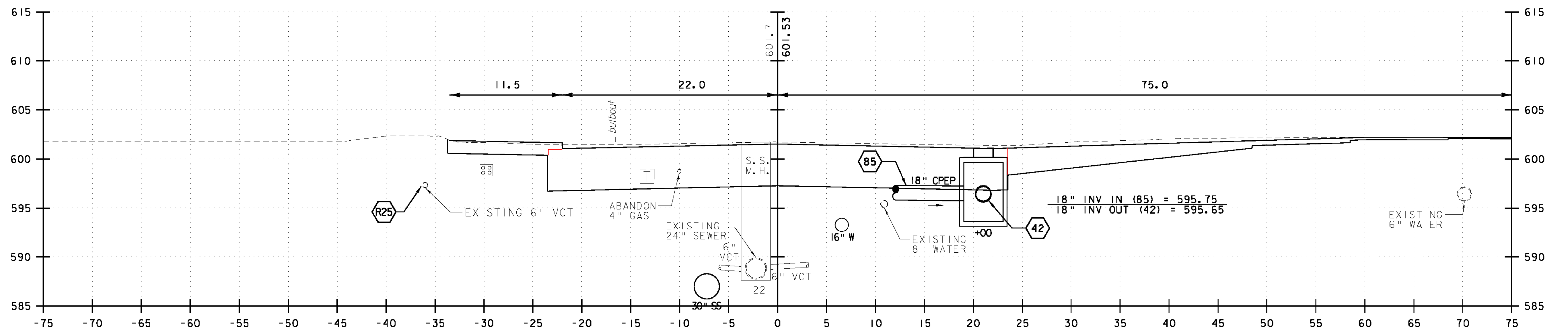

127+00

SAND BORROW ~ 1.50' X 47.0' = 70.5 SF
 SUBBASE ~ 2.00' X 47.0' = 94.0 SF

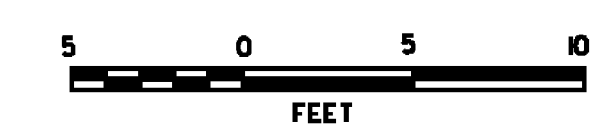

VHB Vanasse Hangen Brustlin, Inc.

NORTH MAIN STREET (US 302)	
PROJECT NAME:	BARRE CITY
PROJECT NUMBER:	FEGC F 026-(134) C/2
FILE NAME:	85b010_xsl.Cut_C2
PROJECT LEADER:	G. BAKOS
DESIGNED BY:	DMP / MDS
CROSS SECTIONS	
PLOT DATE:	3/9/2011
DRAWN BY:	DMP / JAR
CHECKED BY:	
SHEET	257 OF 339