

SPECIAL PROVISION (CU STRUCTURAL SOIL)

STA 115+47 - 115+87 RT
 STA 116+85 - 116+90 LT

LANDSCAPE BACKFILL, TRUCK MEASUREMENT

SL STA 10+70 - 11+00 LT-RT
 SL STA 11+52 - 11+68 LT-RT
 SL STA 20+48 - 20+94 LT-RT
 SL STA 116+77 - 116+90 LT

DECIDUOUS TREES

STA 115+67 RT
 SL STA 11+02 LT
 SL STA 11+20 LT
 SL STA 11+45 LT
 SL STA 11+64 LT

REMOVING MEDIUM TREES

STA 116+29 LT
 SL STA 11+25 RT
 SL STA 30+62 RT

SPECIAL PROVISION (GRANITE POST AND CHAIN FENCE)

SL STA 20+50 - 20+78 RT
 STA 114+51 - 114+89 LT
 STA 116+77 - 116+90 LT

SPECIAL PROVISION (STEEL BENCH WITH BACK)

STA 116+86 LT

EVERGREEN SHRUBS

STA 116+79 - 116+88 LT

SPECIAL PROVISION (BICYCLE RACK)

STA 116+85 LT

TREE PROTECTION ZONE/TPZ

STA 112+60 - 112+77 RT
 STA 115+35 - 115+45 LT
 STA 115+74 - 115+93 LT
 STA 115+91 - 116+04 RT
 STA 116+48 - 116+90 RT
 SL STA 10+90 - 11+15 RT

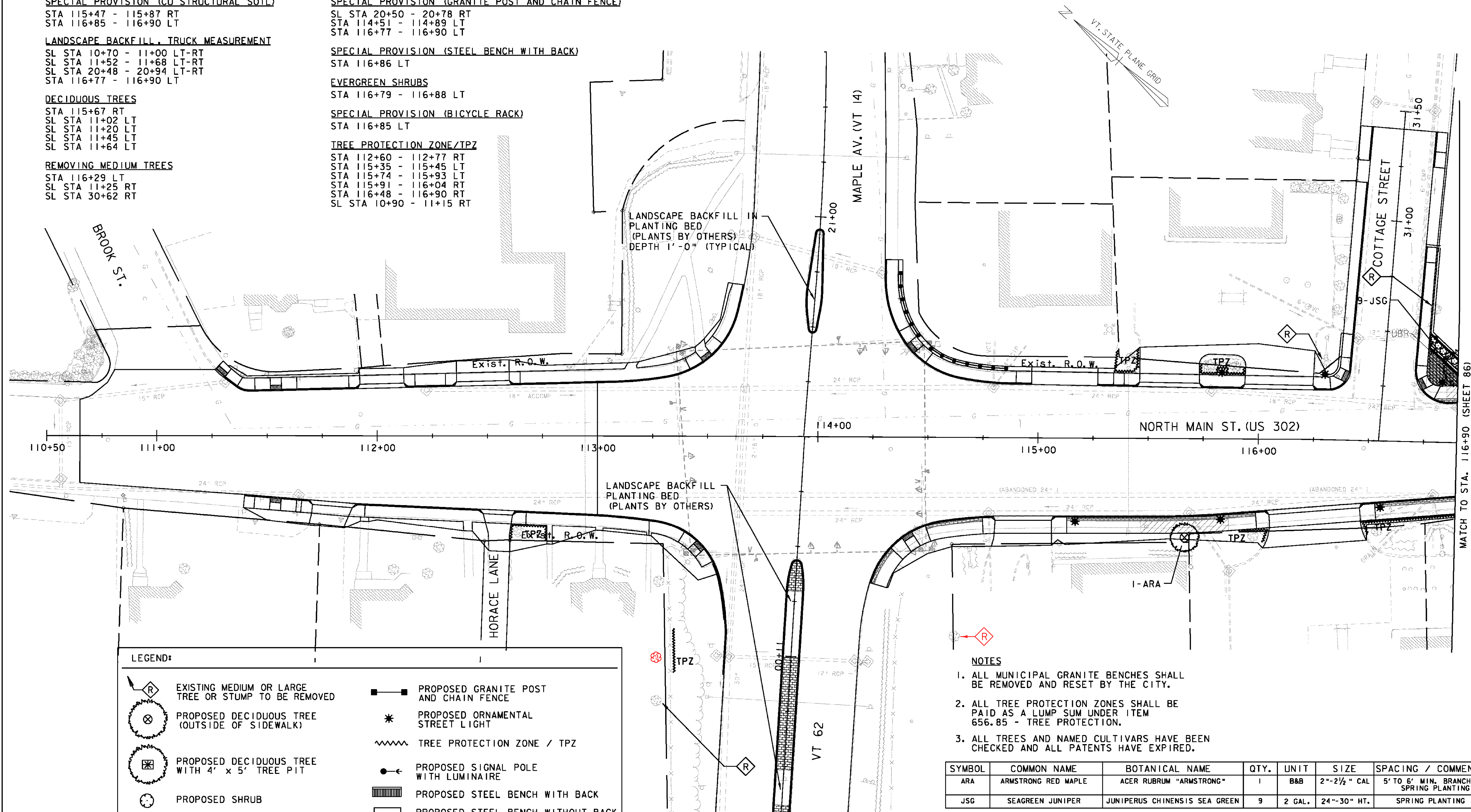

LEGEND:

	EXISTING MEDIUM OR LARGE TREE OR STUMP TO BE REMOVED		PROPOSED GRANITE POST AND CHAIN FENCE
	PROPOSED DECIDUOUS TREE (OUTSIDE OF SIDEWALK)		PROPOSED ORNAMENTAL STREET LIGHT
	PROPOSED DECIDUOUS TREE WITH 4' x 5' TREE PIT		TREE PROTECTION ZONE / TPZ
	PROPOSED SHRUB		PROPOSED SIGNAL POLE WITH LUMINAIRE
	COBBLESTONE PAVERS		PROPOSED STEEL BENCH WITH BACK
	IMPRINTED 5" CONCRETE SIDEWALK		PROPOSED STEEL BENCH WITHOUT BACK
	CU STRUCTURAL SOIL		PROPOSED PARKING METER POST
			PROPOSED TRASH RECEPTACLE
			PROPOSED BICYCLE RACK

- NOTES**
1. ALL MUNICIPAL GRANITE BENCHES SHALL BE REMOVED AND RESET BY THE CITY.
 2. ALL TREE PROTECTION ZONES SHALL BE PAID AS A LUMP SUM UNDER ITEM 656.85 - TREE PROTECTION.
 3. ALL TREES AND NAMED CULTIVARS HAVE BEEN CHECKED AND ALL PATENTS HAVE EXPIRED.

SYMBOL	COMMON NAME	BOTANICAL NAME	QTY.	UNIT	SIZE	SPACING / COMMENTS
ARA	ARMSTRONG RED MAPLE	ACER RUBRUM "ARMSTRONG"	1	B&B	2"-2 1/2" CAL	5' TO 6' MIN. BRANCH HT. SPRING PLANTING
JSG	SEAGREEN JUNIPER	JUNIPERUS CHINENSIS SEA GREEN	9	2 GAL.	24"-30" HT.	SPRING PLANTING

PROJECT NAME: BARRE CITY
 PROJECT NUMBER: FECC F 026-(K34) C/2
 FILE NAME: z85b010bdr_id.C2
 PROJECT LEADER: G. BAKOS
 DESIGNED BY: D. PECK
 LANDSCAPING PLAN #1

PLOT DATE: 3/9/2011
 DRAWN BY: D. PECK
 CHECKED BY:
 SHEET 85 OF 339

VHB Vanasse Hangen Brustlin, Inc.



MATCH TO STA. 116+90 (SHEET 86)

MATCH TO STA. 11+75 (SHEET 90)