

PROJECT DESCRIPTION AND LOCATION

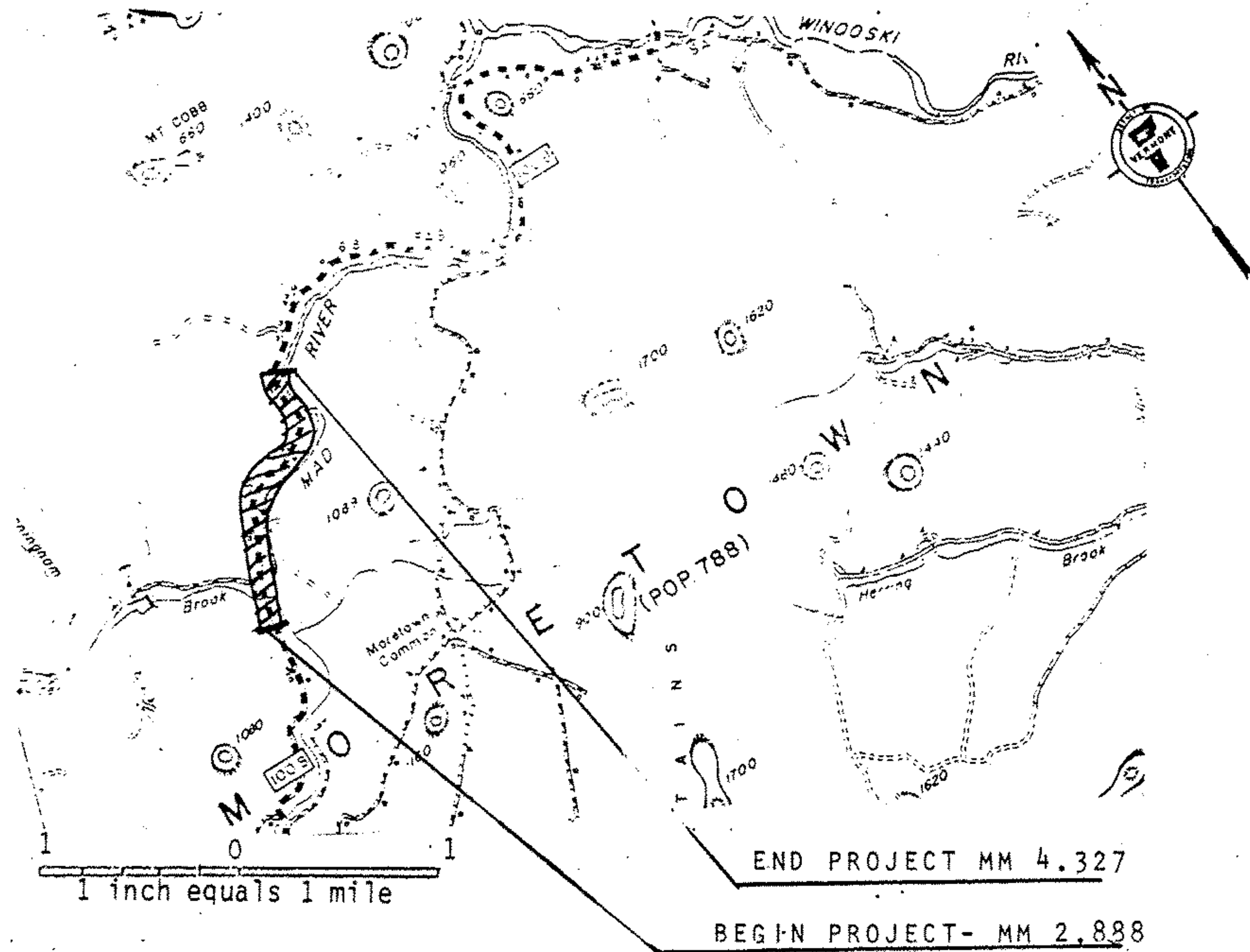

ON VT 100B: BEGINNING 2.888 MILES NORTHERLY OF THE WAITSFIELD-MORETOWN TOWN LINE AT MM 2.888 AND EXTENDING NORTHERLY 1.439 MILES TO MM 4.327

LENGTH OF PROJECT
1.439 Miles
7601 feet

PROJECT MORETOWN

NO. HMA 2522

SHEET 2 OF 10 SHEETS