

REINFORCED ELASTOMERIC BEARING FABRICATION SHEET 1103- Page #: 1

Project #: 31939-1103-1 (16 OF 16) Customer: COLD RIVER BRIDGES (PO #001051)

County: WINDSOR State: VT Structure: BRIDGE # 8

Pad I.D./Loc.: ABUTMENTS Quantity (Including Full Size Sample(s) - If Req'd): 16

Certifications Are Required: YES, see below YES - (If not full size, create another sheet)
 Testing Req'd: NO, random in-house only Sample Req'd: NO

State D.O.T. Spec. Number (If Specified): VT DOT SEC 531 & 731 Project # (req'd for cert.s): BRF 025-1(28)

Special Notes: _____

Shim Steel Spec. (Circle One): A709 GR.36(250) A1011 GR.36(250)-Type 1 Other: _____

Durometer Requirement (Circle One): ~~50±5~~ ~~60±5~~ Other: — Shear Modulus Requirement: 100 psl ±16%

Neoprene Grade (Circle One): 3 4 Other Grade or Natural Rubber: NATURAL RUBBER

Structures
Copy

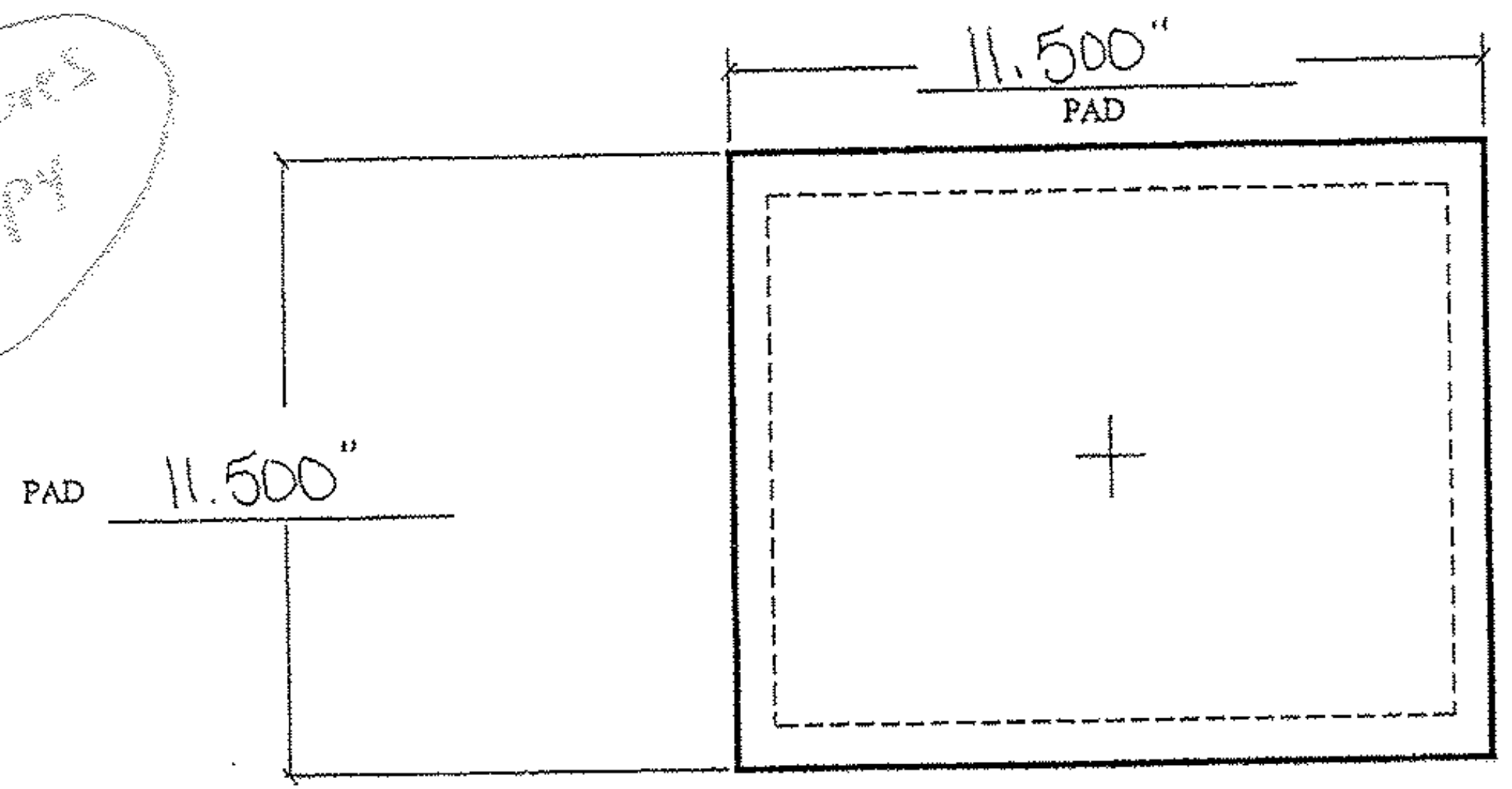

(A) PLAN
NOT TO SCALE

DESIGN LOADS (SERVICE)
 max-91.7 KIPS
 RECEIVED
 CRD: JSS SKDE: RSY
 DEC 27 2010
 RESUBMIT _____ APPROVED
 BY: OPW DATE: 12/30/10

of Reinforcing Plates: 5
 Plate Thickness: 1/8"
4 # of Inner Rubber Layers
 @ 0.503" = 2.012"

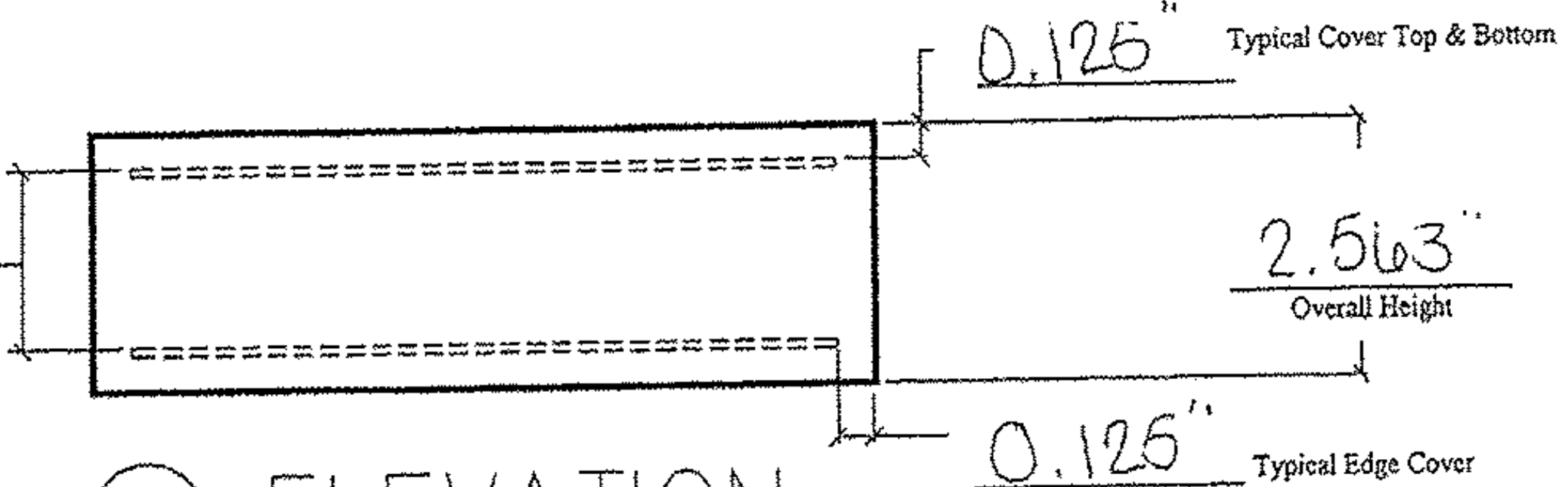

(B) ELEVATION
NOT TO SCALE

Name: Margaret Miss Date: 12-22-10

This shop drawing was prepared in accordance with the contract plans and specifications. The D.S. Brown Company does not accept liability for the design of the products detailed in the shop drawings.