

ENDS OF BEAMS SHALL BE FABRICATED TO BE VERTICAL IN ERECTED POSITION AFTER ALL DEAD LOADS HAVE BEEN PLACED.

1/2" x 7 1/2" BEARING STIFFENER

SINGLE NUT W/ 5"x5"x1/2" PLATE WASHER. NUT MAY BE TIGHTENED TO FACILITATE STEEL GIRDER ERECTION, BUT PRIOR TO CONCRETE PLACEMENT NUT SHALL BE BACKED OFF 1/8"

1/2" SOLE PLATE\*  
1/2" PLATE WASHER

DOUBLE NUT W/ 5"x5"x1/2" PLATE WASHER. ELEVATION OF TOP OF SOLE PLATE SHALL BE SET TO THEORETICAL BRIDGE SEAT ELEVATIONS.

36" X 2 1/2" Ø GR 50 OR HIGHER STRENGTH SWEDGED ANCHOR BOLT THREADED 18", WITH 18" MIN EMBEDMENT, DOUBLE NUT

**ELEVATION VIEW  
END OF STEEL  
MEMBER AT ABUTMENT**

SCALE 1 1/2" = 1'-0"

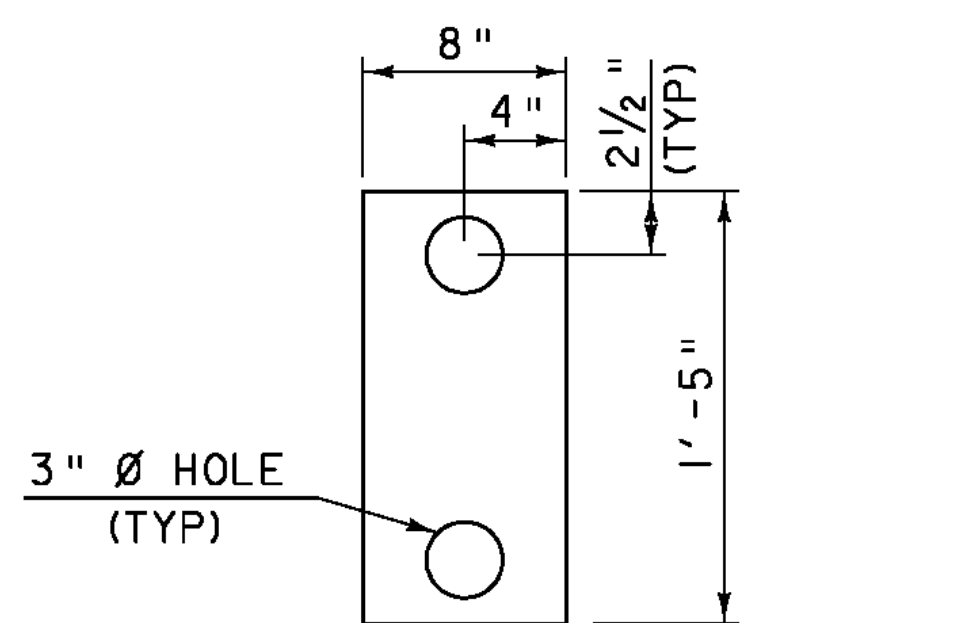

**1/2" SOLE PLATE DETAIL**

SCALE 1 1/2" = 1'-0"

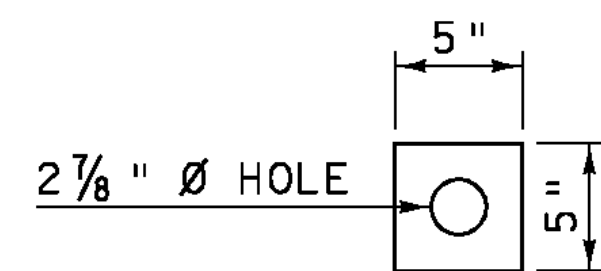

**1/2" PLATE WASHER DETAIL**

SCALE 1 1/2" = 1'-0"

**NOTES:**

1. THE SOLE PLATES, ANCHOR BOLTS, WASHERS AND NUTS SHALL BE PAID FOR UNDER ITEM 531.14, "BEARING DEVICE ASSEMBLY, INTEGRAL ABUTMENT" AND SHALL CONFORM TO SECTION 531.
2. ANCHOR BOLTS SHALL BE 2 1/2" DIAMETER, TYPE I BOLTS MEETING ASTM A449. NUTS SHALL MEET AASHTO M291. THE CONTRACTOR SHALL ENSURE THAT THE ANCHOR BOLTS ARE INSTALLED IN A PLUMB POSITION. ONE EXTRA ANCHOR BOLT SHALL BE SUPPLIED FOR TESTING PURPOSES.
3. ALL STEEL IN BEARING DEVICE ASSEMBLY SHALL BE AASHTO M270M/M270 GR 36 UNLESS OTHERWISE NOTED.
4. SUBSTITUTIONS FOR BEARING DEVICE ASSEMBLY COMPONENT MATERIALS AND SIZES SHALL BE DETAILED ON THE FABRICATION DRAWINGS. ALL SUBSTITUTIONS SHALL BE APPROVED BY THE PROJECT MANAGER PRIOR TO FABRICATION AS PER SUBSECTION 506.04.

THEORETICAL TOP OF SOLE PLATE ELEVATIONS		
ABUTMENT #1	ABUTMENT #2	
581.50	580.17	GIRDER 1
581.61	580.39	GIRDER 2
581.72	580.59	GIRDER 3
581.83	580.80	GIRDER 4
581.86	580.92	GIRDER 5
581.97	581.11	GIRDER 6
582.07	581.30	GIRDER 7

\*GREASE TOP OF SOLE PLATE BEFORE GIRDER PLACEMENT

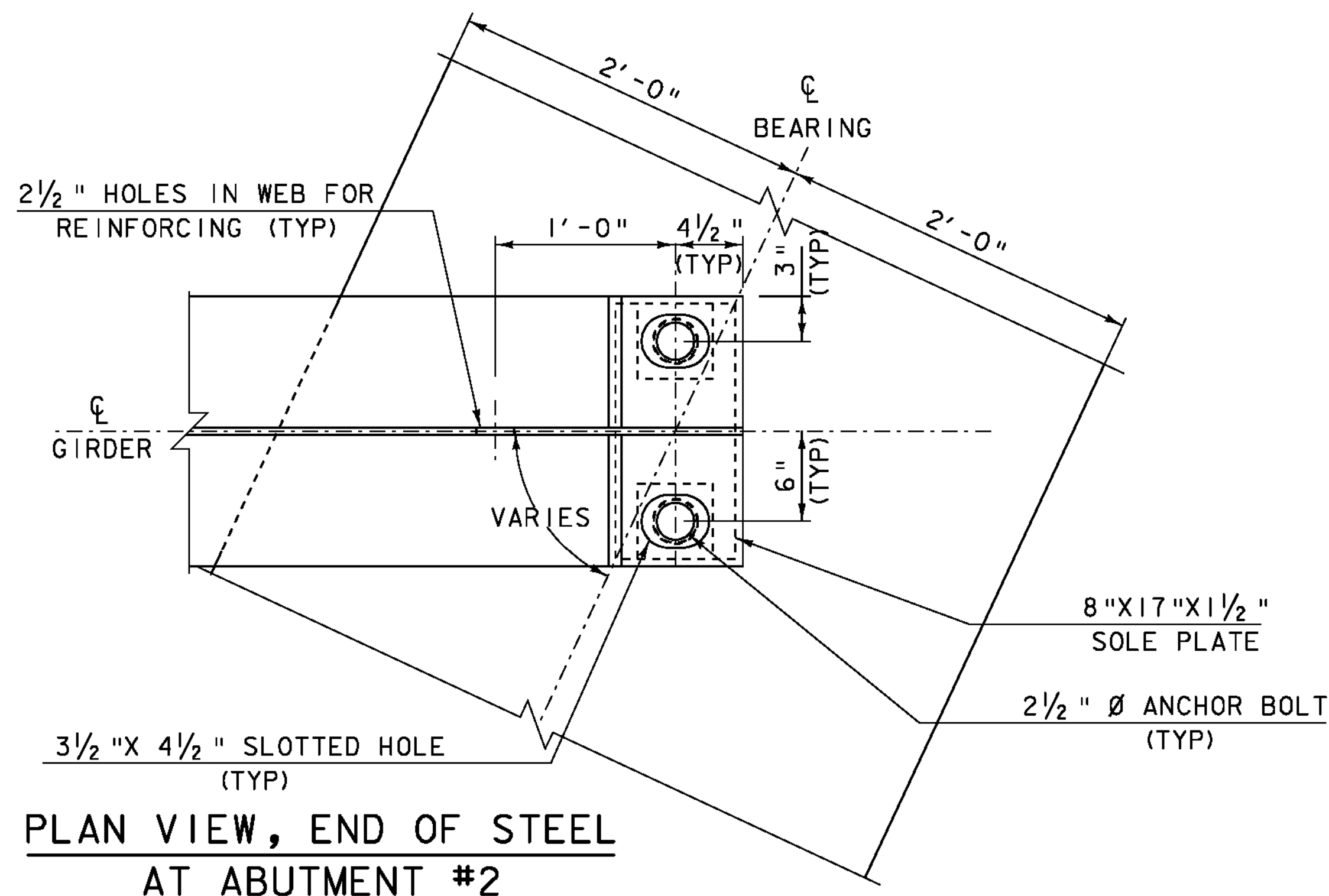

**PLAN VIEW, END OF STEEL  
AT ABUTMENT #2**

REVERSE GIRDER FOR ABUTMENT #1  
SCALE 1 1/2" = 1'-0"

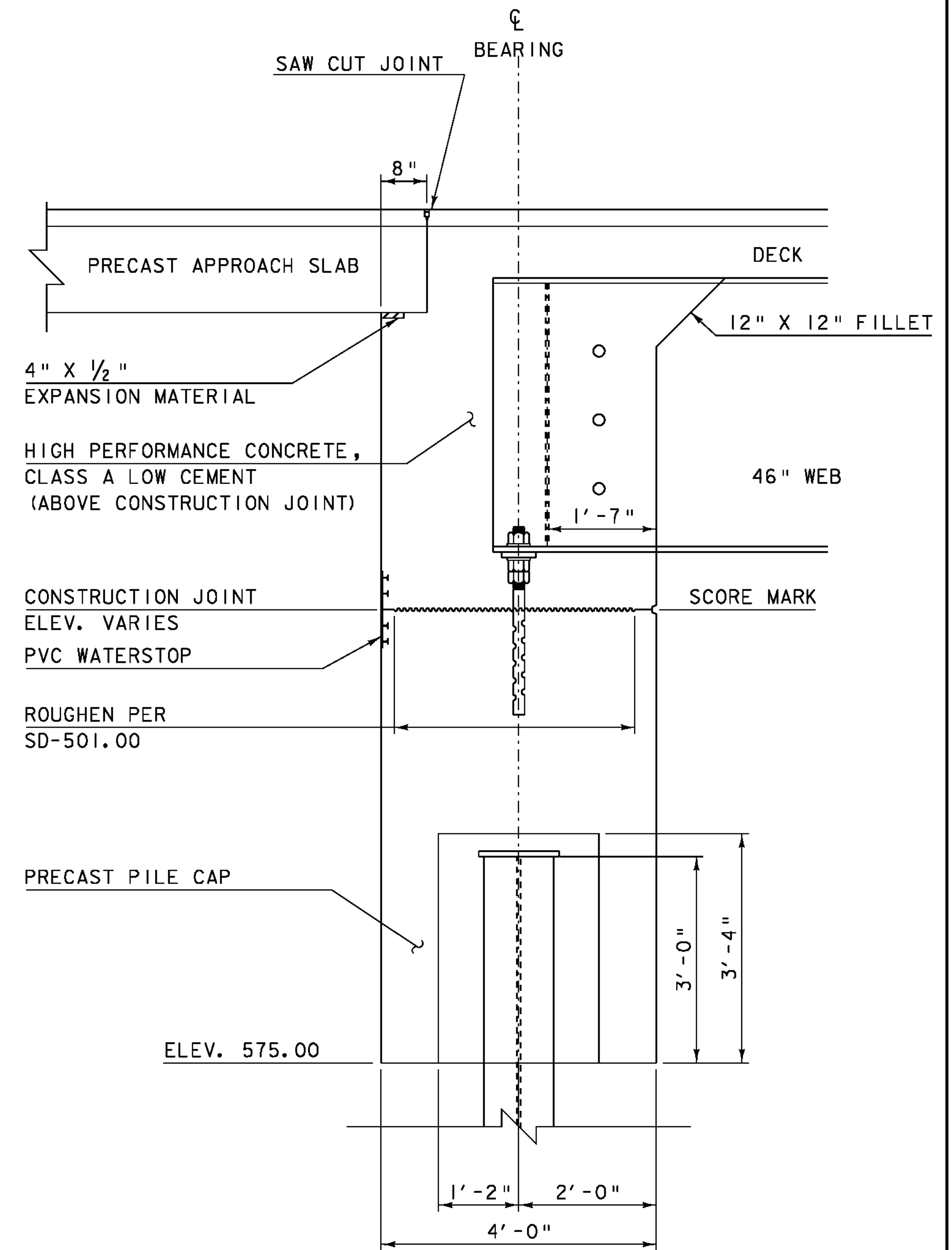

**BRIDGE END DETAIL AND  
ABUTMENT TYPICAL SECTION**

SCALE 3/4" = 1'-0"

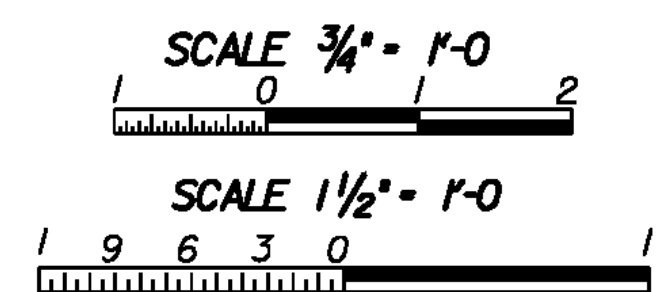

PROJECT NAME: CHESTER  
PROJECT NUMBER: BRF 025-1(37)

FILE NAME: 95b168\95b168sub.dgn PLOT DATE: 21-SEP-2010  
PROJECT LEADER: C.P.WILLIAMS DRAWN BY: D.D.BEARD  
DESIGNED BY: R.S.YOUNG CHECKED BY: R.S.YOUNG  
BRIDGE 9 BEARING DETAILS SHEET 84 OF 124