

STATE OF VERMONT AGENCY OF TRANSPORTATION

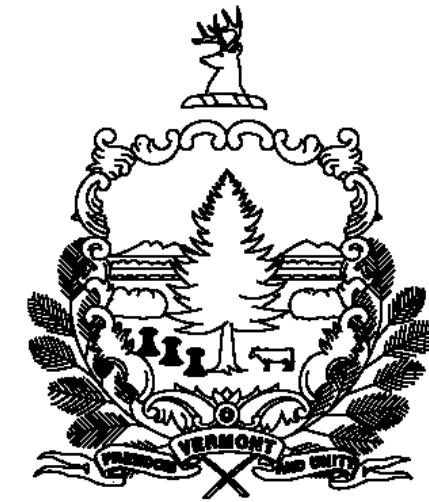

PROPOSED IMPROVEMENT BRIDGE PROJECT

TOWN OF CHESTER

COUNTY OF WINDSOR

ROUTE NO : VT 103 RURAL PRINCIPAL ARTERIAL NATIONAL HIGHWAY SYSTEM BRIDGE NO : 8

PROJECT LOCATION : 0.27 MILES SOUTHEAST OF JUNCTION WITH VT ROUTE II (PLEASANT STREET)

PROJECT DESCRIPTION : THE PROJECT SHALL CONSIST OF THE REPLACEMENT OF THE EXISTING
STRUCTURE WITH A NEW STRUCTURE INCLUDING RELATED ROADWAY AND CHANNEL WORK.

LENGTH OF STRUCTURE : 61.25 FEET.
LENGTH OF ROADWAY : 88.75 FEET.
LENGTH OF PROJECT : 150.00 FEET.

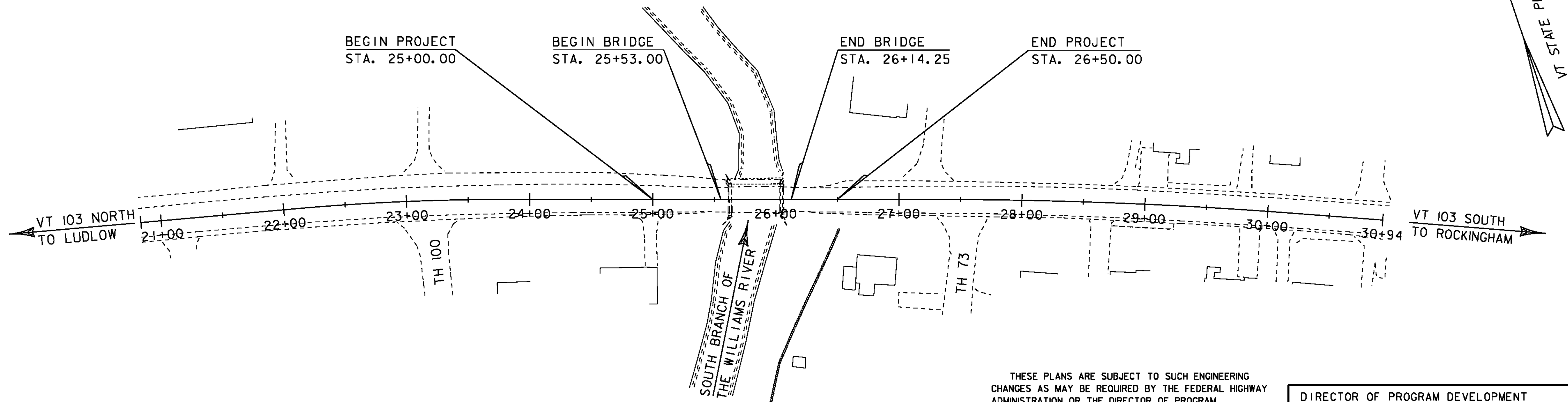
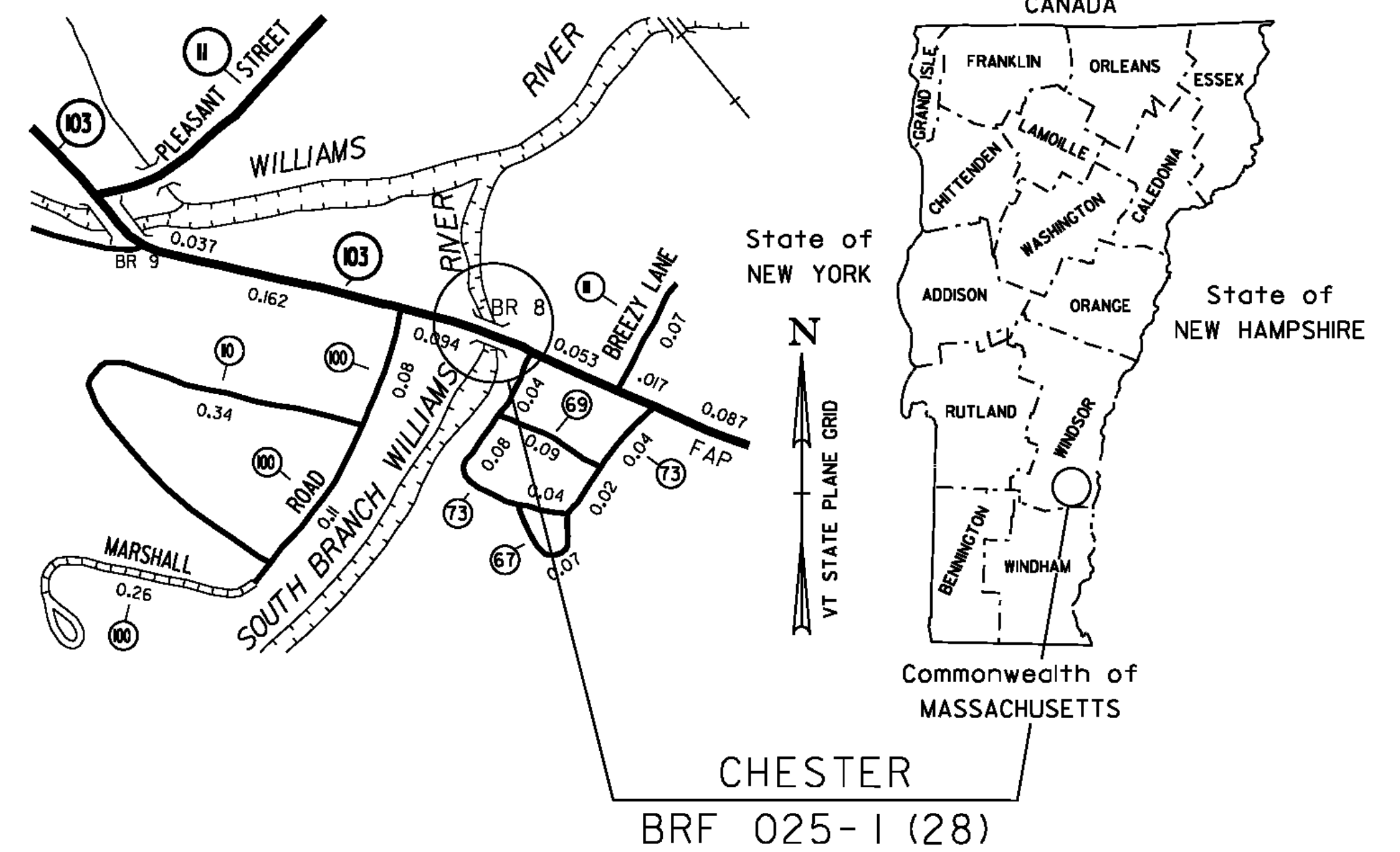

QUALITY ASSURANCE PROGRAM: LEVEL 1

CONVENTIONAL SYMBOLS

COUNTY LINE	
TOWN LINE	
LIMITS OF ACCESS	
POINT OF ACCESS	
FENCE LINE	
STONE WALL	
TRAVELED WAY	
GUARD RAIL	
RAILROAD	
SURVEY LINE	
CULVERT	
POWER POLE	
TELEPHONE POLE	
TREES	
CONTROL OF ACCESS	
PROPERTY LINE	
R.O.W. TAKING LINE	
SLOPE RIGHTS	
TOP OF CUT	
TOE OF SLOPE	

SURVEYED BY : GILMAN
SURVEYED DATE : 09/08/98

DATUM
VERTICAL : NAVD 88
HORIZONTAL : NAD 83 (92)



THESE PLANS ARE SUBJECT TO SUCH ENGINEERING CHANGES AS MAY BE REQUIRED BY THE FEDERAL HIGHWAY ADMINISTRATION OR THE DIRECTOR OF PROGRAM DEVELOPMENT.
CONSTRUCTION IS TO BE CARRIED ON IN ACCORDANCE WITH THESE PLANS AND THE STANDARD SPECIFICATIONS FOR CONSTRUCTION DATED 2006, AS APPROVED BY THE FEDERAL HIGHWAY ADMINISTRATION ON JUNE 15, 2006 FOR USE ON THIS PROJECT, INCLUDING ALL SUBSEQUENT REVISIONS AND SUCH REVISED SPECIFICATIONS AND SPECIAL PROVISIONS AS ARE INCORPORATED IN THESE PLANS.

PLOTTED 20-SEP-2010

DIRECTOR OF PROGRAM DEVELOPMENT	APPROVED _____ DATE _____
PROJECT MANAGER : C.P. WILLIAMS	
PROJECT NAME : CHESTER	
PROJECT NUMBER : BRF 025-1 (28)	
SHEET 9 OF 124 SHEETS	