

SEE SHEET 2 FOR INDEX OF SHEETS
AND LIST OF STANDARDS

STATE OF VERMONT AGENCY OF TRANSPORTATION

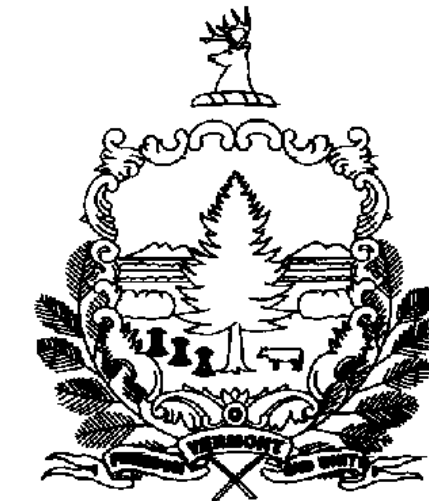

PROPOSED IMPROVEMENT BRIDGE PROJECT TOWN OF CHESTER COUNTY OF WINDSOR VT. ROUTE 103

RURAL PRINCIPAL ARTERIAL, NATIONAL HIGHWAY SYSTEM

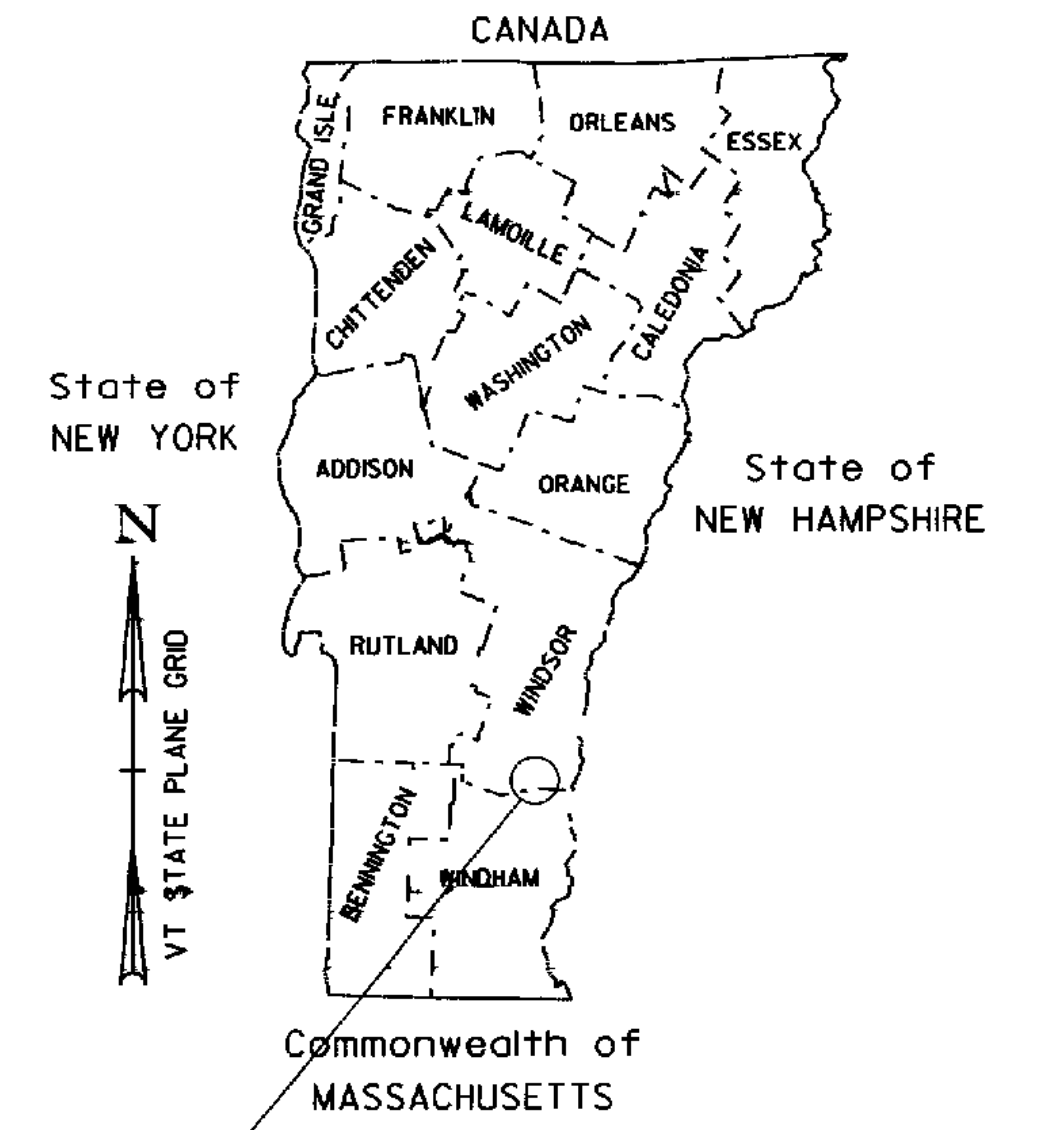

PROJECT BR 025-1 (28)
& BR 025-1 (37)

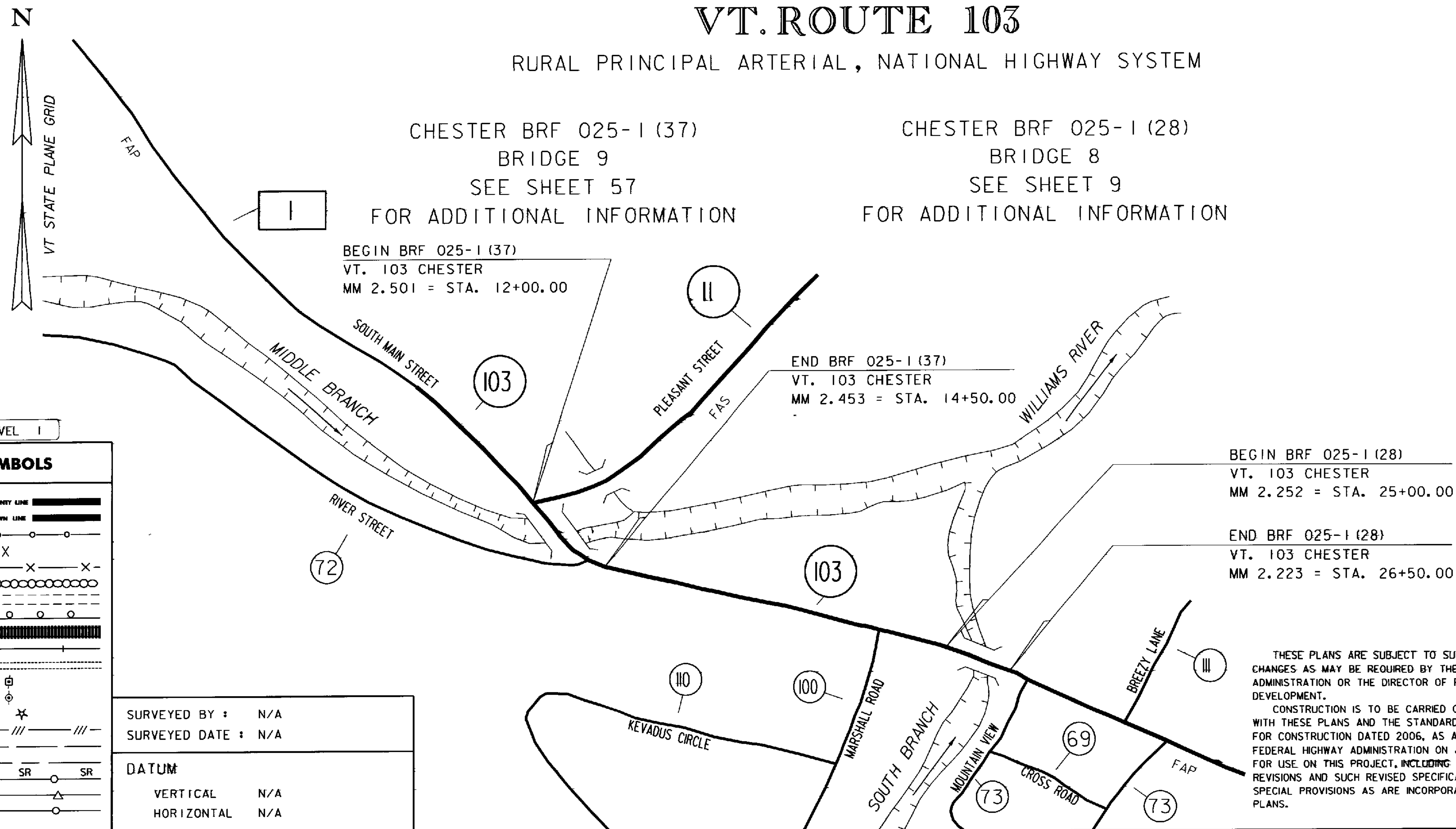

QUALITY ASSURANCE PROGRAM: LEVEL I

CONVENTIONAL SYMBOLS

COUNTY LINE	
TOWN LINE	
LIMITS OF ACCESS	
POINT OF ACCESS	
FENCE LINE	
STONE WALL	
TRAVELED WAY	
GUARD RAIL	
RAILROAD	
SURVEY LINE	
CULVERT	
POWER POLE	
TELEPHONE POLE	
TREES	
CONTROL OF ACCESS	
PROPERTY LINE	
R.O.W. TAKING LINE	
SLOPE RIGHTS	
TOP OF CUT	
TOE OF SLOPE	

SURVEYED BY : N/A
SURVEYED DATE : N/A

DATUM
VERTICAL : N/A
HORIZONTAL : N/A

THESE PLANS ARE SUBJECT TO SUCH ENGINEERING CHANGES AS MAY BE REQUIRED BY THE FEDERAL HIGHWAY ADMINISTRATION OR THE DIRECTOR OF PROGRAM DEVELOPMENT.
CONSTRUCTION IS TO BE CARRIED ON IN ACCORDANCE WITH THESE PLANS AND THE STANDARD SPECIFICATIONS FOR CONSTRUCTION DATED 2006, AS APPROVED BY THE FEDERAL HIGHWAY ADMINISTRATION ON JUNE 15, 2006 FOR USE ON THIS PROJECT, INCLUDING ALL SUBSEQUENT REVISIONS AND SUCH REVISED SPECIFICATIONS AND SPECIAL PROVISIONS AS ARE INCORPORATED IN THESE PLANS.

DIRECTOR OF PROGRAM DEVELOPMENT	APPROVED	DATE 9/19/10
PROJECT MANAGER : C. P. WILLIAMS		
PROJECT NAME : CHESTER & CHESTER		
PROJECT NUMBER : BR 025-1 (28) & BR 025-1 (37)		
SHEET 1 OF 124 SHEETS		