

**GRANITE CURBING ON BRIDGE**

1. THE ITEM 616.22 "GRANITE BRIDGE CURB" SHALL INCLUDE THE COSTS OF MORTAR, TYPE 1, EPOXY MORTAR, #4 GALVANIZED COATED ANCHORS, AND EPOXY USED TO SECURE THE ANCHORS TO THE GRANITE BRIDGE CURB.
2. BEFORE INSTALLATION OF THE GRANITE BRIDGE CURB THE CONTRACTOR SHALL PROVIDE THE RESIDENT ENGINEER WITH A TECHNICAL DATA SHEET FOR THE PROPOSED EPOXY FOR SECURING ANCHORS TO THE GRANITE CURBING. THE TECHNICAL DATA SHEET SHALL INCLUDE SPECIFICATIONS, AND MANUFACTURERS APPLICATION INSTRUCTIONS. THE RESIDENT ENGINEER SHALL APPROVE THE PRODUCT PRIOR TO ANY INSTALLATION.
3. THE GALVANIZED ANCHORS SHALL BE SHIPPED FROM THE SUPPLIER, AFTER CUTTING AND BENDING.
4. THE BLOCKS FOR THE GRANITE BRIDGE CURB MAY BE SHOP ASSEMBLED WITH THE ANCHORS WITH PERMISSION FROM THE RESIDENT ENGINEER.

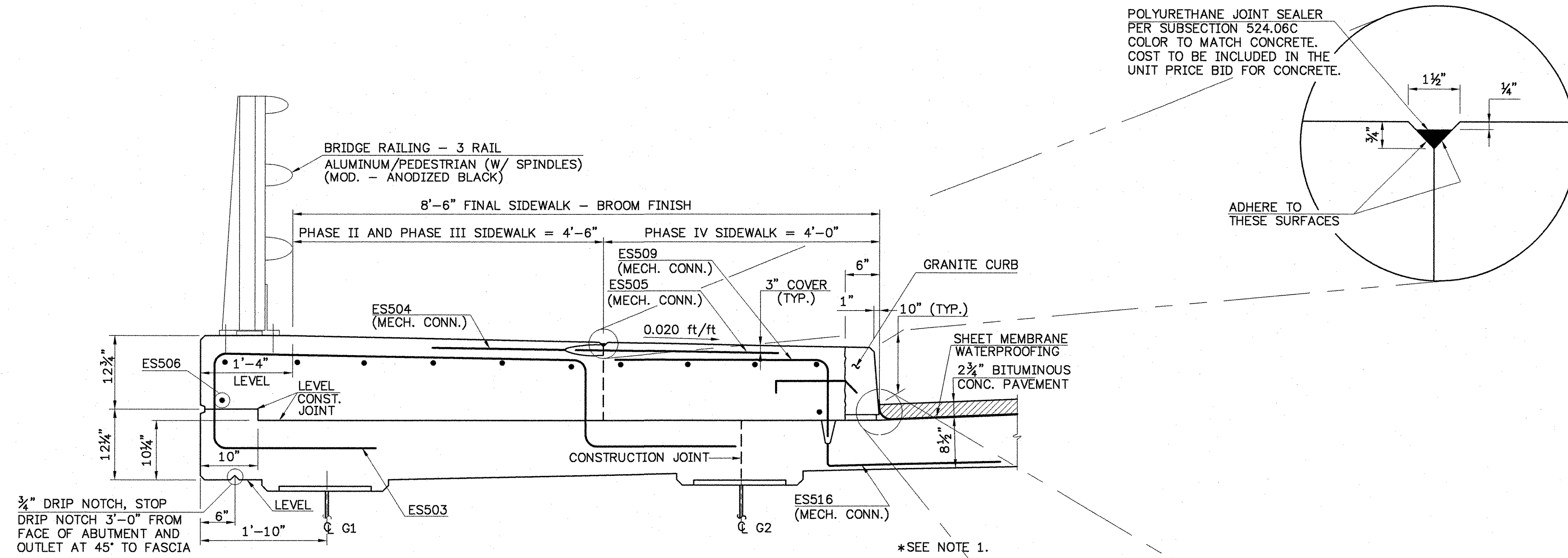

**SIDEWALK SECTION - LEFT FASCIA**

(RIGHT FASCIA SIMILAR)  
SCALE: 1" = 1'-0"

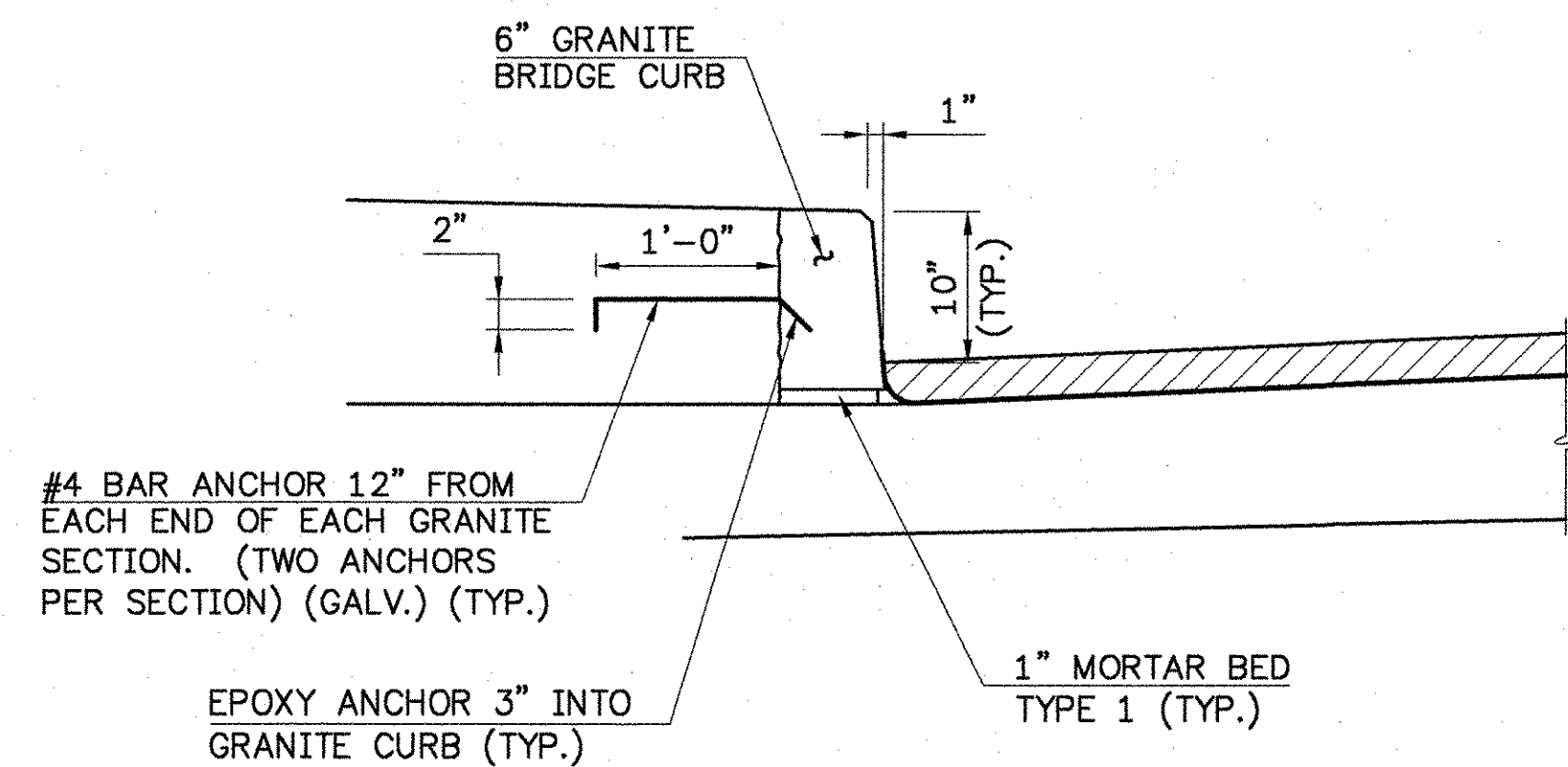

**GRANITE CURB ATTACHMENT DETAILS**

SCALE: 1" = 1'-0"

NOTE:  
THE BACK FACE OF THE GRANITE CURB SHALL BE SATURATED. SURFACE DRY IMMEDIATELY PRIOR TO PLACEMENT OF ADJACENT SIDEWALK OR CURB CONCRETE

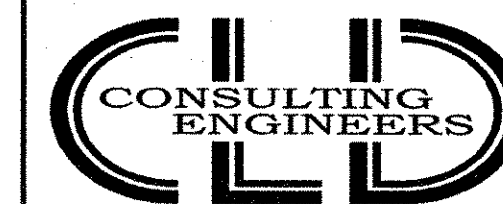
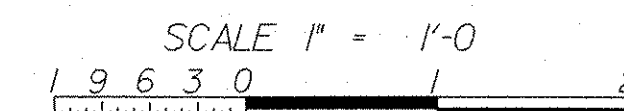
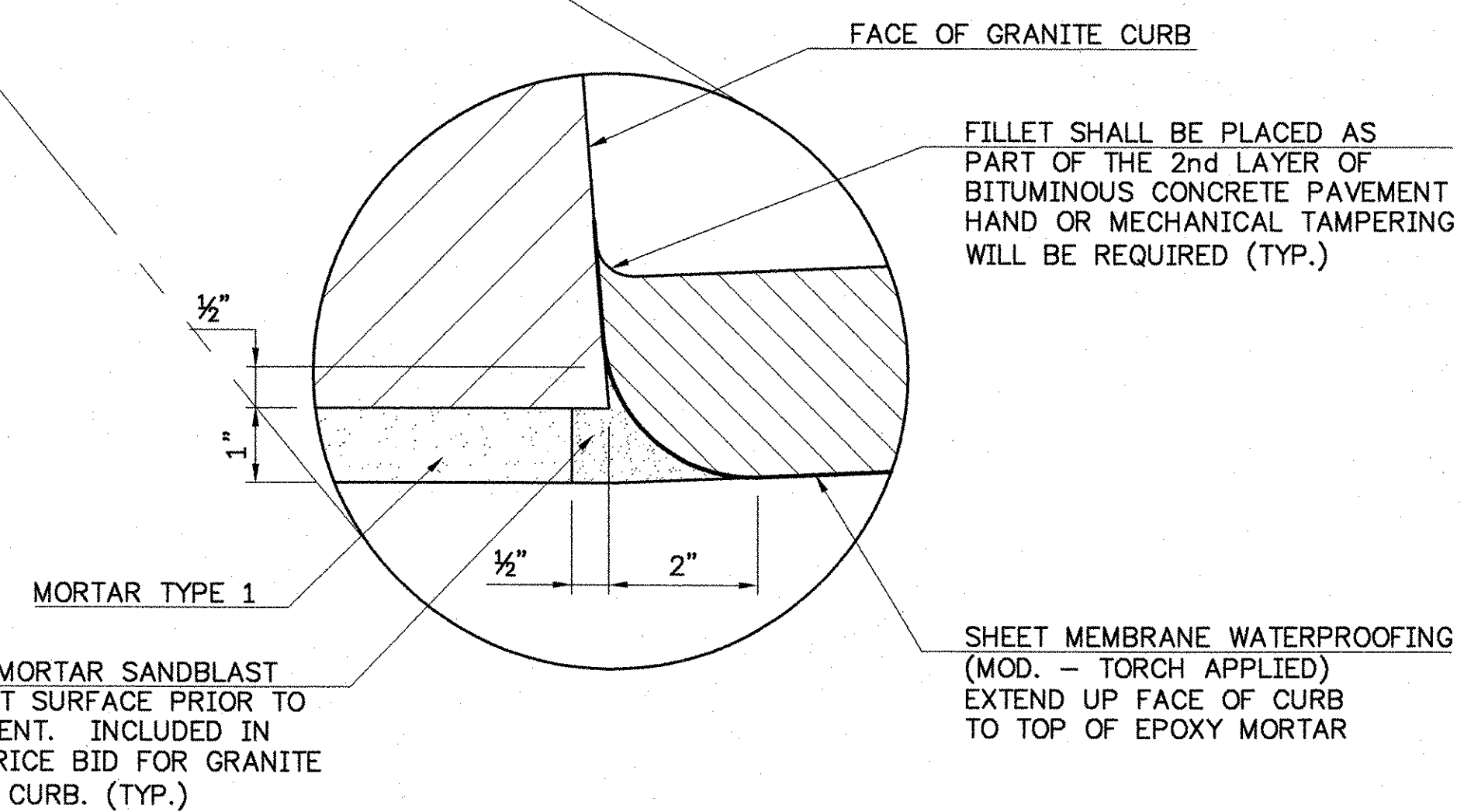

540 Commercial Street • Manchester, NH 03101  
(603) 668-8223 • Fax: (603) 668-8802  
clde@cldeengineers.com • www.cldeengineers.com  
Maine • New Hampshire • Vermont

<b>STATE OF VERMONT</b>		
<b>AGENCY OF TRANSPORTATION</b>		
Town Of	JOHNSON	Bridge No. 37
Highway No.	VT. ROUTE 15	Log Sta.
		Surv. Sta.
VT. ROUTE 15 OVER GIHON RIVER		
<b>MISCELLANEOUS DETAILS (2 OF 2)</b>		
Designed By	R. RICARD	Drawn By. M. SMITH
Checked By	Date	Bridge Design Supervisor
S. BEAUMONT	11/06	J. BYATT
Date		Date 11/06
<b>PROJECT</b>	JOHNSON	<b>PROJECT NO.</b>
		BRF 030-2(17)S
I.G.C. Info.		
Bridge Sheet No.	Sheet 55	Of 85