

STATE OF VERMONT AGENCY OF TRANSPORTATION



EROSION PREVENTION INDEX OF SHEETS

25	TITLE SHEET
26	EROSION PREVENTION AND SEDIMENT CONTROL NARRATIVE
27	EXISTING CONDITIONS SITE PLAN
28	EROSION PREVENTION & SEDIMENT CONTROL PLAN
29	FINAL CONDITIONS SITE PLAN
30	EROSION PREVENTION & SEDIMENT CONTROL DETAILS SILT FENCE
31	EROSION PREVENTION & SEDIMENT CONTROL DETAILS CHECK DAMS
32	EROSION PREVENTION & SEDIMENT CONTROL DETAILS DROP INLET PROTECTION
33	EROSION PREVENTION & SEDIMENT CONTROL DETAILS CONSTRUCTION ENTRANCE
34	EROSION PREVENTION & SEDIMENT CONTROL DETAILS DITCH AND SLOPE PROTECTION
35	EROSION PREVENTION & SEDIMENT CONTROL DETAILS TURBIDITY CURTAIN
36	BLANK

PROPOSED IMPROVEMENT TOWN OF JOHNSON COUNTY OF LAMOILLE VT ROUTE 15 (MINOR ARTERIAL)

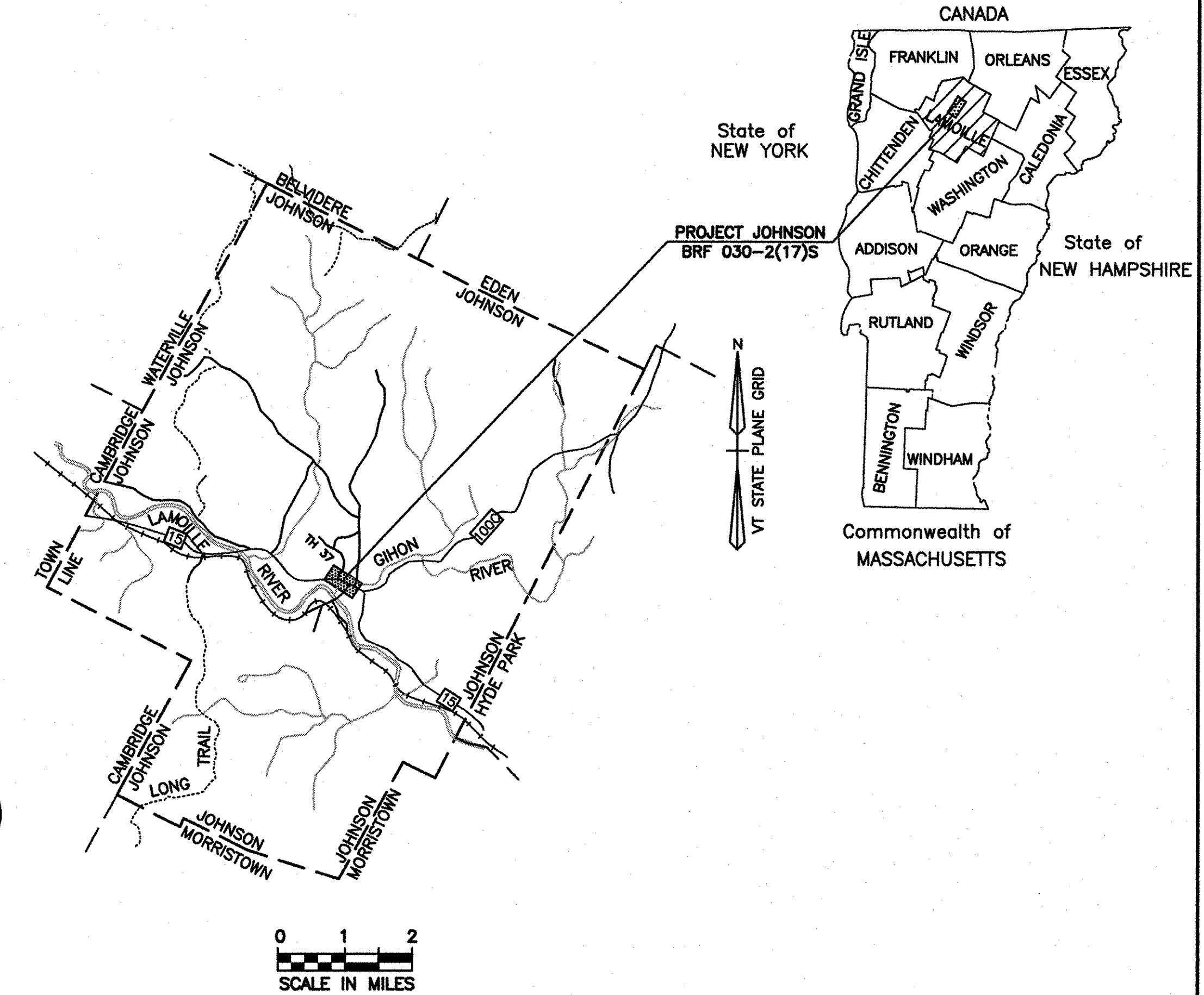

PROJECT LOCATION:
BEGINNING AT A POINT ON VT ROUTE 15 APPROX. 0.372 MILES WEST OF THE INTERSECTION OF VT ROUTE 15 AND VT ROUTE 100C, EXTENDING EASTERLY ALONG VT ROUTE 15 FOR 0.066 MILES.

LENGTH OF ROADWAY = 272.42 FEET = 0.051 MILES
LENGTH OF BRIDGE = 77.58 FEET = 0.015 MILES
LENGTH OF PROJECT = 350.00 FEET = 0.066 MILES

PROJECT DESCRIPTION:
THE REPLACEMENT OF A STRUCTURALLY DEFICIENT BRIDGE (BR#37) ON VT ROUTE 15 INCLUDING ALL THE NECESSARY ROADWAY APPROACH WORK.

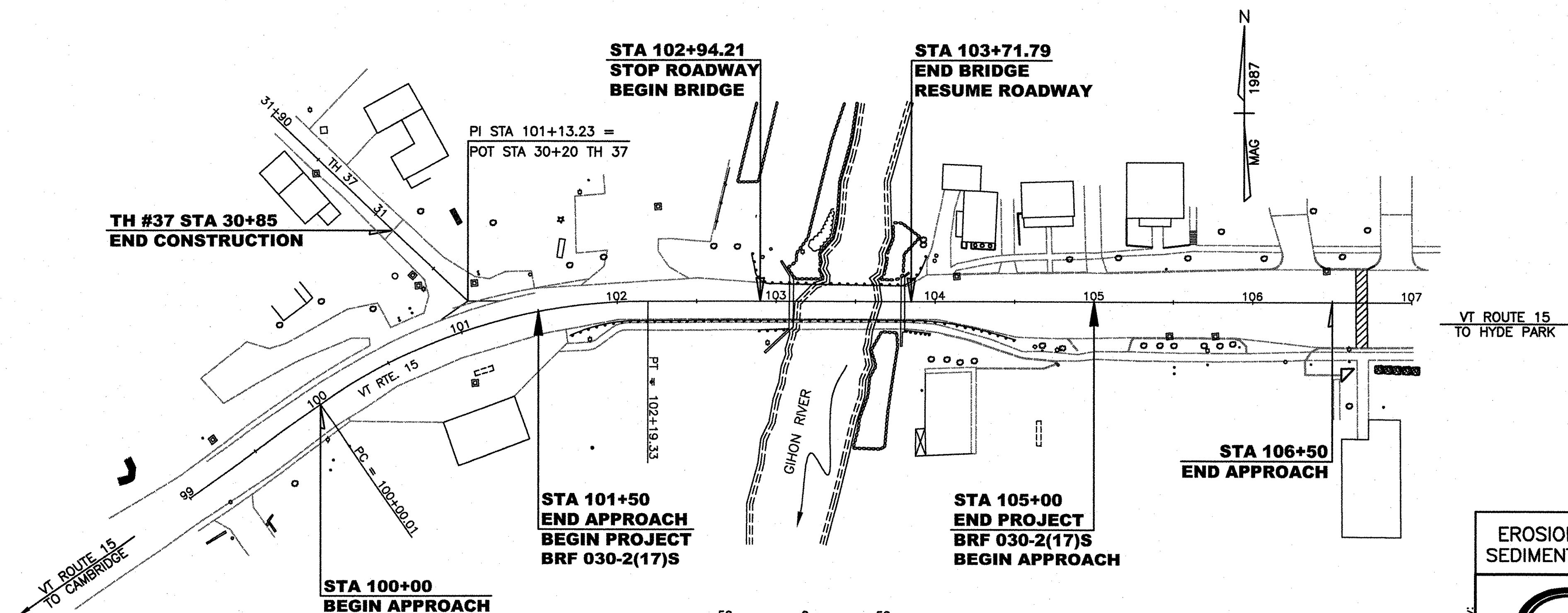

CONVENTIONAL SIGNS	
COUNTY LINE	---
TOWN LINE	- - - - -
LIMITS OF ACCESS	○-○-○-○
POINT OF ACCESS	X
FENCE LINE	x x x
STONE WALL	=====
TRAVELED WAY	=====
GUARDRAIL	○-○-○-○
RAILROAD	
SURVEY LINE	- - - - -
CULVERT	—○—
POWER POLE	⊕
TELEPHONE POLE	⊕
TREES	⊙
CONTROL OF ACCESS	///
PROPERTY LINE	---
R.O.W. TAKING LINE	SR
SLOPE RIGHTS	○-△
TOP OF CUT	△
TOE OF SLOPE	○

DATUM
VERTICAL NGVD 1929
HORIZONTAL N/A

THESE PLANS ARE SUBJECT TO SUCH ENGINEERING CHANGES AS MAY BE REQUIRED BY THE FEDERAL HIGHWAY ADMINISTRATION OR THE DIRECTOR OF PROGRAM DEVELOPMENT.
CONSTRUCTION IS TO BE CARRIED ON IN ACCORDANCE WITH THESE PLANS AND THE STANDARD SPECIFICATIONS FOR CONSTRUCTION DATED 2001, AS APPROVED BY THE FEDERAL HIGHWAY ADMINISTRATION ON JANUARY 4, 2001 FOR USE ON THIS PROJECT, INCLUDING ALL SUBSEQUENT REVISIONS AND SUCH REVISED SPECIFICATIONS AND SPECIAL PROVISIONS AS ARE INCORPORATED IN THESE PLANS.

EROSION PREVENTION & SEDIMENT CONTROL PLANS

Plans Prepared By:
CLD CONSULTING ENGINEERS Inc.
540 Commercial Street • Manchester, NH 03101
(603) 668-8223 • Fax: (603) 668-8802
cld@eldengineers.com • www.eldengineers.com
Maine • New Hampshire • Vermont

DIRECTOR OF PROGRAM DEVELOPMENT
APPROVED _____ DATE _____
PROJECT MANAGER: **W. SYMONDS**
PROJECT NAME: **JOHNSON**
PROJECT NUMBER: **BRF 030-2(17)S**
SHEET **25** OF **85** SHEETS
SHEET **1** OF **85** SHEETS