

RELOCATE MAILBOX, SINGLE SUPPORT
STA 100+68, LT
STA 101+17, LT

DEMOLITION & DISPOSAL OF BUILDING
STA 101+69, LT - LIGHTED PLANTER BOX W/SIGN

END MAINT. AGREE. AREA NO. 1
STA. 100+91 58' LT. LENGTH 48'

BEGIN MAINT. AGREE. AREA NO. 1
STA. 101+07 12' LT.

5" PORTLAND CEMENT CONCRETE SIDEWALK
STA 100+00 - 100+54, RT
STA 101+13 - 101+89, RT
STA 101+25 - 101+89, LT
STA 102+38 - 103+00, LT
STA 103+66 - 104+80, RT
STA 103+77 - 105+14, LT
STA 104+71 - 105+14, LT (3' WIDE)
STA 105+31 - 105+94, RT

REMOVAL AND DISPOSAL OF GUARDRAIL
STA 101+67 - 103+05, RT
STA 102+84 - 103+08, LT
STA 102+88 - 103+08, RT
STA 103+80 - 103+96, RT
STA 103+80 - 104+49, RT
STA 103+82 - 103+94, LT

CAST IN PLACE CONCRETE CURB TYPE B
STA 100+00 - 100+61, RT
STA 100+00 - 100+65, RT
STA 101+02 - 101+72, RT
STA 101+02 - 101+72, RT
STA 101+30 - 102+90, RT
STA 101+30 - 101+95, LT
STA 102+30 - 102+99, LT
STA 103+67 - 104+88, RT
STA 103+76 - 103+92, LT
STA 104+14 - 104+39, LT
STA 104+25 - 104+90, RT
STA 104+51 - 104+89, LT
STA 105+09 - 106+15, LT
STA 105+22 - 105+95, RT
STA 105+24 - 105+93, RT
STA 106+38 - 106+50, LT

CONSTRUCT DRIVE
STA 100+55, LT - 12'w GRAVEL
STA 100+20, RT - 30'w PAVED
STA 102+12, LT - 29'w PAVED
STA 104+03, LT - 18'w GRAVEL
STA 104+99, LT - 13'w GRAVEL
STA 105+05, RT - 32'w PAVED
STA 106+15, RT - 37'w PAVED
STA 106+30, LT - 20'w PAVED
STA 101+24, RT - 12'w PAVED
CHANGING ELEV. OF DROP INLETS, CATCH BASINS OR MANHOLES
STA 101+49, LT (BY OTHERS)
STA 105+21, LT (BY OTHERS)

CONSTRUCT SIDEWALK RAMP
STA 101+27, LT (TYPE 1)
STA 101+27, RT (TYPE 6)

ALUMINUM APPROACH RAIL (MOD)
STA 101+75 - 102+88, RT
STA 102+75 - 103+00, LT
STA 103+65 - 104+15, RT
STA 103+77 - 104+27, LT

BRIDGE RAILING - ALUMINUM/PEDESTRIAN
STA 102+88 - 103+65, RT
STA 103+00 - 103+77, LT

COLD PLANING - BIT. PAVEMENT
STA 100+00 - 100+50
STA 106+00 - 106+50

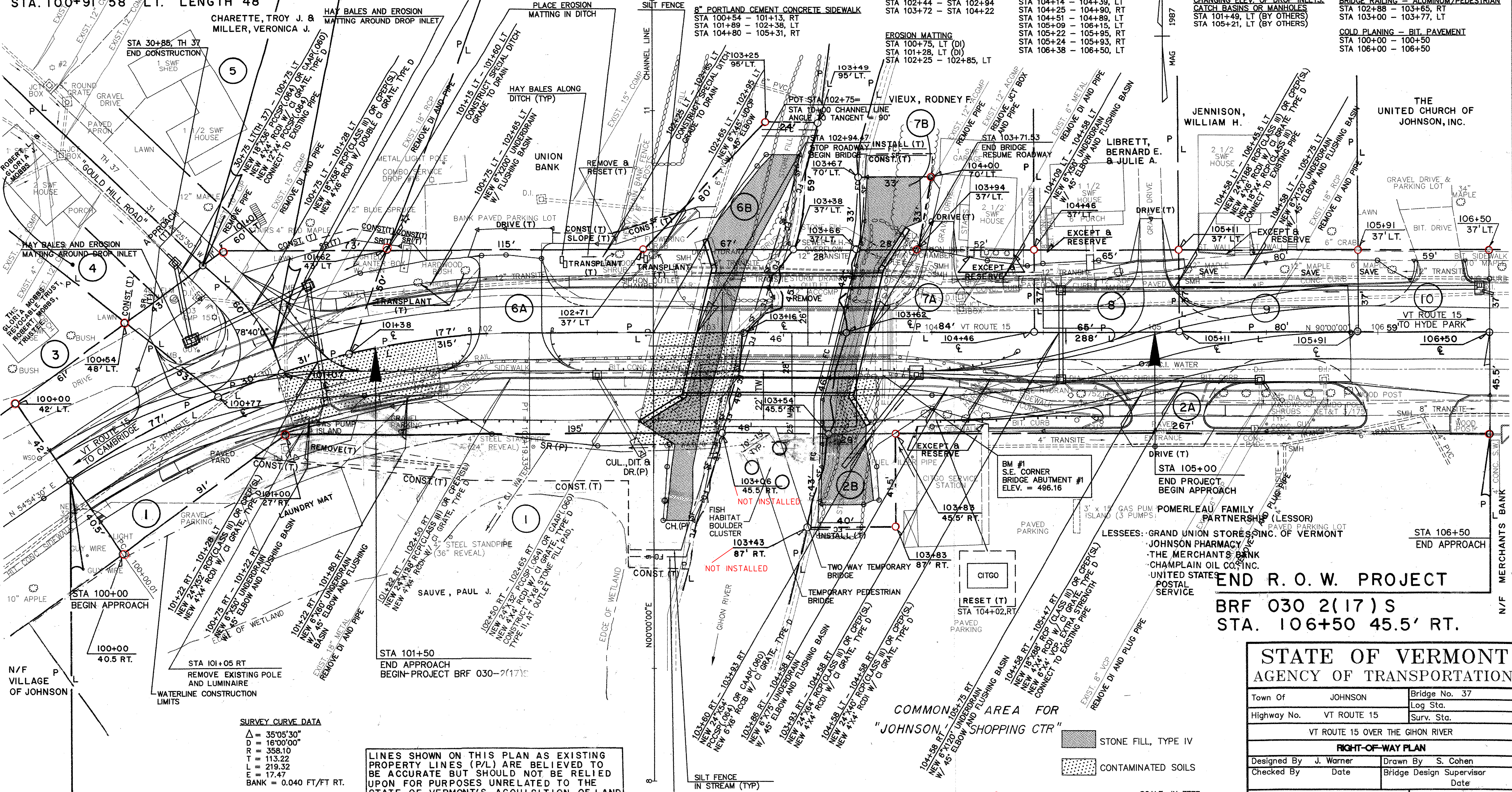

BEGIN R. O. W. PROJECT
BRF 030-2(17)S STA. 100+00

LINES SHOWN ON THIS PLAN AS EXISTING PROPERTY LINES (P/L) ARE BELIEVED TO BE ACCURATE BUT SHOULD NOT BE RELIED UPON FOR PURPOSES UNRELATED TO THE STATE OF VERMONT'S ACQUISITION OF LAND AND RIGHTS FOR THIS PROJECT.

SURVEY CURVE DATA
Δ = 35°05'30"
D = 16°00'00"
R = 358.10
T = 113.22
L = 219.32
E = 17.47
BANK = 0.040 FT/FT RT.

8" PORTLAND CEMENT CONCRETE SIDEWALK
STA 100+54 - 101+13, RT
STA 101+89 - 102+38, LT
STA 104+80 - 105+31, RT

EXTRA DEPTH OF SUBBASE
STA 102+44 - STA 102+94
STA 103+72 - STA 104+22

EROSION MATTING
STA 100+75, LT (DI)
STA 101+28, LT (DI)
STA 102+25 - 102+85, LT

REMOVE 8" RCP
STA 101+28, LT (DI)
STA 102+25 - 102+85, LT

JENNISON, WILLIAM H.
2 1/2 SWF HOUSE

LIBRETT, BERNARD E. & JULIE A.
1 1/2 SWF HOUSE

THE UNITED CHURCH OF JOHNSON, INC.
34" MAPLE

BM #1
S.E. CORNER
BRIDGE ABUTMENT #1
ELEV. = 496.16

STA 105+00
END PROJECT
BEGIN APPROACH

POMERLEAU FAMILY PARTNERSHIP (LESSOR)
LESSEES: GRAND UNION STORES, INC. OF VERMONT
JOHNSON PHARMACY
THE MERCHANTS BANK
CHAMPLAIN OIL CO., INC.
UNITED STATES POSTAL SERVICE

END R. O. W. PROJECT
BRF 030 2(17)S
STA. 106+50 45.5' RT.

STATE OF VERMONT
AGENCY OF TRANSPORTATION

Town Of	JOHNSON	Bridge No.	37
Highway No.	VT ROUTE 15	Log Sta.	
		Surv. Sta.	
VT ROUTE 15 OVER THE GHON RIVER			
RIGHT-OF-WAY PLAN			
Designed By	J. Warner	Drawn By	S. Cohen
Checked By	Date	Bridge Design Supervisor	Date
PROJECT	JOHNSON	PROJECT NO.	BRF 030-2(17)S
I.G.C. Info.			
R.O.W. SHEET 9 OF 9		SHEET 15 OF 85	

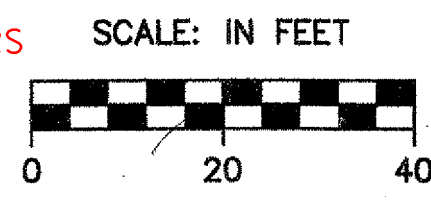

INSTALLED BOUNDARY MARKERS BY VAOT SURVEYERS