

PLAN	DATE
REVISION	BY
NOTE BOOK	
NO. OF WKS. CHECKED	
NO.	

PROFILE	DATE
REVISION	BY
NOTE BOOK	
NO. OF WKS. CHECKED	
NO.	

BEGIN R.O.W. PROJECT
BRS 0187(6) REV. STA. 11+50 CL

DATUM	
VERTICAL	NOVO 1929
HORIZONTAL	N/A

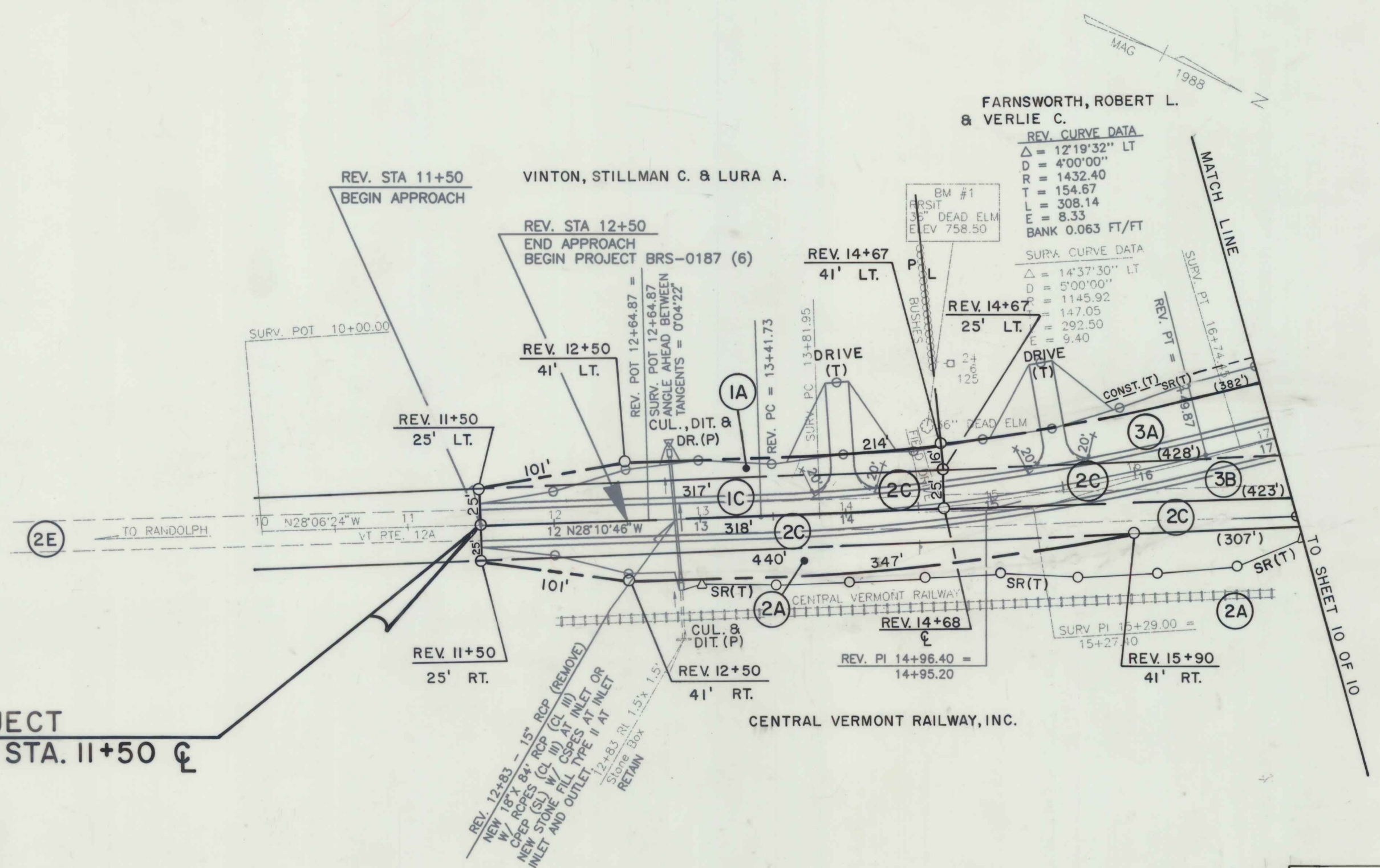
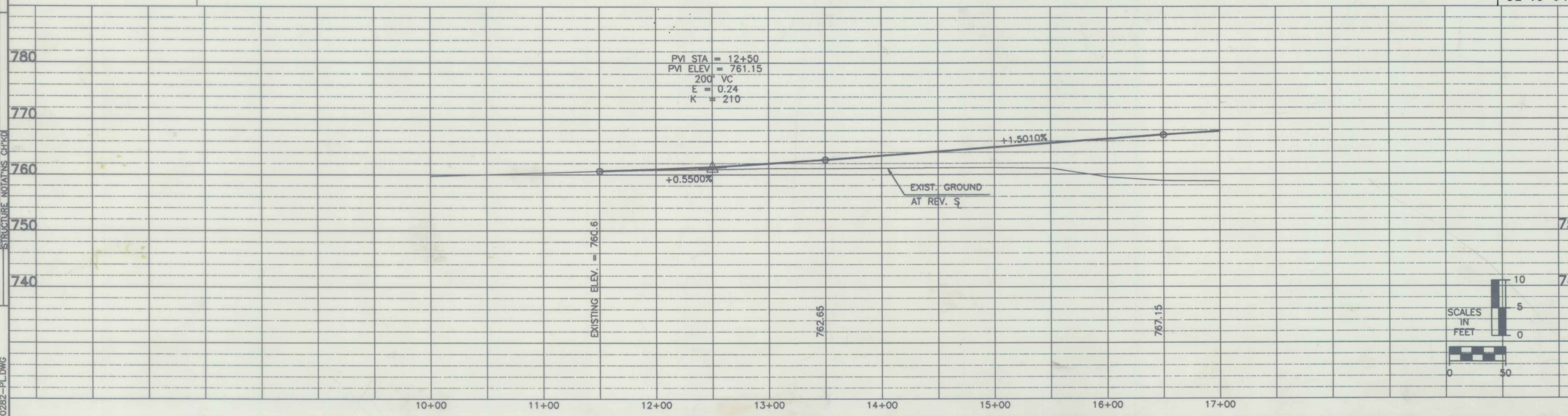

- REMOVAL AND DISPOSAL OF CURB POSTS
STA 12+83, LT & RT
- BREAKAWAY CABLE TERMINALS
STA 16+12 LT - 16+37 LT
STA 17+00 RT - 17+25 RT
- STEEL BEAM GUARD RAIL
STA 16+37 LT - 18+50 LT
- CONSTRUCT DRIVE
STA 14+00 LT - 16'w GRAVEL
STA 15+50 LT - 16'w GRAVEL
- SCARIFY PAVEMENT
STA 15+00 - 17+15

12-05-94 REVISION 3
02-10-94 REVISION 1

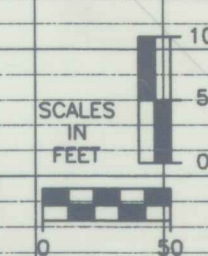
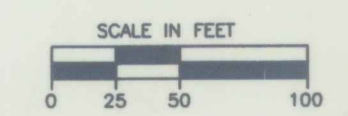

STATE OF VERMONT
AGENCY OF TRANSPORTATION

Town Of	BRAINTREE	Bridge No.	6
Highway No.	VT. Route 12A	Log Sta.	
		Surv. Sta.	

VT RTE 12A OVER THE THIRD BRANCH OF THE WHITE RIVER

PLAN AND ELEVATION

Designed By	J. Warner	Drawn By	N. Spaulding
Checked By		Bridge Design Supervisor	
		Date	

BRAINTREE
BRS 0187(6)
R.O.W. SHEET 9 OF 10 SHEETS