

**ABUTMENT NO.2 REINFORCING PLAN**

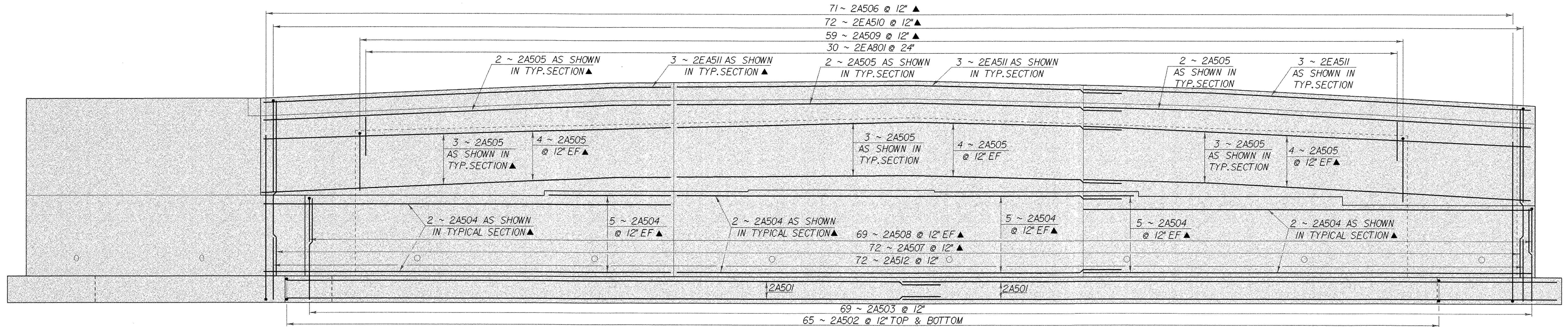

**ABUTMENT NO.2 REINFORCING ELEVATION**

**NOTE:**

NF - NEAR FACE  
 FF - FAR FACE  
 EF - EACH FACE  
 ▲ - CUT TO FIT IN FIELD  
 3" CLR. UNLESS OTHERWISE SPECIFIED ON THE PLANS.

SCALE 3/8" = 1'-0"

<b>STATE OF VERMONT AGENCY OF TRANSPORTATION</b>	
Town Of <b>WOODFORD</b>	Bridge No. <b>BR 11</b>
Highway No. <b>VT 9</b>	Log Sta. Surv. Sta.
<b>VT 9 OVER ROARING BRANCH OF WALLOOMSAC ABUTMENT * 2 REINFORCING</b>	
Designed By <b>M.EVANS-MONGEON</b>	Drawn By <b>R.PELLETT</b>
Checked By <b>M.EVANS-MONGEON</b>	Bridge Design Supervisor Date
PROJECT <b>WOODFORD</b>	PROJECT NO. <b>BHF 010-1(29)</b>
I.G.C. Info. <b>/846039/structures/se039sub.dgn</b>	<b>se039ar.21</b>
Bridge Sheet No.	Sheet <b>72</b> of <b>106</b>