

LINES SHOWN ON THIS PLAN AS EXISTING PROPERTY LINES P/L ARE BELIEVED TO BE ACCURATE BUT SHOULD NOT BE RELIED UPON FOR PURPOSES UNRELATED TO THE STATE OF VERMONT'S ACQUISITION OF LAND AND RIGHTS FOR THIS PROJECT.

**61+75  
END APPROACH  
BEGIN PROJECT**

**59+00  
BEGIN APPROACH**

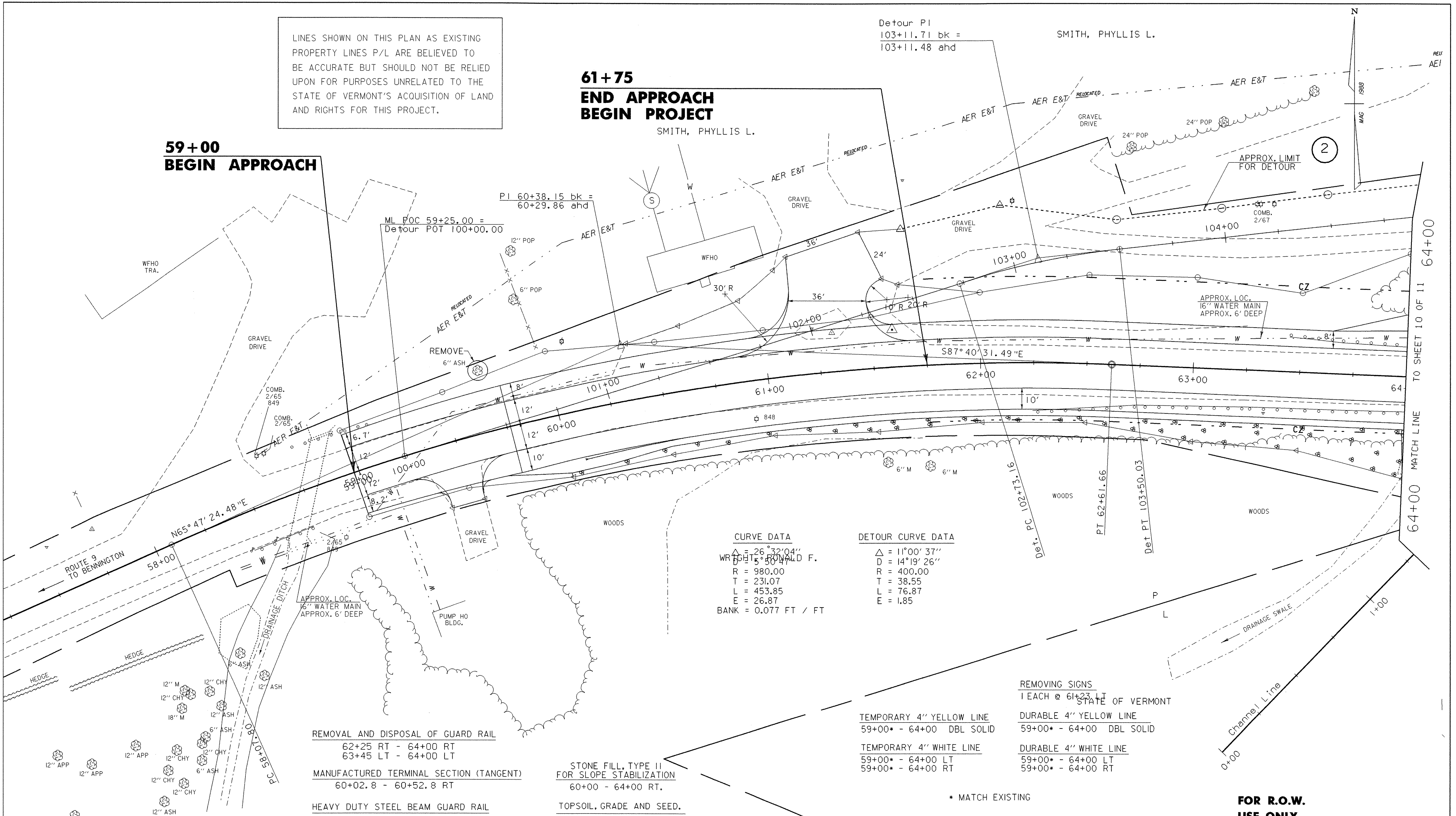

**CURVE DATA**

WRIGHT, RONALD F.

Δ	= 26°32'04"
R	= 980.00
T	= 231.07
L	= 453.85
E	= 26.87
BANK	= 0.077 FT / FT

**DETOUR CURVE DATA**

Δ	= 11°00'37"
D	= 14°19'26"
R	= 400.00
T	= 38.55
L	= 76.87
E	= 1.85

- REMOVAL AND DISPOSAL OF GUARD RAIL  
62+25 RT - 64+00 RT  
63+45 LT - 64+00 LT
- MANUFACTURED TERMINAL SECTION (TANGENT)  
60+02.8 - 60+52.8 RT
- HEAVY DUTY STEEL BEAM GUARD RAIL  
60+52.8 - 64+00 RT

- STONE FILL, TYPE II FOR SLOPE STABILIZATION  
60+00 - 64+00 RT.
- TOPSOIL, GRADE AND SEED.  
60+50-61+08 LT (EX. DRIVE)  
61+50-62+20 LT (EX. DRIVE)
- CONSTRUCT DRIVE  
59+48 RT (16' GRAVEL) w/5' PAVED APRON  
61+31 LT (36' GRAVEL) w/5' PAVED APRON

- REMOVING SIGNS  
1 EACH @ 61+23 LT STATE OF VERMONT
- |   |   |
|---|---|
| TEMPORARY 4" YELLOW LINE<br>59+00* - 64+00 DBL SOLID              | DURABLE 4" YELLOW LINE<br>59+00* - 64+00 DBL SOLID              |
| TEMPORARY 4" WHITE LINE<br>59+00* - 64+00 LT<br>59+00* - 64+00 RT | DURABLE 4" WHITE LINE<br>59+00* - 64+00 LT<br>59+00* - 64+00 RT |

\* NOTES: 1) CLEAR ZONE SHALL BE CLEARED TO LIMIT SHOWN ON THE PLANS.  
2) USE URBAN SEEDING FORMULA FOR ALL LAWN AREAS.

**DATUM**

VERTICAL	NGVD 1929
HORIZONTAL	N/A

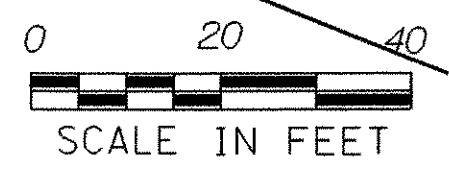

PROJECT: <b>WOODFORD</b>	PROJECT NO. : BHF 010-K(29)
DESIGN FILE NAME: /prop/84e039/re039zzz.dgn	PLOT DATE: 03-OCT-2005
IPARM FILE NAME: re039llr.i	SURVEYED BY: 12-88
SURVEYED BY: MOREAU	DRAWN BY: PJR/MGN
SQUAD LEADER: NYQUIST	
R. O. W. SHEET 9 OF 11 SHEETS	18 OF 106 SHEETS

TO SHEET 10 OF 11  
MATCH LINE  
64+00