

LINE REAMING DIAGRAM

LINE	(1)	(2)
1	1 1/2	4 1/4
2	1 1/8	4 1/8
3	1 7/8	4 3/8
4	1 1/8	4 1/4
5	2 1/8	4 1/2
6	2 1/8	4 3/8

SHOP DRAWING REVIEW
 REVIEW IS FOR GENERAL COMPLIANCE WITH CONTRACT REQUIREMENTS AND RESPONSIBILITY OF CONTRACTOR FOR CORRECTNESS OF SHOP DRAWINGS.
 APPROVED BY: [Signature]
 DATE: 1-30-95

NO.	REVISION	DATE

HIGH STEEL STRUCTURES, INC. 1770 Hempstead Road, Lancaster, Pa. 17606-0008, Phone 717/299-5211

SHOP ASSEMBLY DIAGRAM
 U.S. ROUTE 7 OVER OTTER CREEK
 BRIDGE NO. 79
 TOWN OF WALLINGFORD, COUNTY OF RUTLAND
 STATE OF VERMONT
 AGENCY OF TRANSPORTATION

CONTRACTOR: J. A. McDONALD, INC.
 PROJECT NO. BRS-0137(13)
 IN CHARGE: gbs MADE IN U.S.A. DATE: 1-30-95
 CONTRACT NUMBER: VT-95367 DRAWING NUMBER: SA1

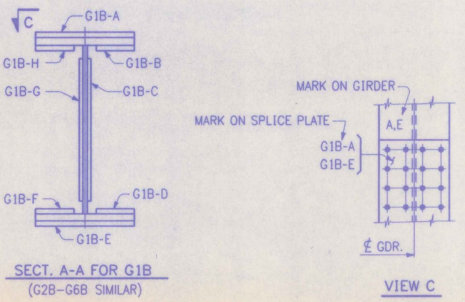

NOTES:

- HOLES MARKED [RA] ARE TO BE SUB-PUNCHED/SUB-DRILLED 1/4 Ø UNDER SIZE AND REAMED TO FULL SIZE OR DRILLED FROM SOLID WITH CONNECTING PARTS ASSEMBLED AND MATCH MARKED. FINAL HOLES TO BE 1/8 Ø.
- ALL SPLICE PLATES ARE MATCH MARKED AFTER REAMING, AS SHOWN IN SECT. A-A. THE MATCH MARKS ON THE SPLICE MATERIAL CONSIST OF THE MARK OF THE GIRDER THEY ARE SHIPPED WITH AND A SUFFIX. THE MARKINGS ARE LOCATED ON THE STEEL AT THE END OF THE SPLICE MATERIAL WHICH IS ON THE GIRDER IT IS SHIPPED WITH. THE CORRESPONDING SUFFIX (A,B,C,etc) IS MARKED NEAR THE SPLICE PLATE ON THE GIRDER (SEE VIEW C).
- FOR GIRDER MARKS SEE DWG. E2.