

ABUTMENT DIAPHRAGMS

| MARK | A     | B         | C         | D         | E      | K    |
|------|-------|-----------|-----------|-----------|--------|------|
| D26  | 5 3/4 | 14'-4 1/8 | 13'-7 1/8 | 13'-7 1/8 | 13 1/8 | 1/2  |
| D27  | 5 3/4 | 14'-5     | 13'-8     | 13'-8 1/2 | 13 1/8 | 1/2  |
| D28  | 5 3/4 | 14'-5 1/8 | 13'-8 1/8 | 13'-8 1/8 | 13 1/8 | 1/2  |
| D29  | 5 3/4 | 14'-5 3/8 | 13'-8 3/8 | 13'-8 1/2 | 13 1/8 | 1/2  |
| D30  | 5 3/8 | 14'-5 1/2 | 13'-8 1/2 | 13'-8 3/8 | 7 7/8  | 9/16 |

PAINT

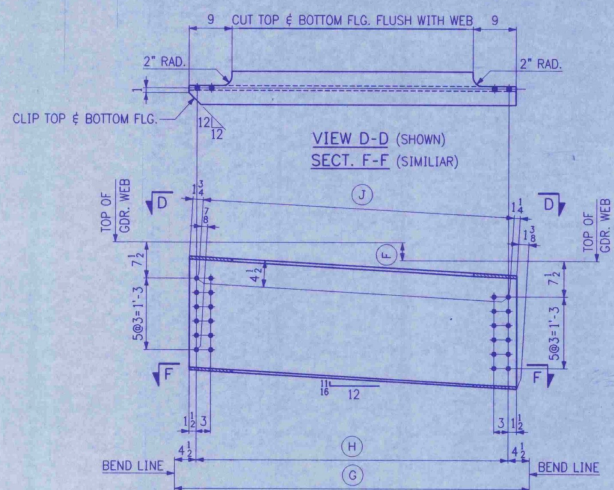
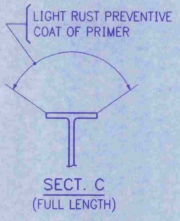

ABUTMENT DIAPHRAGMS

| MARK | F     | G         | H          | J          |
|------|-------|-----------|------------|------------|
| D31  | 9     | 13'-8 1/4 | 12'-11 1/4 | 12'-11 1/2 |
| D32  | 9     | 13'-8 3/8 | 12'-11 3/8 | 12'-11 3/8 |
| D33  | 9     | 13'-8 1/2 | 12'-11 1/2 | 12'-11 1/2 |
| D34  | 9 1/8 | 13'-8 5/8 | 12'-11 5/8 | 12'-11 7/8 |
| D35  | 9 1/8 | 13'-8 1/2 | 12'-11 1/2 | 12'-11 1/2 |

SHOP DRAWING REVIEW

APPROVED FOR SUBMITTAL COMPLIANCE WITH CONTRACT CONDITIONS AND RESPONSIBILITY OF CONTRACTOR FOR CONFORMANCE OF WORKMANSHIP ON DETAILS

APPROVED

APPROVED

APPROVED

APPROVED

Barrett and Jarvis, Inc.

DATE: 4-16-94

SHOP NOTE

HOLES: 1/8"

BOLTS: NONE

PAINT: AS NOTED. SEE DWG. N1.

FOR GENERAL SHOP NOTES, SEE DWG. N1.

| NO. | MARK | DESCR |
|-----|------|-------|
|     |      | DIAPH |
| 1   | D26  | W24 x |
| 1   | D27  | W24 x |
| 1   | D28  | W24 x |
| 1   | D29  | W24 x |
| 1   | D30  | W24 x |
| 1   | D31  | W24 x |
| 1   | D32  | W24 x |
| 1   | D33  | W24 x |
| 1   | D34  | W24 x |
| 1   | D35  | W24 x |

|                          |                      |
|--------------------------|----------------------|
| <input type="checkbox"/> | STATE CONTRACT PR    |
| <input type="checkbox"/> | OR REF. NO.          |
| <input type="checkbox"/> | CONTRACTOR J. A.     |
| <input type="checkbox"/> | IN CHARGE abs        |
| <input type="checkbox"/> | CONTRACT NUMBER VT-9 |