

FED. ROAD DIV. NO.	STATE	FED. AID PROJ. NO.
	VT	

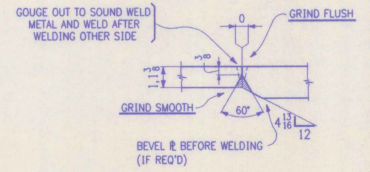
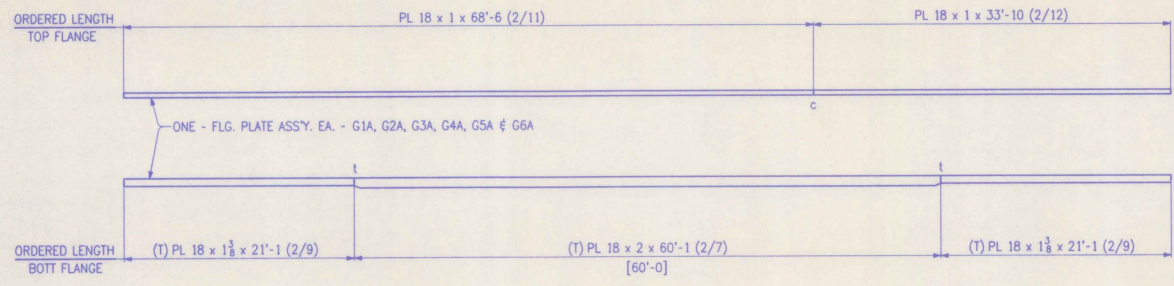

TYP. FLG. SPLICE DET.  
(B-12c-S)

SHOP DRAWING REVIEW	
REVIEWED IN ACCORDANCE WITH CONTRACT REQUIREMENTS FOR QUALITY CONTROL AND COMPLIANCE WITH ALL APPLICABLE CODES AND REGULATIONS.	
DATE	BY
5-1-96	3MB

- NOTES:**
- FOR GENERAL SHOP NOTES SEE DRAWING N1.
  - THE LETTERS "t" & "c" AT FLANGE SPLICES INDICATE TENSION AND COMPRESSION SPLICES RESPECTIVELY.
  - SPLICES MARKED (t) TO BE RADIOGRAPHICALLY TESTED 100%. SPLICES MARKED (c) TO BE RADIOGRAPHICALLY TESTED 25%.
  - (T) INDICATES PLATES THAT REQUIRE CHARPY V-NOTCH TEST.
  - DIMENSIONS SHOWN THUS: [60'-0] ARE THE ACTUAL DIMENSIONS THAT WILL APPEAR ON THE DETAIL DRAWINGS.

NO.	REVISION	DATE
<b>HIGH STEEL STRUCTURES, INC.</b> 1770 Hempstead Road Lancaster, PA 17603-5008 Phone 717/299-5211 <i>A Division of High Industries, Inc.</i>		
<b>FLANGE SPLICE DETAILS</b> U.S. ROUTE 7 OVER RAILROAD BRIDGE NO. 80 TOWN OF WALLINGFORD, COUNTY OF RUTLAND STATE OF VERMONT AGENCY OF TRANSPORTATION		
STATE CONTRACT OR REF. NO. PROJECT NO. BRS-0137(13)		
CONTRACTOR J. A. McDONALD, INC.		
IN CHARGE: <i>abs</i> MAKE: <i>LD</i> 1-29 CHECKED BY: <i>z</i> DATE: 1-30-96		
CONTRACT NUMBER: VT-95368		DRAWING NUMBER: FSI

CODE: 30