

LATERAL GUSSET PLATES

MARK	No. REQ'D	(H)	(V)	LEN1	(B)	
x1p	2	8 1/4	5 3/8	2 1/8	1'-0 3/8	FLAT
x1s	4	8 1/16	4 1/16	2 3/4	1'-1 1/2	FLAT
x1t	4	8 1/16	4 1/16	2 3/4	1'-1 1/2	3/8
x1w	4	8 1/16	4 1/16	2 3/4	1'-1 1/2	3/8
x1y	4	8 1/16	4 1/16	2 3/4	1'-1 1/2	3/8
x1oa	4	8 1/16	4 1/16	2 3/4	1'-1 1/2	1/4
x1ob	4	8 1/16	4 1/16	2 3/4	1'-1 1/2	1/4
x1oc	4	8 1/16	4 1/16	2 3/4	1'-1 1/2	1/4
x1od	6	8 1/16	4 1/16	2 3/4	1'-1 1/2	3/16
x1of	6	8 1/16	4 1/16	2 3/4	1'-1 1/2	3/16
x1og	2	8 1/16	4 1/16	2 3/4	1'-1 1/2	5/16
x1oh	2	8 1/16	4 1/16	2 3/4	1'-1 1/2	5/16
x1ok	2	9 3/8	4 1/2	3 3/8	1'-2 1/4	FLAT
x1om	2	10 1/8	4 1/2	3 13/16	1'-2 1/8	1/8
x1on	2	10 1/8	4 1/2	3 13/16	1'-2 1/8	1/8

LATERAL GUSSET PLATES

MARK	No. REQ'D	(H)	(V)	LEN2	(B)	
x1op	4	8 1/16	4 3/8	3 1/8	1'-1 1/2	FLAT
x1os	4	8 1/16	4 3/8	3 1/8	1'-1 1/2	3/8
x1ot	4	8 1/16	4 3/8	3 1/8	1'-1 1/2	3/8
x1ow	4	8 1/16	4 3/8	3 1/8	1'-1 1/2	3/8
x1oy	4	8 1/16	4 3/8	3 1/8	1'-1 1/2	3/8
x1ba	4	8 1/16	4 3/8	3 1/8	1'-1 1/2	1/4
x1bb	4	8 1/16	4 3/8	3 1/8	1'-1 1/2	1/4
x1bc	6	8 1/16	4 3/8	3 1/8	1'-1 1/2	3/16
x1bd	6	8 1/16	4 3/8	3 1/8	1'-1 1/2	3/16
x1bf	2	8 1/16	4 3/8	3 1/8	1'-1 1/2	5/16
x1bg	2	8 1/16	4 3/8	3 1/8	1'-1 1/2	5/16
x1bh	2	9 5/8	4 3/8	3 11/16	1'-2 1/4	FLAT
x1bk	2	10 1/8	3 1/8	4 1/8	1'-2 1/8	1/8
x1bm	2	10 1/8	3 1/8	4 1/8	1'-2 1/8	1/8

SHOP DRAWING REVIEW
 REVIEWED BY: [Signature]
 DATE: MAR-2-2-1996
 BY: [Signature]

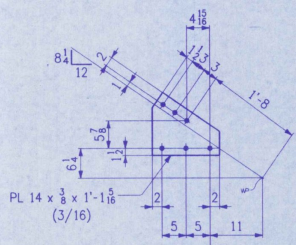

SHOP NOTE
 HOLES: 1/8" Ø (UN)
 BOLTS: NONE
 PAINT: NONE
 FOR GENERAL SHOP NOTES, SEE DWG. N1.

NO.	REVISION	DATE
		2-19-96

HIGH STEEL STRUCTURES, INC.
 1770 Hempstead Road
 Danvers, MA 01923-0008
 Phone: 715/259-5211
 A Division of High Industries

GIRDER JOB STANDARDS
 U.S. ROUTE 7 OVER OTTER CREEK
 BRIDGE NO. 79
 TOWN OF WALLINGFORD, COUNTY OF RUTLAND
 STATE OF VERMONT
 AGENCY OF TRANSPORTATION

STATE CONTRACT OR REF. NO. PROJECT NO. BRS-0137(13)
 CONTRACTOR: J. A. McDONALD, INC.
 IN CHARGE: abs MARK PPP 1-25 CHVD LD DATE: 2-1-96
 CONTRACT NUMBER: VT-95367 DRAWING NUMBER: X1

MAR 01 1996