

LINE REAMING DIAGRAM

| LINE | (1) | (2) |
|------|------------------|----------------|
| 1 | $1\frac{1}{4}$ | $4\frac{1}{2}$ |
| 2 | $1\frac{13}{16}$ | $4\frac{5}{8}$ |
| 3 | $1\frac{7}{8}$ | $4\frac{3}{8}$ |
| 4 | $1\frac{15}{16}$ | $4\frac{7}{8}$ |
| 5 | $2\frac{1}{16}$ | $4\frac{1}{2}$ |
| 6 | $2\frac{3}{16}$ | $4\frac{5}{8}$ |

SHOP DRAWING REVIEW

REVIEWED FOR CONFORMANCE WITH CONTRACT REQUIREMENTS AND SPECIFICATIONS AND FOR CORRECTNESS OF DIMENSIONS AND MATERIALS.

| | |
|-------------|------|
| DESIGNED BY | DATE |
| CHECKED BY | DATE |
| APPROVED BY | DATE |

Barling and Jarvis, Inc.
1116
1116
MAR 22 1986 BY: [Signature]

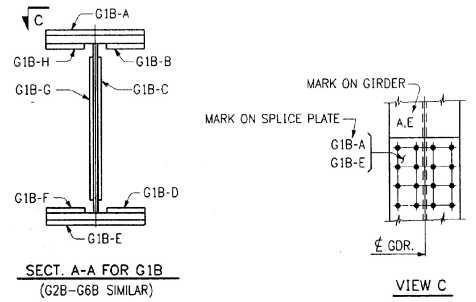

NOTES:

- HOLES MARKED [RA] ARE TO BE SUB-PUNCHED/SUB-DRILLED 1/4 Ø UNDER SIZE AND REAMED TO FULL SIZE OR DRILLED FROM SOLID WITH CONNECTING PARTS ASSEMBLED AND MATCH MARKED. FINAL HOLES TO BE 5/8 Ø.
- ALL SPLICE PLATES ARE MATCH MARKED AFTER REAMING, AS SHOWN IN SECT. A-A. THE MATCH MARKS ON THE SPLICE MATERIAL CONSIST OF THE MARK OF THE GIRDER THEY ARE SHIPPED WITH AND A SUFFIX. THE MARKINGS ARE LOCATED ON THE STEEL AT THE END OF THE SPLICE MATERIAL WHICH IS ON THE GIRDER IT IS SHIPPED WITH. THE CORRESPONDING SUFFIX (A,B,C,etc) IS MARKED NEAR THE SPLICE PLATE ON THE GIRDER (SEE VIEW C).
- FOR GIRDER MARKS SEE DWG. E2.

| | | |
|-----|----------|------|
| NO. | REVISION | DATE |
| | | |
| | | |

HIGH STEEL STRUCTURES, INC. 1770 Hempstead Road, Lancaster, PA 17608-5008, Phone 717/299-5213. A Division of High Industries, Inc.

SHOP ASSEMBLY DIAGRAM
U.S. ROUTE 7 OVER OTTER CREEK
BRIDGE NO. 79
TOWN OF WALLINGFORD, COUNTY OF RUTLAND
STATE OF VERMONT
AGENCY OF TRANSPORTATION

STATE CONTRACT OR REF. NO. PROJECT NO. BRS-0137(13)
CONTRACTOR J. A. McDONALD, INC.
IN CHARGE gbs MAKE LD 1-29 CHK'D BY SA DATE 1-30-86
CONTRACT NUMBER VT-95367 DRAWING NUMBER SA1