

GIRDER ~ MK. G2A

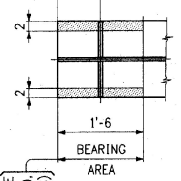

PAINT LIGHT RUST PREVENTIVE COAT OF PRIMER (FS) EDGES & SHADED AREA (NS)

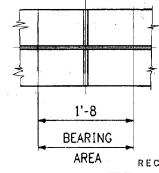
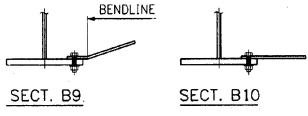

RECEIVED  
 CHK'D BY: [ ]  
 DEC 27 1996  
 DESIGNED BY: [ ]  
 CHECKED BY: [ ]

WORK THIS DWG. WITH DWG. 8

NO.	REVISION	DATE

HIGH STEEL STRUCTURES, INC. 1770 Hempstead Road  
 Lancaster, PA 17605-0008  
 Phone 717/288-5211  
 A Division of High Industries, Inc.

**GIRDER** **G2A**  
 U.S. ROUTE 7 OVER OTTER CREEK  
 BRIDGE NO. 79  
 TOWN OF WALLINGFORD, COUNTY OF RUTLAND  
 STATE OF VERMONT  
 AGENCY OF TRANSPORTATION  
 PROJECT NO. BR5-0137(13)

STATE CONTRACT OR REF. NO. J. A. McDONALD, INC.  
 CONTRACTOR  
 IN CHARGE: **cbs** MAKE: **PPP** 2:1 CHK'D BY: **LD** DATE: 2-2-96  
 CONTRACT NUMBER: **VT-95367** DRAWING NUMBER: **7 OF 24**

CODE: 30