

NO.		MARK	DESCRIPTION	LENGTH	REMARKS	ITEM	QTY	
1	a		PL 39 x 1/2	32	2 1/2 (T)	2	13.5	
1	b		PL 39 x 1/2	69	8 1/2 (T)	2	24.3	
1	c		PL 18 x 1	68	4	2	11.0	
1	d		PL 18 x 1	33	7 1/2	2	10.0	
1	f		PL 18 x 1 1/8	20	11 1/8 (T)	2	9.0	
1	g		PL 18 x 2	60	0 (T)	2	12.0	
1	h		PL 18 x 1 1/8	20	11 1/8 (T)	2	9.0	
4	x1a		PL 8 1/2 x 2	3	3	3	1.5	
1	x1bh		PL 39 x 1/2	1	0 1/2	BENT	3	4.5
1	x1bt		PL 39 x 1/2	1	1 1/8	BENT	3	4.5
1	x1od		BAR 8 x 1/2	3	3		3	9.0
1	x1oc		BAR 8 x 1/2	3	3		3	9.0
1	x1od		BAR 8 x 1/2	3	3		3	9.0
1	x1of		BAR 8 x 1/2	3	3		3	9.0
1	x1ok		BAR 8 x 1/2	3	3		3	9.0
1	x1omR		BAR 3 1/2 x 1/4	1	0 1/2		3	1.5

TOTAL WEIGHT THIS DWG. ITEM 506.55 = 24,346.50
TOTAL WT. FURNISHED ITEM 514.55 = 168,664.66
TOTAL WT. FURNISHED ITEM 531.10 = 1,686.30

PAINT LIGHT RUST PREVENTIVE COAT OF PRIMER (FS), EDGES & SHADED AREA (NS)

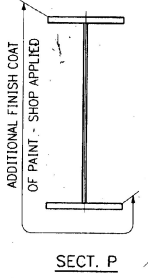
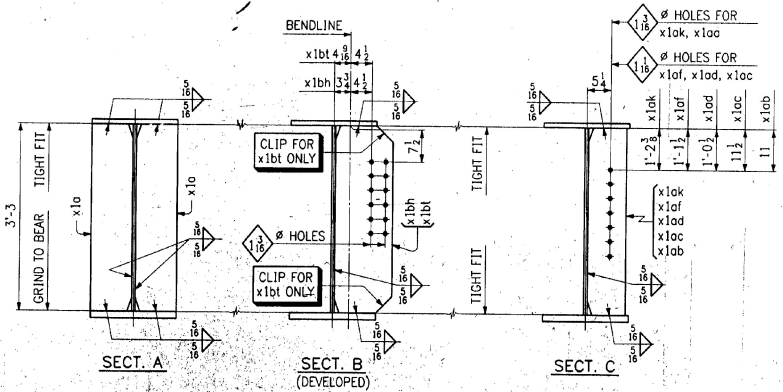

SHOP NOTE
HOLES: 1/8" (UN)
BOLTS: NONE
PAINT: AS NOTED, SEE DWG. N1
FOR GENERAL SHOP NOTES, SEE DWG. N1.
FOR WEB CAMBER DIAGRAM, SEE DWG. WC1.

RECEIVED
BY: _____
DATE: DEC 27 1988

NO.	REVISION	DATE

HIGH STEEL STRUCTURES, INC. 1770 Hempstead Road
Lancaster, PA 17603-0008
Phone 717/298-9211
A Division of High Industries, Inc.

GIRDER	G6A
U.S. ROUTE 7 OVER RAILROAD	
BRIDGE NO. 80	
TOWN OF WALLINGFORD, COUNTY OF RUTLAND	
STATE OF VERMONT	
AGENCY OF TRANSPORTATION	
PROJECT NO. BRS-0137(13)	

CONTRACTOR: J. A. McDONALD, INC.
IN CHARGE: abs
DRAWING NUMBER: VT-95368
DATE: 2-21-96
BY: _____