

PANEL GENERAL NOTES

1. REINFORCING BARS SHALL BE STEEL ASTM A615 GRADE 60.
2. THE STRIPS SHALL BE STEEL ASTM A570 GRADE 50 (GALVANIZED PER ASTM A-123).
3. ALL FRONT EDGES OF PANELS, EXCEPT THE BOTTOM EDGE OF THE BOTTOM PANEL COURSE, SHALL HAVE A 3/8" CHAMFER.
4. THE STRIPS SHALL BE PLACED WITHIN 1" OF THE DIMENSIONS SHOWN ON THE FABRICATION DRAWINGS.
5. PANEL DESIGN THICKNESS IS 5 1/2". THE QUANTITY OF CONCRETE WILL INCREASE TO ACCOMMODATE ANY ARCHITECTURAL SURFACE FINISH THAT MAY BE SPECIFIED.
6. EACH 3/4" Ø PIN SHALL BE A MINIMUM LENGTH OF 10". PINS MAY BE GALVANIZED STEEL OR PVC ROD. A SINGLE FULL LENGTH DOWEL MAY BE USED AT THE DISCRETION OF THE MANUFACTURER.
7. DIMENSIONS SPECIFIED ON INDIVIDUAL FABRICATION DRAWINGS SUPERSEDE THOSE CALLED OUT ON THE STANDARD SECTIONS AND DETAILS.
8. VERTICAL REINFORCING BARS SHALL BE PLACED 1 1/2" MIN., 2"(TYP.) FROM THE BACK FACE OF THE 5 1/2" PANEL.
9. ALL REINFORCING BARS SHALL BE STOPPED 2" CLEAR FROM ANY EDGE OF PANEL UNLESS NOTED ON INDIVIDUAL FABRICATION DRAWING OR AS INDICATED IN NOTE #10.
10. IN ALL SLOPED PANELS (xxK, xxC, xxi, xxl, xxM, xxN, xxO, xxU) THE TWO (2) VERTICAL REINFORCING BARS ADJACENT TO A COMMON TIE STRIP SHALL BE OF THE SAME LENGTH.
11. NOTE DETELED
12. ALL INDIVIDUAL FABRICATION DRAWINGS ARE SHOWN BACK FACE.
13. REINFORCING BARS IN A STANDARD "A" PANEL SHALL BE AS FOLLOWS:

PANEL REINFORCEMENT

PIECE MARK	HORIZONTAL BARS	VERTICAL BARS
XX-XX-R6	4-#4	6-#3
XX-XX-R7	4-#4	6-#4

HORIZONTAL REINFORCEMENT IN THE OTHER PANEL TYPES IS PROPORTIONATE TO THEIR RELATIVE HEIGHT.

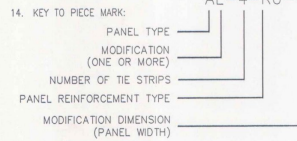

15. LIFTING INSERTS SHALL BE BURKE 1 TON #79-050 RAPID LIFT ANCHOR OR EQUAL.

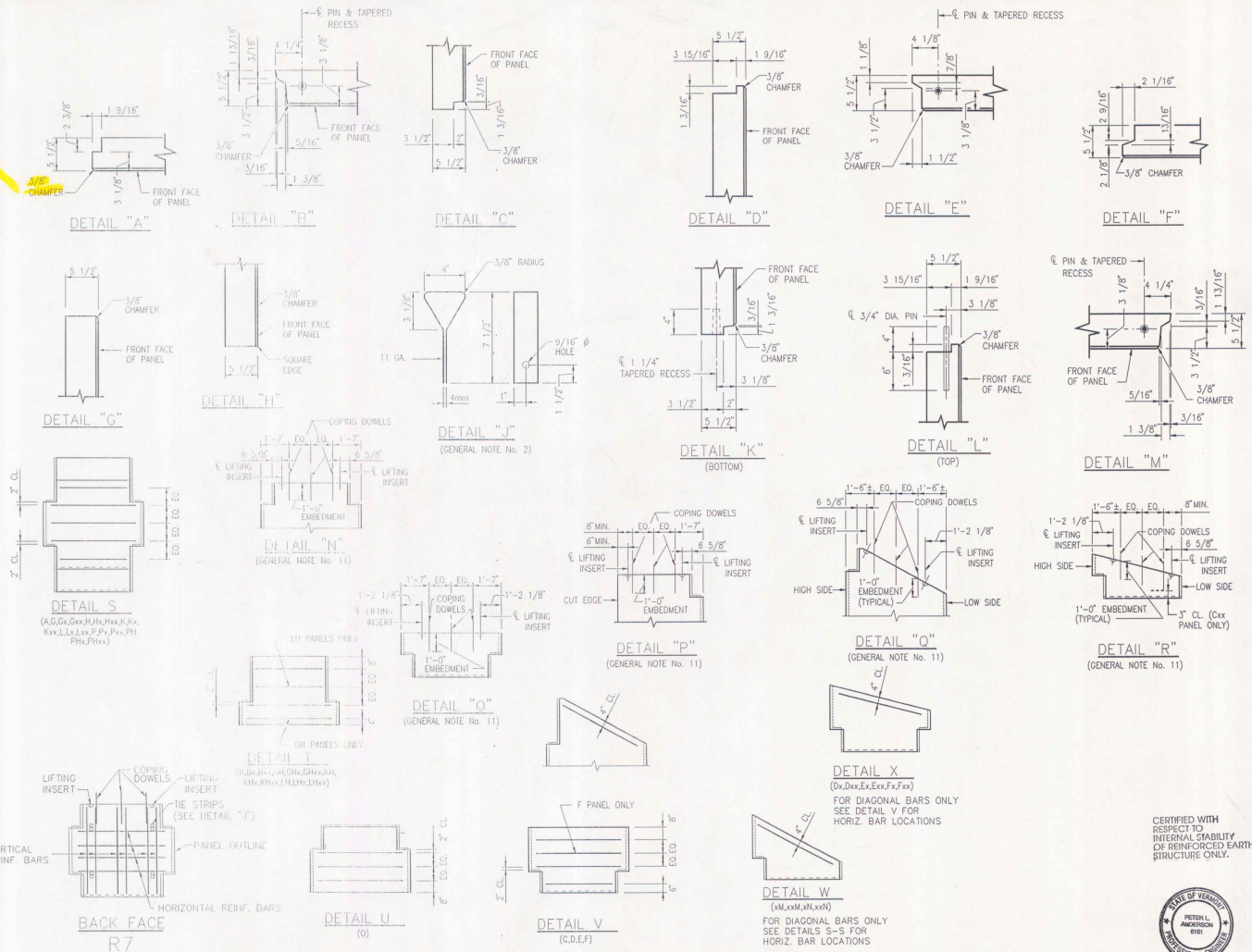
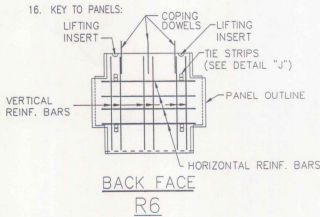

NOTES: 1. DETAILS N - X SHOWN BACKFACE
2. DETAILS S-V SHOW ALL POSSIBLE HORIZONTAL REBARS.
SEE INDIVIDUAL PANEL DRAWING FOR REBAR REQUIREMENTS.

This drawing contains information proprietary to The Reinforced Earth Company, and is being furnished for the use of STATE OF VERMONT AGENCY OF TRANS. only in connection with this project, and the information contained herein is not to be transmitted to any other organization unless specifically authorized in writing by The Reinforced Earth Company. The Reinforced Earth Company is exclusive licensee in the United States under patents issued to Henri Vidal, and the furnishing of this drawing does not constitute an expressed or implied license under the Vidal patents.

The design contained on these drawings is based on information provided by the owner. On the basis of this information, The Reinforced Earth Company has designed, and is responsible for the internal stability of the structure only. External stability, including foundation and slope stability, is the responsibility of the owner.

The Reinforced Earth Company 5614 Westwood Center Drive Suite 1100 Vienna, Virginia 22182 (703) 821-1179		PROJECT ENGR: SRS CHECKED BY: KT ENGR. MANAGER	PROJECT NAME: WALLINGFORD LOCATION: U.S. ROUTE 7 OVER RAILROAD TOWN OF WALLINGFORD, VERMONT OWNER: VERMONT AGENCY OF TRANSPORTATION DRAWING COVERS: GENERAL NOTES AND STANDARD SHOP DRAWING DETAILS	DATE: 1/16/96 CONTRACT NO.: 5692 DRAWING NO.: 1 OF 11 SCALE: NONE
---	--	--	--	--

BR50137(13)
 Peter J. Anderson
 1/16/96



Rect 26-76