

NOTE:  
JOINTS IN COPING SHALL BE AT 2 PANEL INTERVALS AND COINCIDE APPROXIMATELY WITH PANEL JOINTS. REINFORCING STEEL SHALL BE STOPPED 2" SHORT OF EITHER SIDE OF THE CONSTRUCTION AND EXPANSION JOINTS. FOR EXPANSION JOINT LOCATIONS SEE MSE WALL ELEVATIONS.

C.I.P. COPING (3 DOWELS)

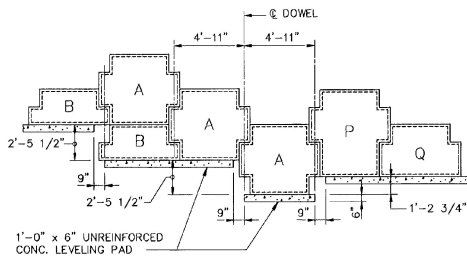

5 TYPICAL LEVELING PAD STEP DETAIL

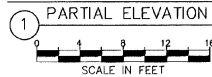
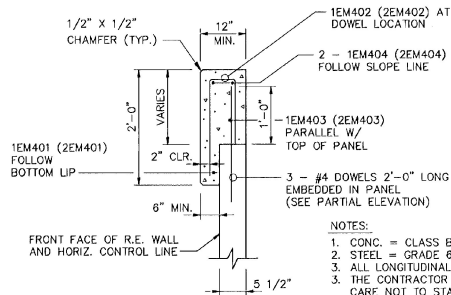
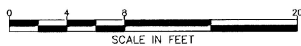

2 C.I.P. CONC. COPING DETAIL

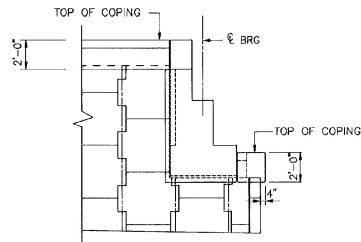

6 PARTIAL ELEVATION CONNECTION AT BRIDGE ABUT.

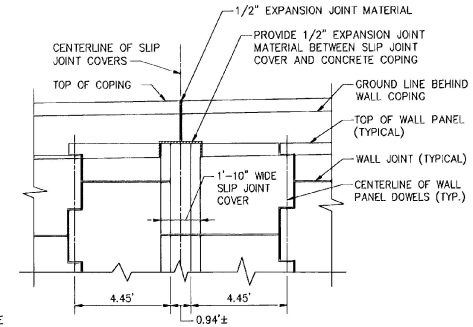
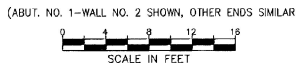

3 PARTIAL ELEVATION - BACK FACE COPING OVER SLIP JOINT COVERS

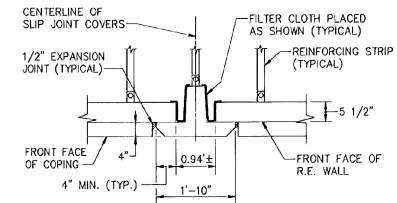

4 SLIP JOINT COVER DETAIL

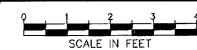

STATE OF VERMONT  
AGENCY OF TRANSPORTATION

Town Of	WALLINGFORD	Bridge No.	80
Highway No.	U.S. ROUTE 7	Log Sta.	
		Surv. Sta.	
U.S. ROUTE 7 OVER RAILROAD			
MSE WALLS - DETAILS			
Designed By	LJW	Drawn By	REC
Checked By	AJP	Date	10/94
		Bridge Design Supervisor	EMM
		Date	4/95
PROJECT	WALLINGFORD	PROJECT NO.	BRS 0137 (13)
I.G.C. Info.		Bridge Sheet No.	BR230
		Sheet	90 of 113



BARNES AND JARNIS, INC.  
CONSULTING ENGINEERS  
25 STUART STREET, 6TH FL.  
BOSTON, MASSACHUSETTS