

NOTE :
ELEVATIONS ARE FINISHED GRADE ELEVATIONS.

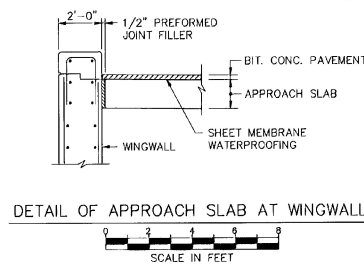

BARNES AND JARNIS, INC.
CONSULTING ENGINEERS
25 STUART STREET, 6TH FL.
BOSTON, MASSACHUSETTS

STATE OF VERMONT AGENCY OF TRANSPORTATION			
Town Of	WALLINGFORD	Bridge No.	80
Highway No.	U.S. ROUTE 7	Log Sta.	
		Surv. Sta.	
U.S. ROUTE 7 OVER RAILROAD APPROACH SLAB DETAILS			
Designed By	GRI	Drawn By	RJL/JNC
Checked By	EMM	Bridge Design Supervisor	EMM
Date	4/95	Date	4/95
PROJECT	WALLINGFORD	PROJECT NO.	BRS 0137 (13)
I.G.C. Info.			
Bridge Sheet No.	BR220	Sheet	80 of 113