

100mm white line
 ML 0+765.900 - 0+828.000 Lt.
 ML 0+757.300 - TH#56 10+036.700 Rt.
 TH 56 10+005.000 - 10+036.700 Lt.
 ML 0+807.000 - 0+828.000 Rt.
 45.3 m As Shown on Sheet 50

100mm double yellow line
 ML 0+766.800 - 0+795.5000 CL.
 ML 0+807.500 - 0+828.000 CL.
 TH 56 10+006.100 - 10+036.700 CL.

600mm stop bar
 TH 56 10+006.500, 5.80 m left
 Durable Letter or Symbol
 Sta. 10+009.2 Lt. (S.T.O.P.)

Vt. Rte. 346
 To Petersburg, NY

ML POT 0+801.433=
 TH 56 POT 10+000.000
 Askew 90°-00'-00'' Rt.

TH 56 Curve Data
 Delta: 48°20'04.1'' Lt.
 Radius: 27.858
 Tangent: 12.501
 Length: 23.501
 External: 2.676

TH 56
 STA. 10+035.000
 END APPROACH

Note - Stop Ahead sign to be located approximately 76 meter from painted STOP markings. Final placement to be determined by the Resident Engineer.

LEGEND
 N = NEW
 R = REMOVE

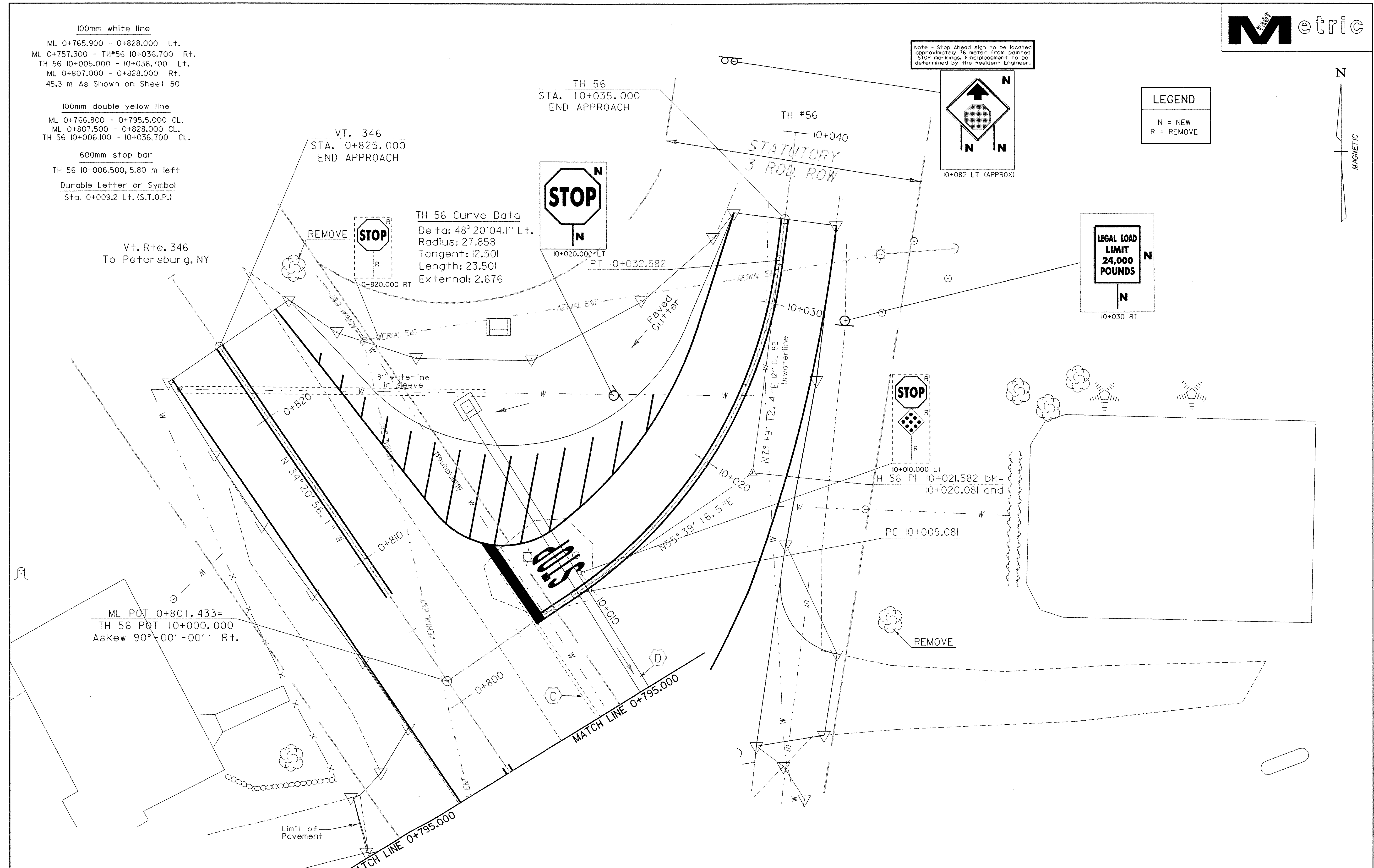
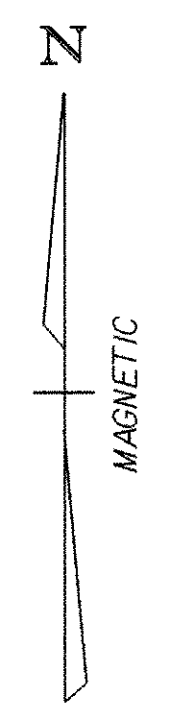

LEGAL LOAD
 LIMIT
24,000
 POUNDS

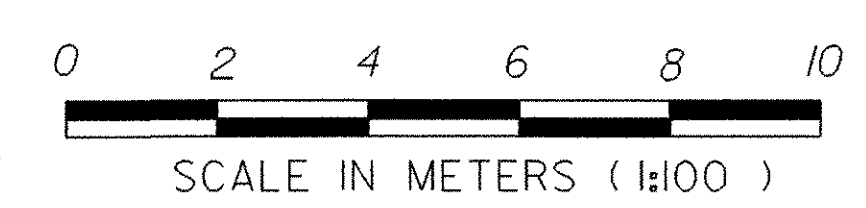

SIGN SHEET #2	
PROJECT NAME:	POWNAI
PROJECT NUMBER:	STP RS 0107(8)
FILE NAME:	/84c028/str/sc028bdr.dgn
PROJECT LEADER:	W. SYMONDS
DESIGNED BY:	G. SHANGRAW
sb254sg2.i	
PLOT DATE:	10-MAY-2007
DRAWN BY:	G. SHANGRAW
CHECKED BY:	T. FILLBACH
	SHEET 49 OF 65