

SEE SHEET 2 FOR INDEX OF SHEETS  
& LIST OF STANDARDS

# STATE OF VERMONT AGENCY OF TRANSPORTATION

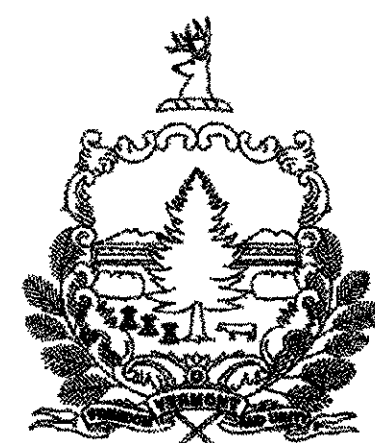

## PROPOSED IMPROVEMENT BRIDGE PROJECT TOWN OF POWNAL COUNTY OF BENNINGTON VT. ROUTE 346, MAJOR COLLECTOR

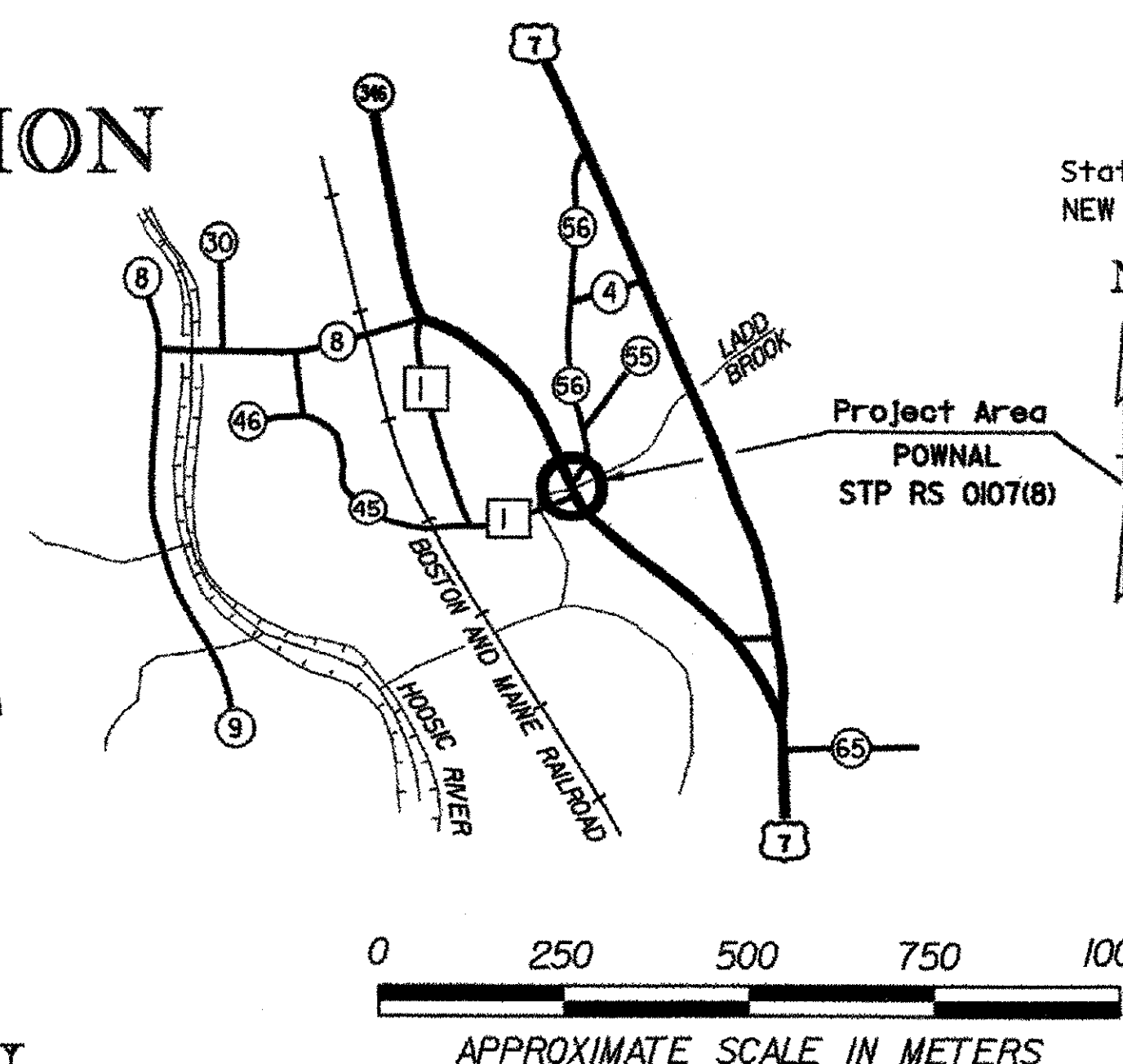

**Project Location:** Beginning at a point on Vt. Route 346, approximately 0.338 km Northwesterly of the intersection of Vt. Route 346 and U.S. Route 7, and extending Northwesterly along Vt. Route 346 for 0.026 km.

**Project Description:** Work to be performed under this project consists of replacement of bridge #1 on Vt. Route 346 and all necessary roadway approach work.

**Length of Project:** 15.00m

RECORD PLANS	
CONTRACTOR:	Renaud Brothers, Inc. - Vernon VT
RESIDENT ENGINEER:	R. Lemaire
CONSTRUCTION BEGAN:	AUGUST 6, 2007
CONSTRUCTION COMPLETE:	November 13, 2007
RECORD PLANS BY:	R. Lemaire
I HEREBY CERTIFY THAT ALL THE CONSTRUCTION REQUIRED BY THIS SET OF DRAWINGS HAS BEEN ACCOMPLISHED AS INDICATED HEREIN.	
BY:	<i>[Signature]</i> RESIDENT ENGINEER
DATE:	01/30/08
NOTE: Any further information concerning final quantities, amounts or other details relative to this project may be found at Central Files in the electronic archives.	

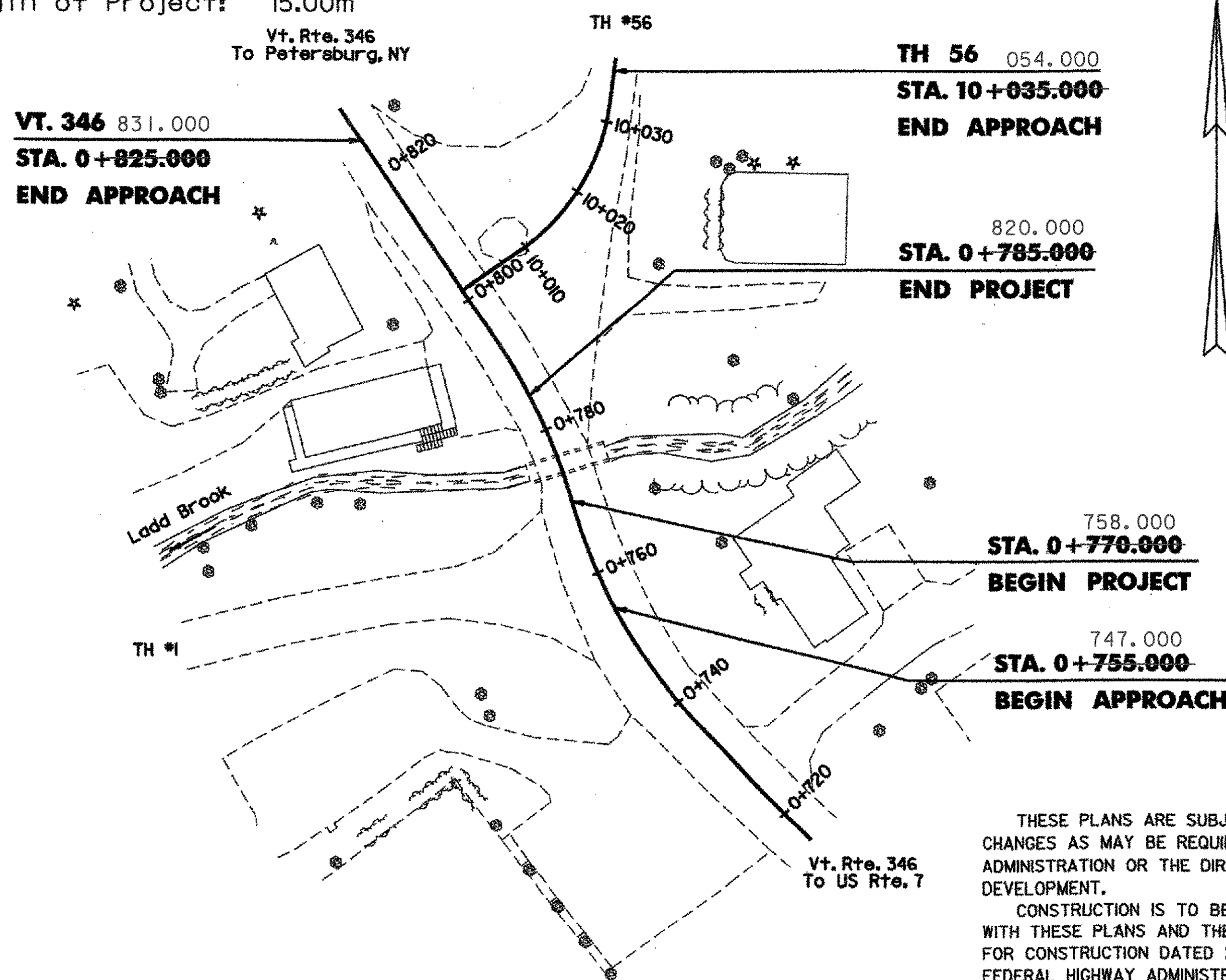

CONVENTIONAL SYMBOLS	
COUNTY LINE	
TOWN LINE	
LIMITS OF ACCESS	
POINT OF ACCESS	
FENCE LINE	
STONE WALL	
TRAVELED WAY	
GUARD RAIL	
RAILROAD	
SURVEY LINE	
CULVERT	
POWER POLE	
TELEPHONE POLE	
TREES	
CONTROL OF ACCESS	
PROPERTY LINE	
R.O.W. TAKING LINE	
SLOPE RIGHTS	
TOP OF CUT	
TOE OF SLOPE	

SURVEYED BY : L. ORVIS  
SURVEYED DATE : SEPT. 22, 1998

DATUM  
VERTICAL NAVD 88  
HORIZONTAL NAD 83 (1992)

THESE PLANS ARE SUBJECT TO SUCH ENGINEERING CHANGES AS MAY BE REQUIRED BY THE FEDERAL HIGHWAY ADMINISTRATION OR THE DIRECTOR OF PROGRAM DEVELOPMENT.

CONSTRUCTION IS TO BE CARRIED ON IN ACCORDANCE WITH THESE PLANS AND THE STANDARD SPECIFICATIONS FOR CONSTRUCTION DATED 2006, AS APPROVED BY THE FEDERAL HIGHWAY ADMINISTRATION ON JUNE 15, 2006 FOR USE ON THIS PROJECT, INCLUDING ALL SUBSEQUENT REVISIONS AND SUCH REVISED SPECIFICATIONS AND SPECIAL PROVISIONS AS ARE INCORPORATED IN THESE PLANS.

784c028/str/sc028t1.dgn PLOT DATE: 26-APR-2007 sc028t1.l

**Metric**  
UNLESS NOTED OTHERWISE  
STATIONS ARE IN KILOMETERS  
ELEVATIONS ARE IN METERS  
DIMENSIONS ARE IN MILLIMETERS

DIRECTOR OF PROGRAM DEVELOPMENT	<i>[Signature]</i>	DATE	1/24/08
PROJECT MANAGER :	WAYNE SYMONDS		
PROJECT NAME :	POWNAL		
PROJECT NUMBER :	STP RS 0107(8)		
SHEET 1 OF 65 SHEETS			