

DETOUR PROFILE

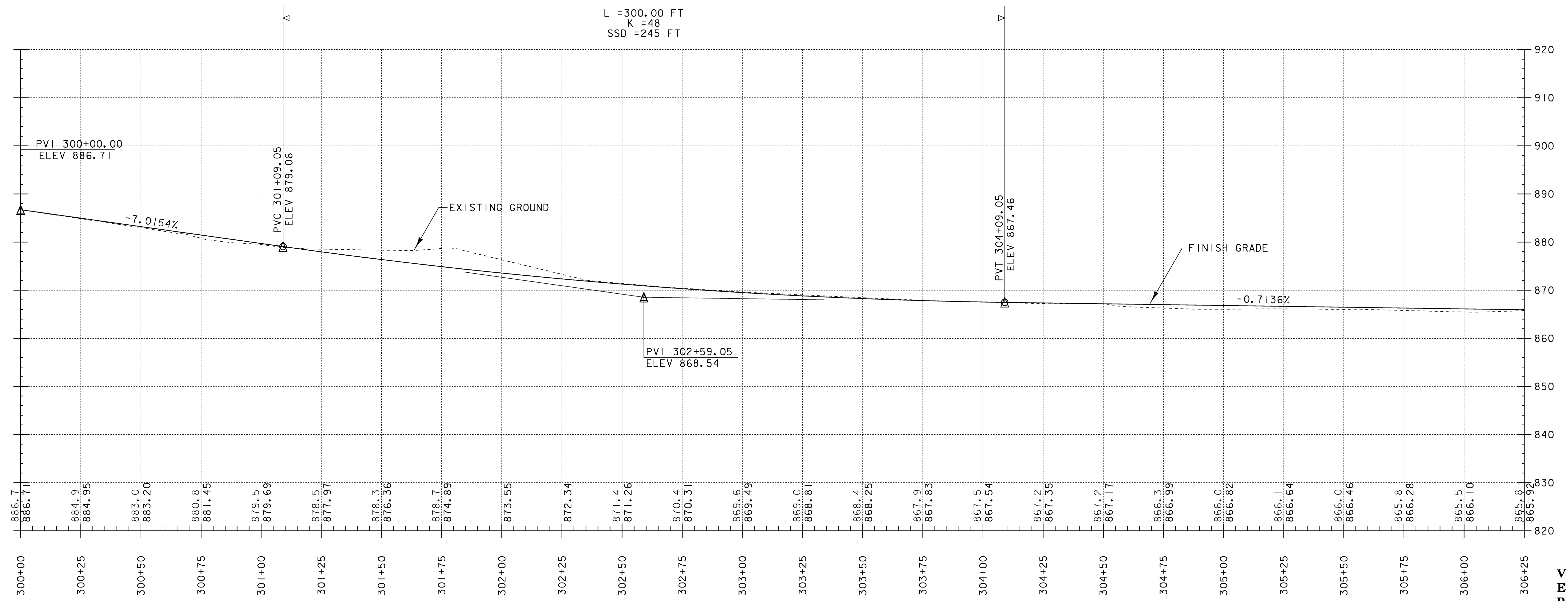

THE GRADES SHOWN TO THE NEAREST TENTH ARE THE ORIGINAL GROUND ELEVATIONS ALONG THE PROPOSED ALIGNMENT. THE GRADES SHOWN TO THE NEAREST HUNDREDTH ARE THE PROPOSED GRADES FOR THE NEW ALIGNMENT.

PEDESTRIAN HAND RAILING NOTES

PEDESTRIAN HAND RAILING SYSTEM SHALL CONFORM TO THE REQUIREMENTS OF SPECIAL PROVISION SECTION 900.640 (PEDESTRIAN HAND RAILING)

SEE GENERAL NOTE # 6 AND SHEET 23 FOR PLACEMENT DETAILS.

PEDESTRIAN HAND RAILING IS TO BE PLACED FROM DETOUR STA. 305+25 LT TO STA. 305+65 LT AND IS TO BE PAID USING ITEM 900.640 SPECIAL PROVISION (PEDESTRIAN HAND RAILING).

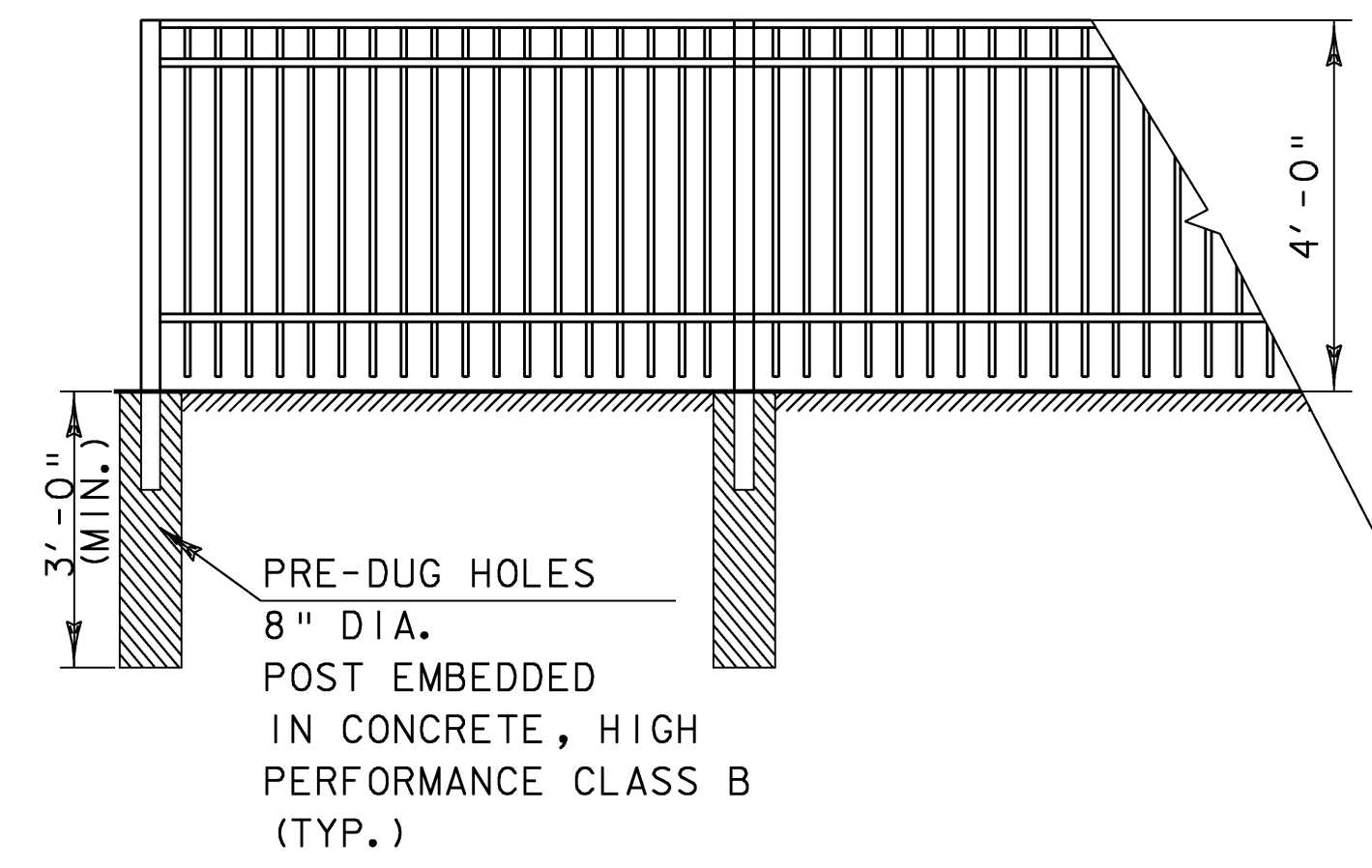

PEDESTRIAN HAND RAILING ELEVATION

SCALE 1/2" = 1'-0"

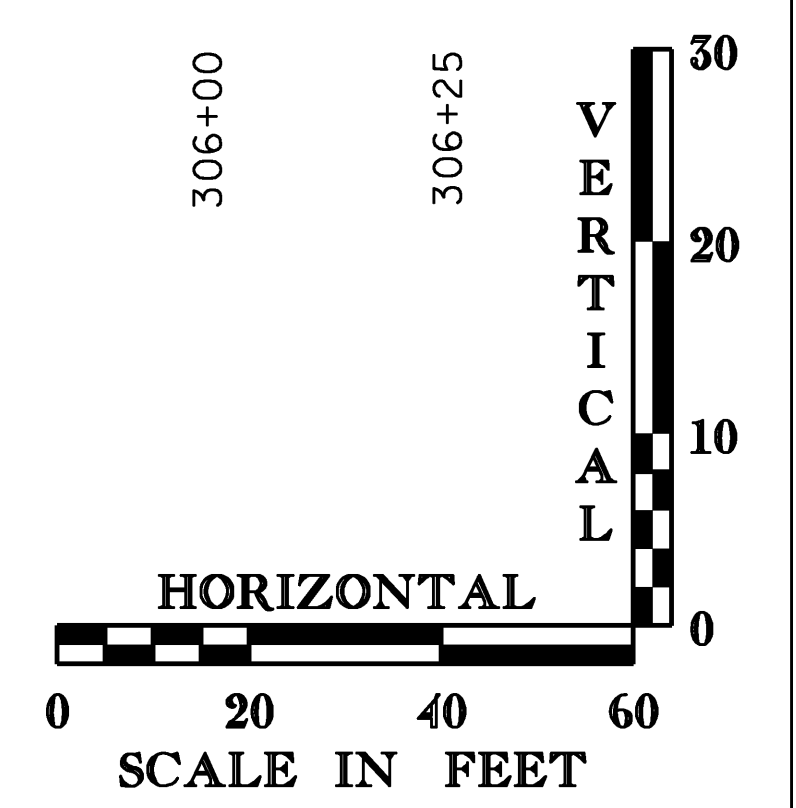

DETOUR PROFILE AND PEDESTRIAN HAND RAILING DETAILS

PROJECT NAME:	WILLIAMSTOWN	PLOT DATE:	07-APR-2008
PROJECT NUMBER:	BRS 0204(4)	DRAWN BY:	EVANS-MONGEON
FILE NAME:	83ell/structures/sellxs.dgn	DESIGNED BY:	STANLEY
		CHECKED BY:	EVANS-MONGEON
		SHEET	69 OF 108