

MATCH LINE EXISTING CONDITIONS PLAN SHEET 2 STA 222+00

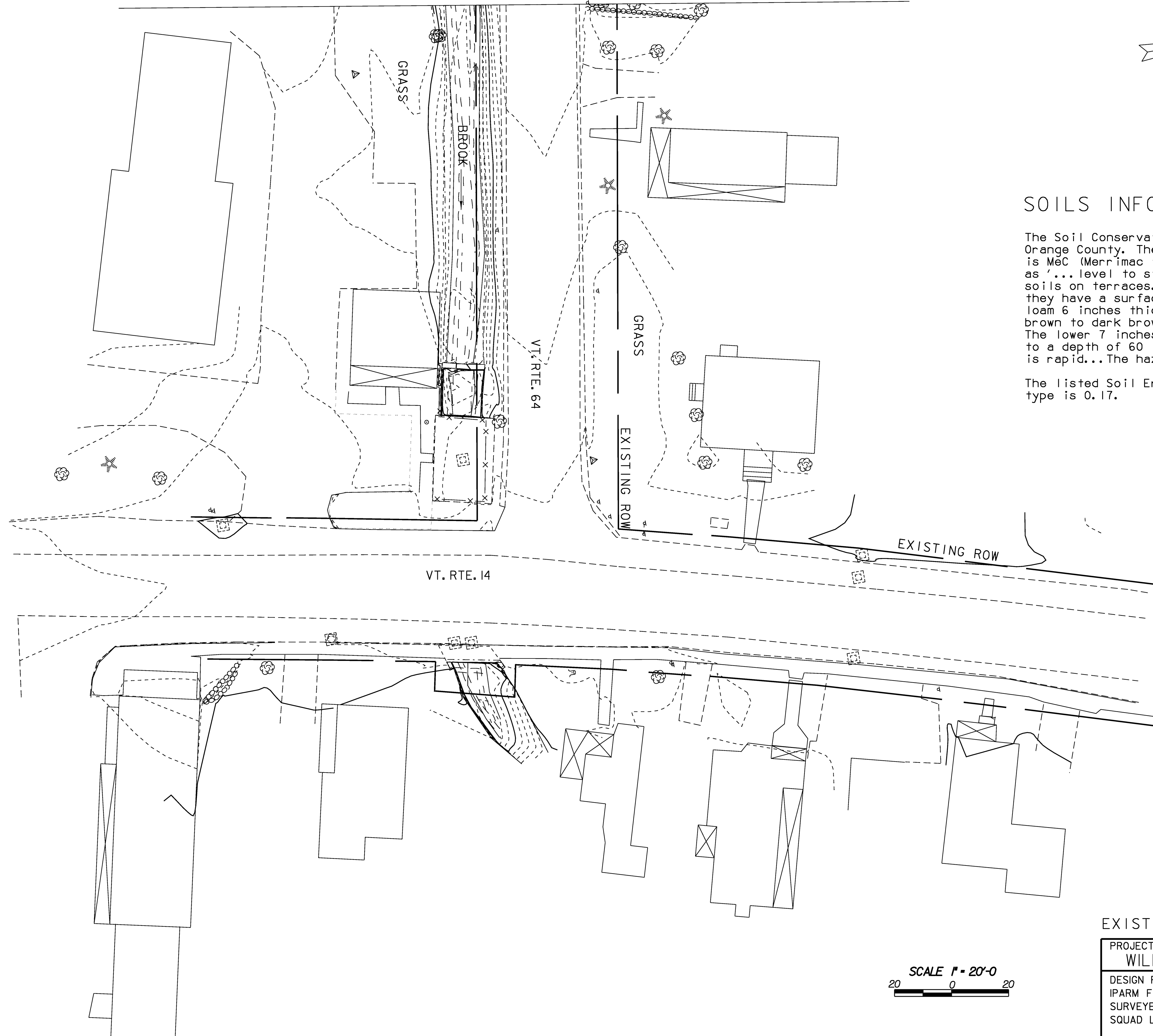
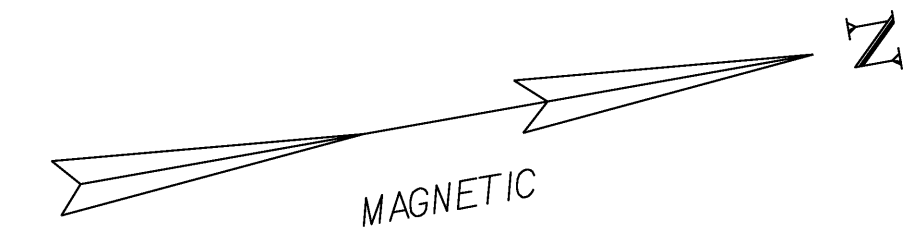

SOILS INFORMATION:

The Soil Conservation Service has mapped the soils throughout Orange County. The soil type identified for this project site is MeC (Merrimac fine sandy loam). This soil type is described as "...level to steep, deep, somewhat excessively drained soils on terraces. In representative profile in a hayfield... they have a surface layer of very dark grayish brown fine sandy loam 6 inches thick. The upper 10 inches of the subsoil is brown to dark brown grading to yellowish brown fine sandy loam. The lower 7 inches is brown sandy loam. The underlying material to a depth of 60 inches is olive gray gravelly sand....Permeability is rapid...The hazard of erosion is moderate. Runoff is medium.

The listed Soil Erodibility Coefficient (K-value) for this soil type is 0.17.

VT. RTE. 14

VT. RTE. 64

EXISTING ROW

EXISTING CONDITIONS PLAN SHEET 3

DATUM
 VERTICAL NGVD 1929
 HORIZONTAL ASSUMED

SCALE 1" = 20'-0"
 20 0 20

PROJECT: WILLIAMSTOWN	PROJECT NO.: BRS 0204(4)
DESIGN FILE NAME: str2/83ell/dellero.dgn	PLOT DATE: 07-APR-2008
IPARM FILE NAME: selllex3	SURVEY DATE: 9/89
SURVEYED BY: GILMAN	DRAWN BY: U. STANLEY
SQUAD LEADER: M. EVANS-MONGEON	SHEET: 29 OF 108