

| EARTH | |
|-------|-------|
| 21.47 | 494.7 |
| 21.47 | 494.0 |
| 25.0 | 493.4 |
| 25.0 | 493.4 |
| 28.0 | 493.9 |
| 28.0 | 494.7 |
| 28.0 | 494.7 |
| 27.0 | 493.9 |
| 25.0 | 493.9 |
| 21.47 | 494.7 |
| 4.27 | |

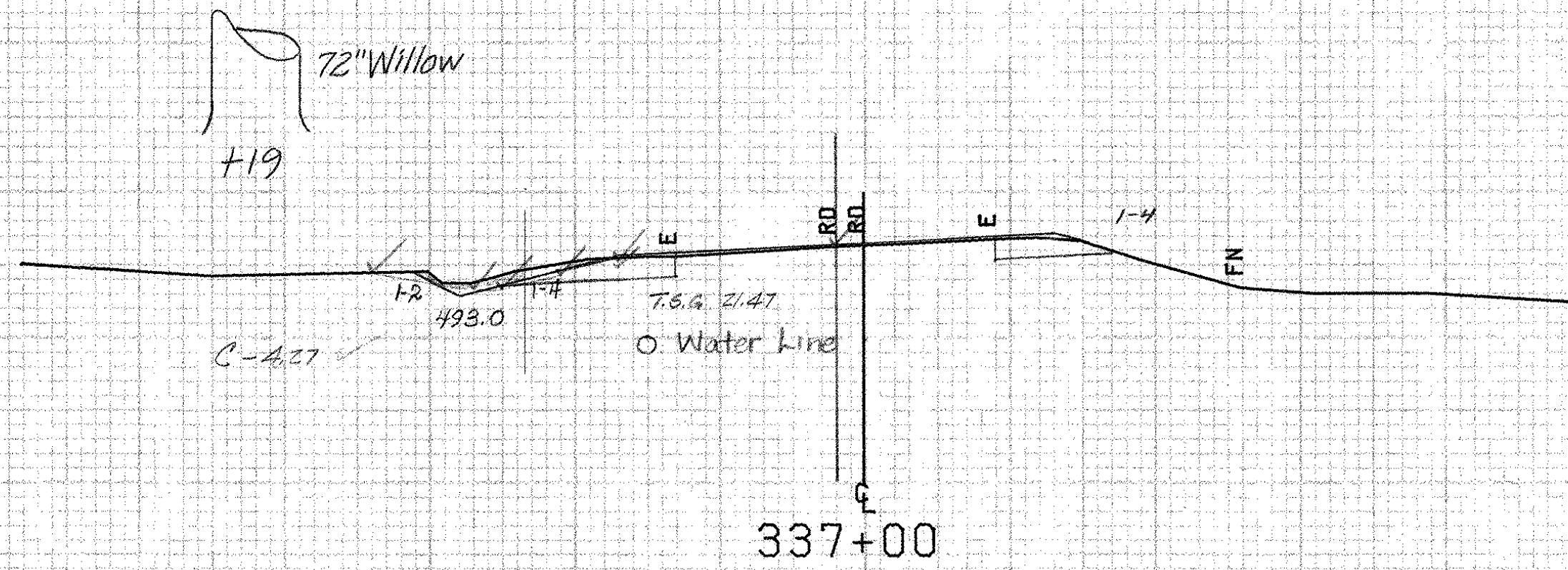

490

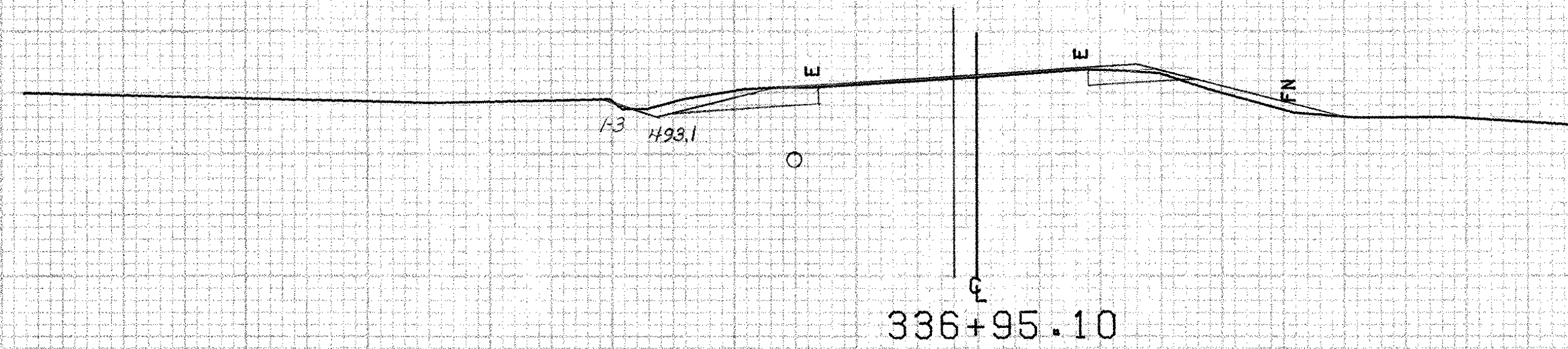

490

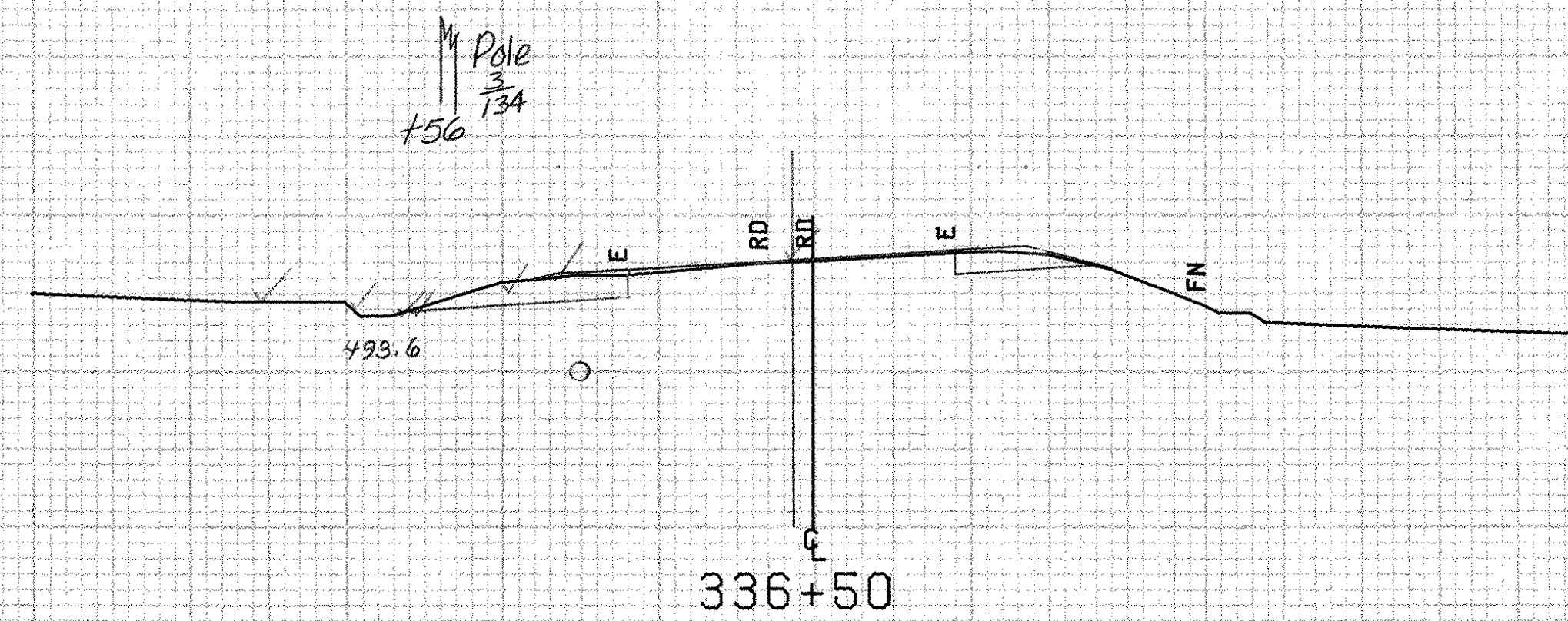

490

336+85
End Special Ditch w/
Erosion Matting
(Common Excavation)

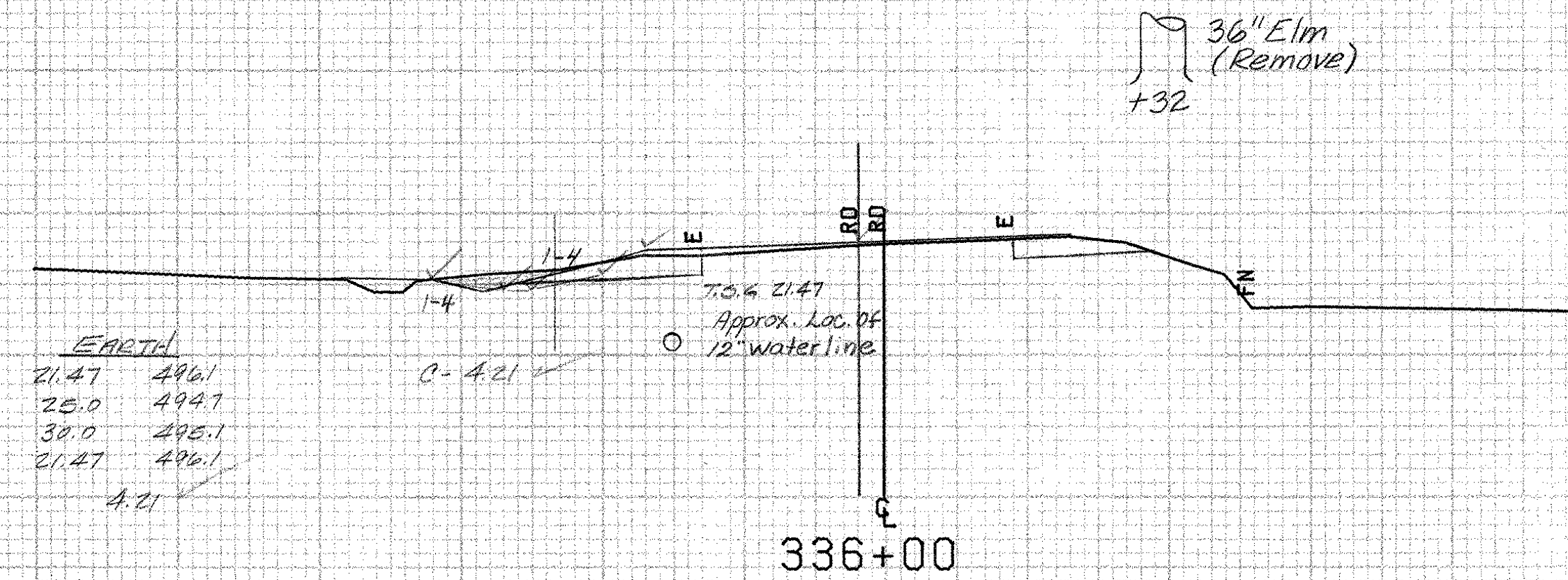

490

| EARTH | |
|-------|-------|
| 21.47 | 496.1 |
| 25.0 | 494.7 |
| 38.0 | 495.1 |
| 21.47 | 496.1 |
| 4.71 | |

BRIDPORT-ADDISON MM 6.30 ~MM 0.32

| | | | |
|--------------|---------------------------|-------------|------------|
| FROM STA. | 336+00 | TO STA. | 337+00 |
| PROJECT NAME | SHOREHAM-BRIDPORT-ADDISON | | |
| NO. | F017-1(2) | PLOTTED | 02/28/84 |
| SURVEYED BY | FANTONI | FEBRUARY 84 | |
| SHEET | 382 OF 420 SHEETS | SHEET | 382 OF 477 |

SCALE 1" = 10 FEET

cuts w/ Sta 336+90