

177+00 RT. Construct Drive (Paved) (40' wide)

177+00 Lt. End Special Ditch w/ Stone Fill, Type I (Begins @ 175+90 Lt.)

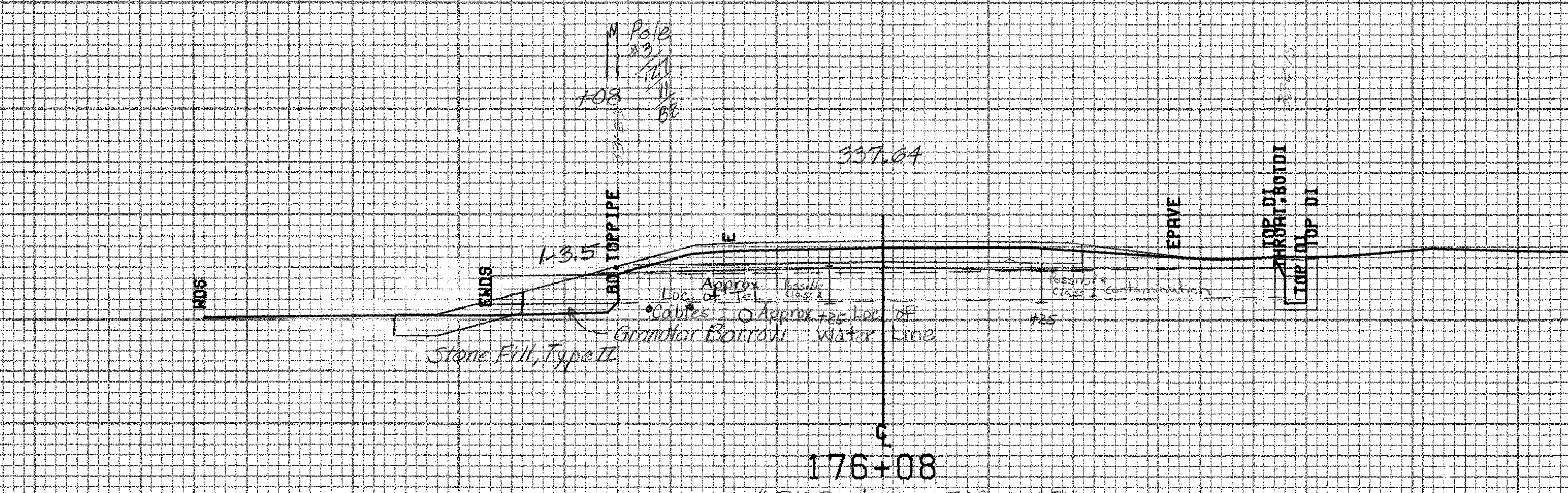
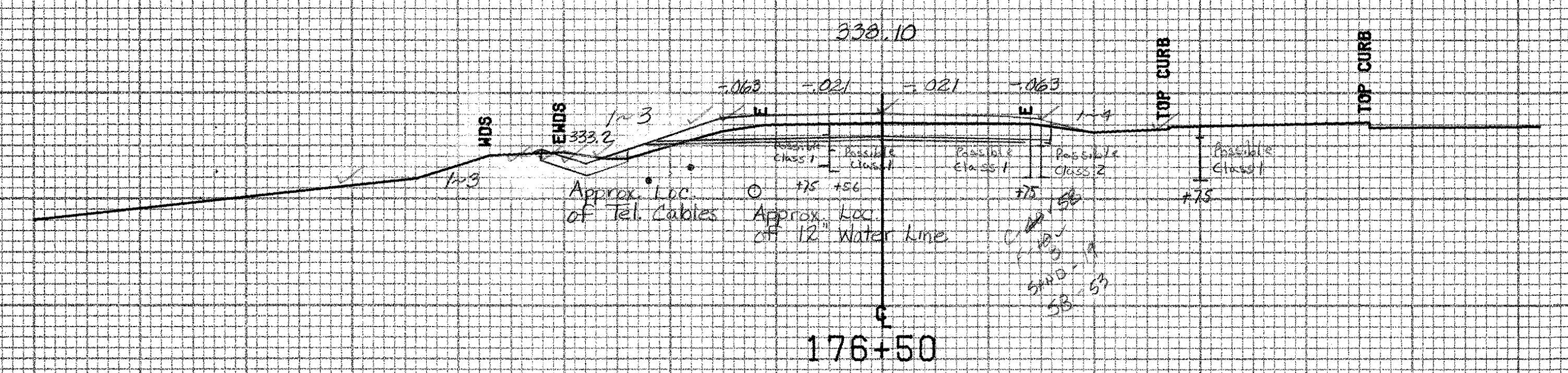

30" RCP Askew 58" O.D. Retain and Extend Outlet w/ New 30" x 12" RCP (CL III) & Type II Stone Bed

BRIDPORT MM 2.94 ~ MM 3.54

FROM STA.	176+08	TO STA.	177+50
PROJECT NAME	SHOREHAM-BRIDPORT-ADDISON MAIN		
NO.	F017-1(2)	PLOTTED	04/11/85
SURVEYED BY	BUSHEY	FEB 1985	
SHEET	324 OF 480 SHEETS	Sheet	324 OF 477

SCALE 1" = 10 FEET