

FARIN

18.21	302.3
19.21	302.0
21.0	301.0
25.0	300.0
18.21	302.3

300

162+50

162+02 ~ 163+30 RT
 8" VCP extend w/ 12" x 12" CSP (0.064) & NEW 12" CSP ELBOW (0.6A) 20° @ Outlet

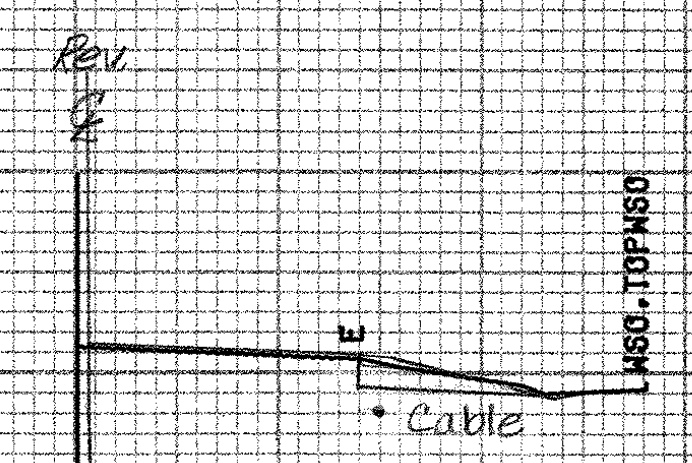

300

162+13
MSO RT.

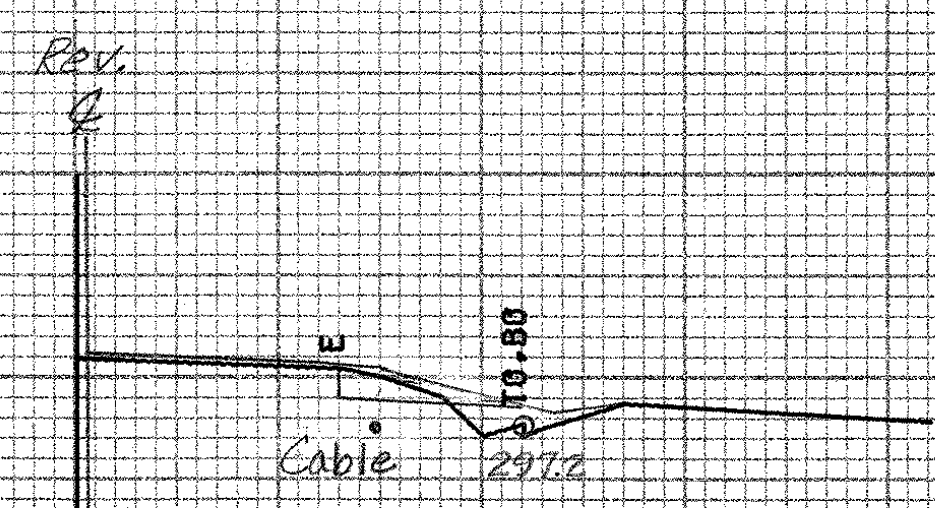

300

162+02
8" VCP OUTLET RT.

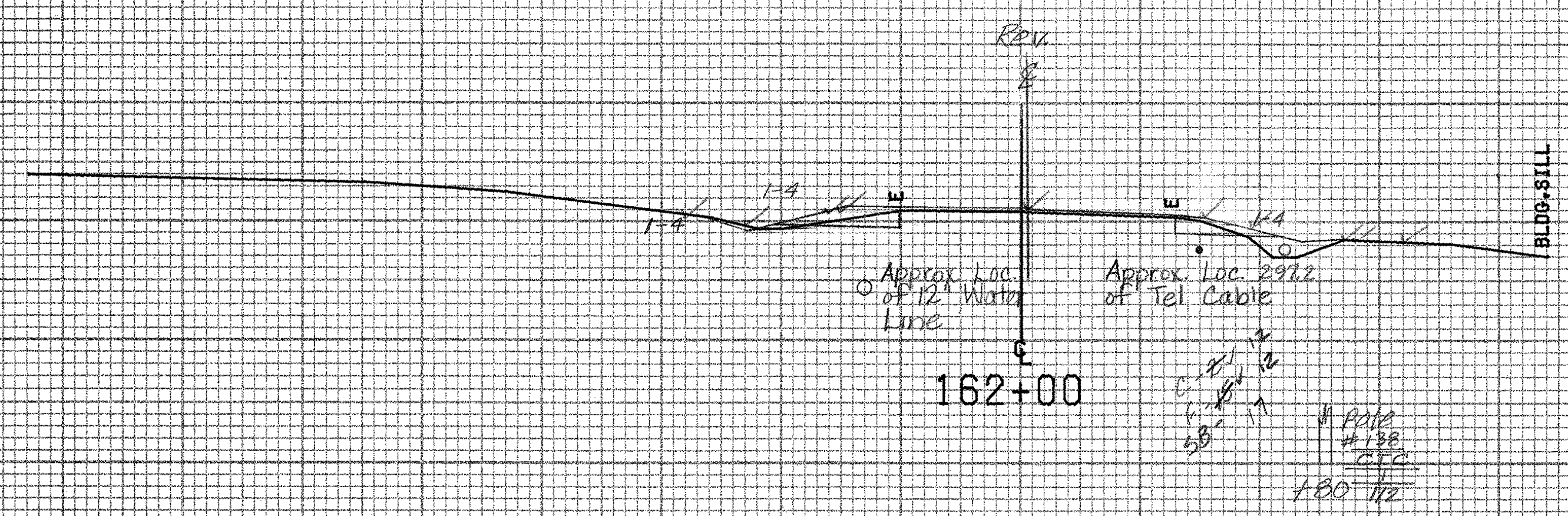

300

162+00

BRIDPORT MM 2.94 ~ MM 3.54

FROM STA.	162+00	TO STA.	162+50
PROJECT NAME	SHOREHAM-BRIDPORT-ADDISON MAIN		
NO.	F017-1(2)	PLOTTED	04/11/85
SURVEYED BY	BUSHEY	FEB	1985
SHEET	310 OF 420	SHEETS	SHEET 310 OF 477

SCALE 1" = 10 FEET