

DATE PLOTTED: June 24, 2013

S:\03\VERMONT\1022\Gch\Twp-13081 - 25-Warren, VT over Mad River Drawings\1022_AS-BUILT_C-24-13.dwg

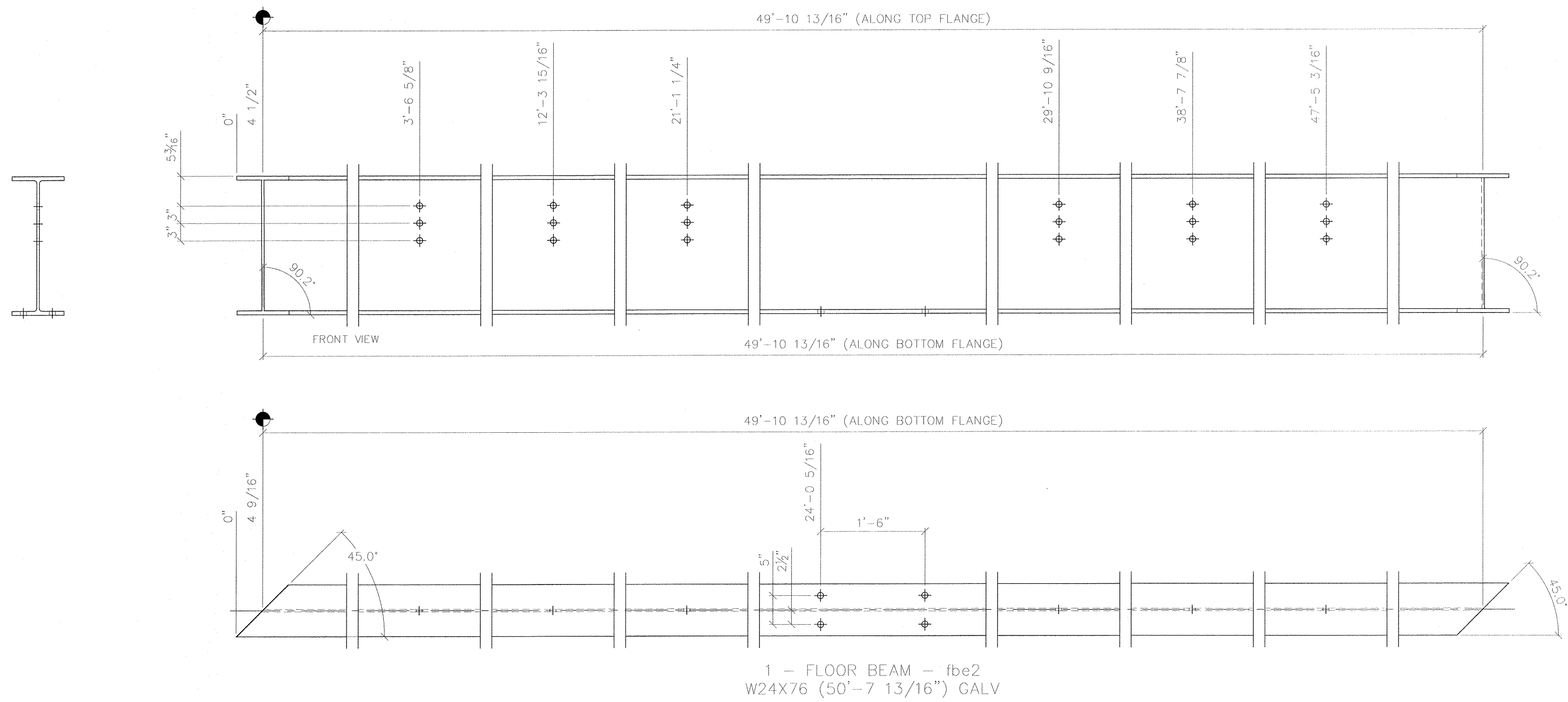

1/8" Ø HOLES UNO

RECORD DWGS
AS FABRICATED
6/24/13

SYMBOLS & ABBREVIATIONS

ES: EACH SIDE	NS: NEAR SIDE
EQ: EQUAL	FS: FAR SIDE
CL: CENTERLINE	WP: WORK POINT
REF: REFERENCE	GA: GAUGE
CHK: CHECK	ID: INSIDE DIAMETER
O/O: OUT TO OUT	OD: OUTSIDE DIAMETER
C/C: CENTER TO CENTER	BRG: BEARING
F/F: FACE TO FACE	TYP: TYPICAL
DIA: DIAMETER	UNO: UNLESS NOTED OTHERWISE
R: RADIUS	ABUT: ABUTMENT
	T&B: TOP & BOTTOM

DIST. BY: **CONTECH** CONSTRUCTION PRODUCTS INC.
FAB. BY: **U.S. BRIDGE** BRIDGING AMERICA SINCE 1936

SUBMITTAL LOG	DATE	NO.	DATE	REVISIONS:	BY:
INITIAL SUBMITTAL	12/18/12	▲	5/15/13	FLOOR BEAM END PLATES WAS 1" THK	TLB
RESUBMITTAL NO. 2	2/5/13	▲	5/15/13	ADDED 2" DIA. RAT HOLES IN fb1 & fb9	TLB
CUSTOMER APPROVAL	2/13/13	▲	5/15/13	CHANGED WELD WAS 3/16" ALL AROUND	TLB
SHOP REVIEW	-	▲	5/15/13	CHANGED BOLT PATTERN	TLB
PRE FAB MTG	-	▲	5/15/13	WAS 2" EDGE DISTANCE	TLB
APPROVED FOR FAB	2/28/13	▲	6/3/13	DIMENSIONAL ERRORS	TLB

00000001.jpg

TOWN OF WARREN, VT
COUNTY OF WASHINGTON
BRIDGE NO.173 REPLACEMENT
WARREN, VT

DESIGN: SAF	DRAW: TLB	REVIEW: SAF/RLI	CHECK: CJG	SHEET: 9n	TOTAL: 58
SHOP DETAILS		PROFILES		USB JOB#	
				51622	