

DATE PLOTTED June 24, 2013

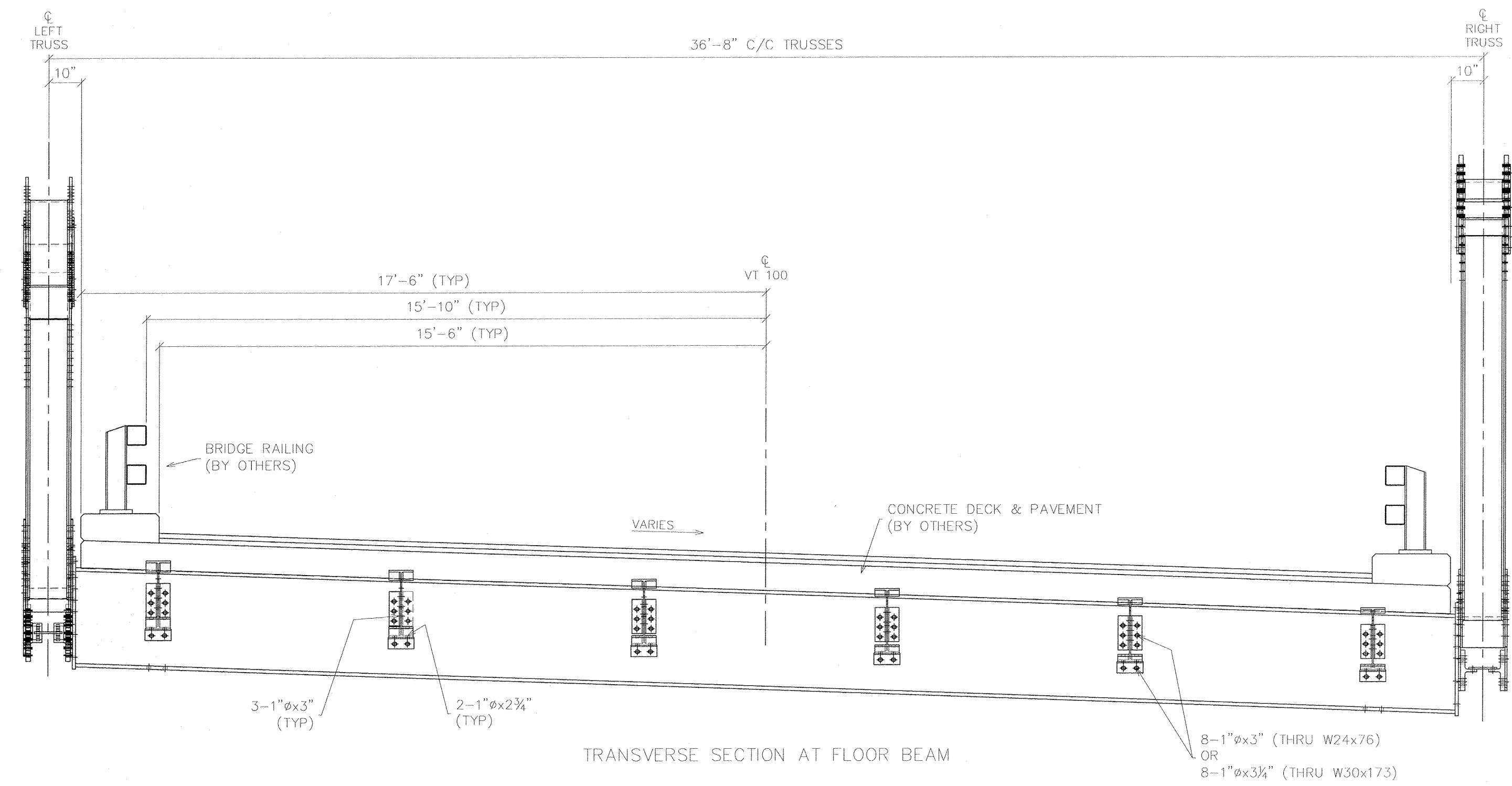

NOTE: ALL BOLTS REQUIRE (1) FLAT WASHER, (1) DTI WASHER, AND (1) NUT. ALL BOLTS ARE A325-1 UNO.

RECORD DWGS
AS FABRICATED
6/24/13

S:\08\VERMONT\1622\04\Drawings\1622 AS-BUILT 6-24-13.dwg

SYMBOLS & ABBREVIATIONS

ES: EACH SIDE	NS: NEAR SIDE
FS: FAR SIDE	FS: FAR SIDE
EQ: EQUAL	WP: WORK POINT
CL: CENTERLINE	GA: GAUGE
REF: REFERENCE	ID: INSIDE DIAMETER
CHK: CHECK	OD: OUTSIDE DIAMETER
O/O: OUT TO OUT	BRG: BEARING
C/C: CENTER TO CENTER	TYP: TYPICAL
F/F: FACE TO FACE	UNO: UNLESS NOTED OTHERWISE
DA: DIAMETER	ABUT: ABUTMENT
R: RADIUS	T&B: TOP & BOTTOM

DIST. BY: **CONTECH** CONSTRUCTION PRODUCTS INC.
FAB. BY: **U.S. BRIDGE** BRIDGING AMERICA SINCE 1936

SUBMITTAL LOG	DATE	NO.	DATE	REVISIONS	BY:
INITIAL SUBMITTAL	12/18/12	1	5/15/13	FLOOR BEAM END PLATES WAS 1" THK	TLB
RESUBMITTAL NO. 2	2/5/13	2	5/15/13	ADDED 2" DIA. RAT HOLES IN fb1 & fb9	TLB
CUSTOMER APPROVAL	2/13/13	3	5/15/13	CHANGED WELD WAS 3/8" ALL AROUND	TLB
SHOP REVIEW	-	4	5/15/13	CHANGED BOLT PATTERN	TLB
PRE FAB MTG	-	5	5/15/13	WAS 2" EDGE DISTANCE	TLB
APPROVED FOR FAB	2/28/13	6	6/3/13	DIMENSIONAL ERRORS	TLB

00000001.jpg	TOWN OF WARREN, VT COUNTY OF WASHINGTON BRIDGE NO.173 REPLACEMENT WARREN, VT	ITEM NO.: PROJECT NO.: BRF 013-4 (14) REFERENCE NO.: BRIDGE NO.: 173 STRUCTURAL FILE NO.:
--------------	---	---

DESIGN: SAF	DRAW: TLB	REVIEW: SAF/RLI	CHECK: CJG	SHEET: 3b	TOTAL: 58
CONSTRUCTION PLANS			TRANSVERSE SECTION		
USB JOB# 51622					