

CROSSFRAME - MK. CF7

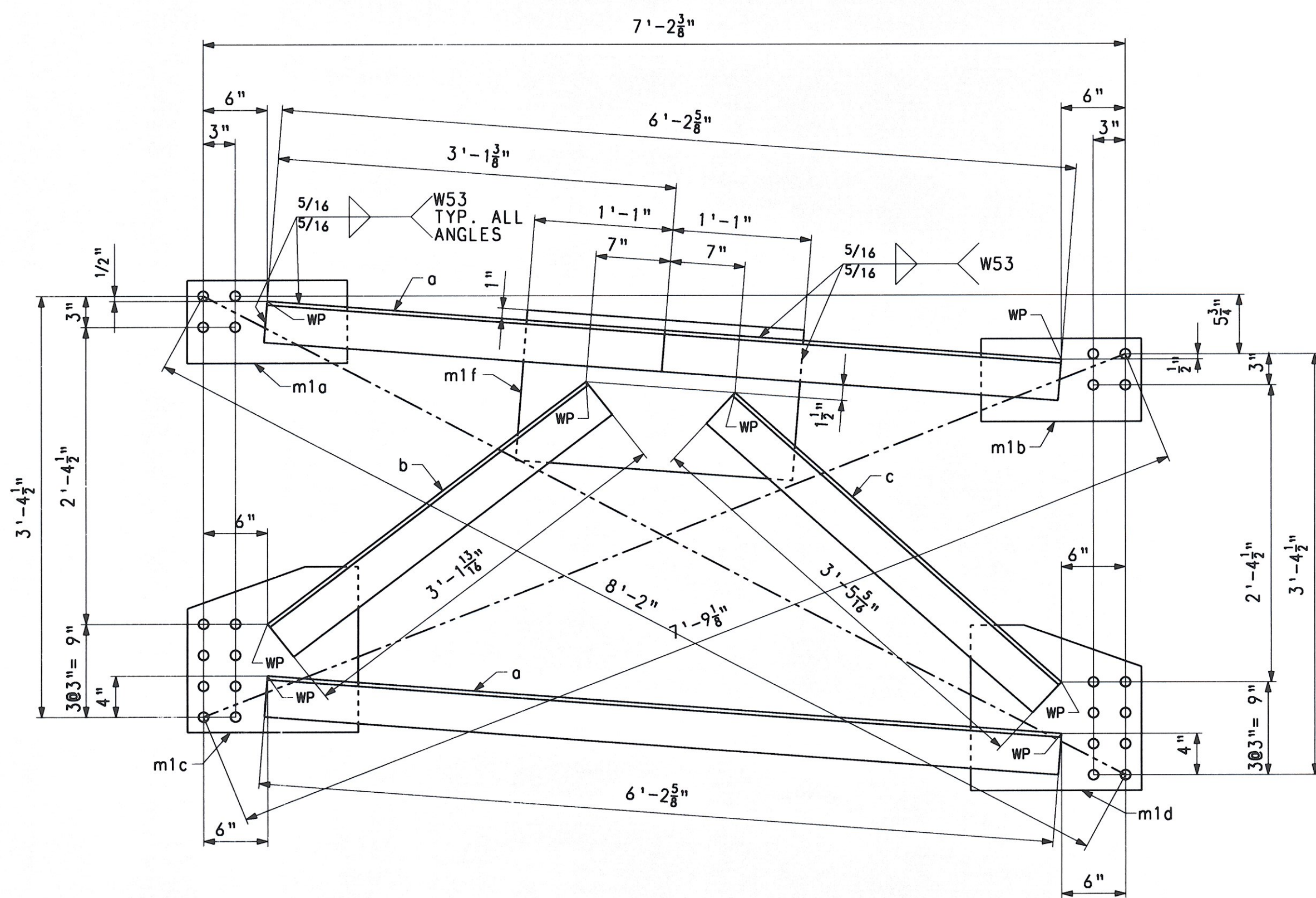

CROSSFRAME - MK. CF8

BILL OF MATERIAL

QTY	MARK	COMMODITY	DESCRIPTION	LENGTH	SPEC	GRADE	TEST	REMARKS	ITEM	GROSS WEIGHT EA.	DEDUCTED WEIGHT EA.	NET WEIGHT EA.
CROSSFRAMES										346.09	0.00	346.09
2	a	L	4 x 4 x 3/8	6 2 9/16	M270	50W	T		11002	60.40	0.00	60.40
1	b	L	4 x 4 x 3/8	3 1 7/8	M270	50W	T		11002	30.68	0.00	30.68
1	c	L	4 x 4 x 3/8	3 5 1/4	M270	50W	T		11002	33.41	0.00	33.41
1	m1a	PL	1/2 x 8	1 3 1/2	M270	50W	T		11003	17.58	0.00	17.58
1	m1b	PL	1/2 x 8	1 3 1/2	M270	50W	T		11003	17.58	0.00	17.58
1	m1c	PL	1/2 x 16	1 4	M270	50W	T		11003	36.30	0.00	36.30
1	m1d	PL	1/2 x 16	1 4	M270	50W	T		11003	36.30	0.00	36.30
1	m1e	PL	1/2 x 14 1/2	2 2	M270	50W	T		11003	53.45	0.00	53.45
CROSSFRAMES										346.19	0.00	346.19
2	a	L	4 x 4 x 3/8	6 2 5/8	M270	50W	T		11002	60.45	0.00	60.45
1	b	L	4 x 4 x 3/8	3 1 13/16	M270	50W	T		11002	30.63	0.00	30.63
1	c	L	4 x 4 x 3/8	3 5 5/16	M270	50W	T		11002	33.46	0.00	33.46
1	m1a	PL	1/2 x 8	1 3 1/2	M270	50W	T		11003	17.58	0.00	17.58
1	m1b	PL	1/2 x 8	1 3 1/2	M270	50W	T		11003	17.58	0.00	17.58
1	m1c	PL	1/2 x 16	1 4	M270	50W	T		11003	36.30	0.00	36.30
1	m1d	PL	1/2 x 16	1 4	M270	50W	T		11003	36.30	0.00	36.30
1	m1e	PL	1/2 x 14 1/2	2 2	M270	50W	T		11003	53.45	0.00	53.45
TOTAL WEIGHT THIS SHEET:										8999.63		LBS.

RECEIVED
 OK'D BY: [Signature] OK'D BY: [Signature]
 AUG 18 2008
 RESUBMIT APPROVED
 BY: KmH DATE: 8/19/08

FOR GENERAL SHOP NOTES, SEE DWG. GN1.

NO.	REVISION	BY	CHK'D	DATE
HOLES 15/16" Ø				
BOLTS NONE	CROSSFRAMES CF7 & CF8 VT ROUTE 100 (MINOR ARTERIAL) OVER WHITE RIVER VT ROUTE 100 STA. 141+39.00 TO STA. 143+61.00 TOWN OF STOCKBRIDGE, COUNTY OF WINDSOR, VERMONT STATE OF VERMONT AGENCY OF TRANSPORTATION			
COATING NONE	STATE CONT. OR REF. NO. PROJ. NO. (STP)BRF 013-4(21) FED. AID PROJ. NO. GENERAL CONTRACTOR WINTerset, INC. HSSI PROJ. MGR DEB KUPRES SHPMT 1 DRAWING MANAGER KREIDER (IH) MADE BY SSL CHK'D BY CS DATE 6-19-08 STATE VT HSSI PROJECT NUMBER S-1080077 HSSI STRUCT. ID A DRAWING NUMBER 19 OF 22			