

ENGLISH

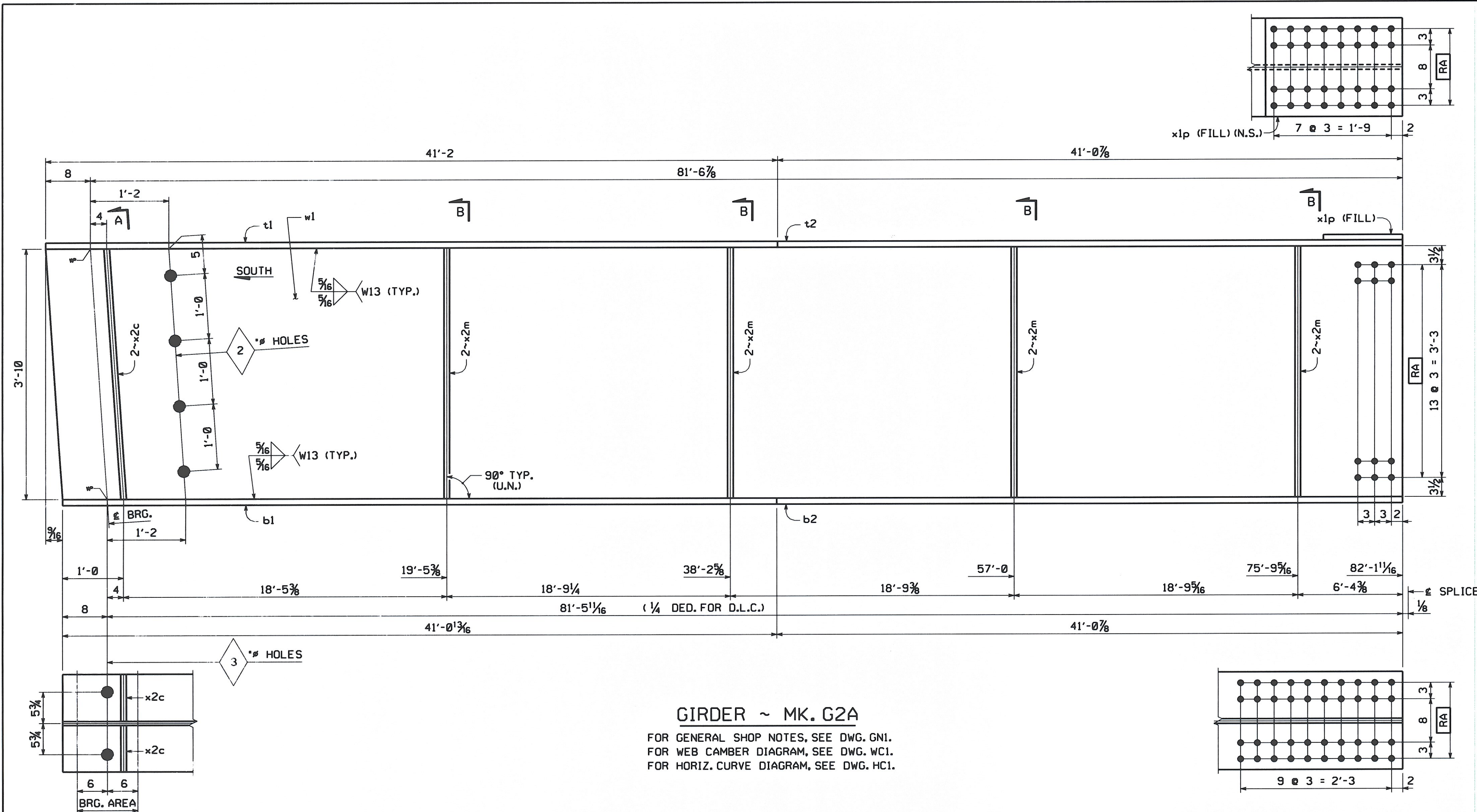

**GIRDER ~ MK. G2A**  
 FOR GENERAL SHOP NOTES, SEE DWG. GNI.  
 FOR WEB CAMBER DIAGRAM, SEE DWG. WCI.  
 FOR HORIZ. CURVE DIAGRAM, SEE DWG. HCI.

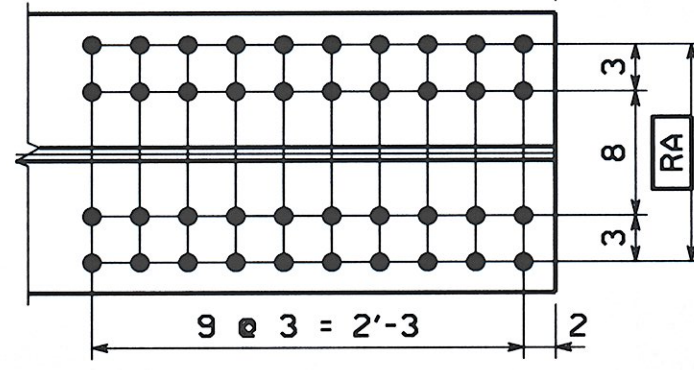
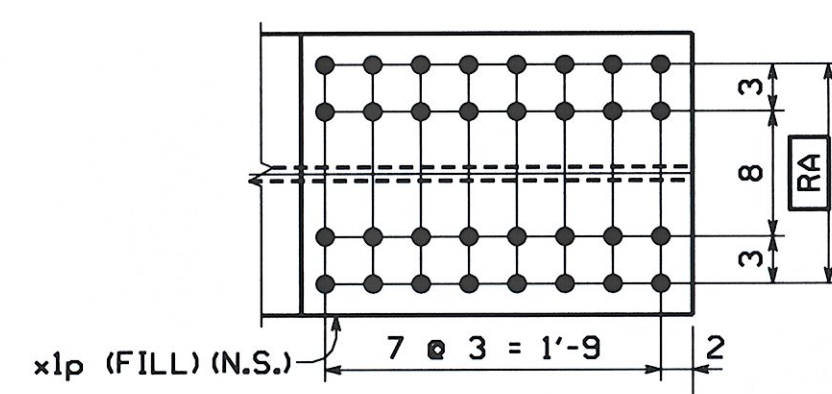
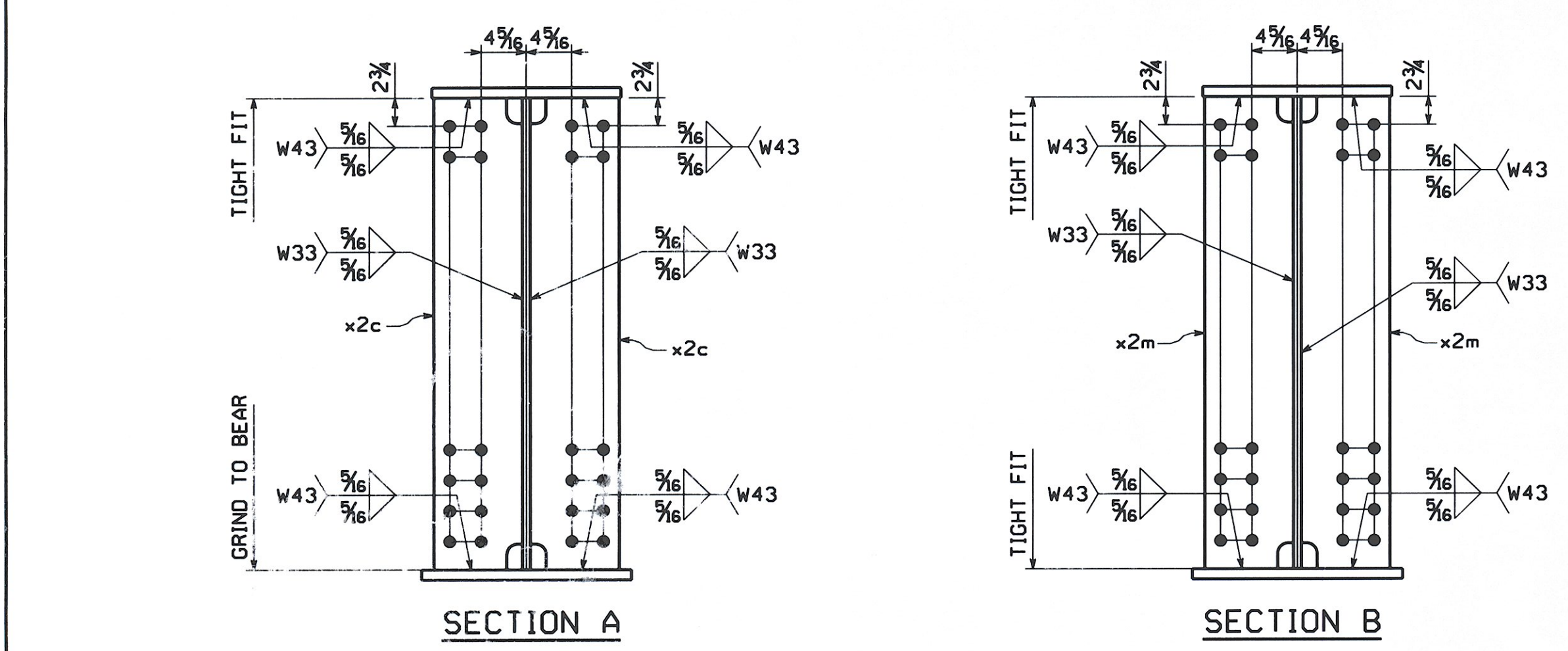

**BILL OF MATERIAL**

QTY EA	MARK	COMM	DESCRIPTION	LENGTH	SPEC	GRADE	TEST	REMARKS	ITEM	GROSS WEIGHT EA	DEDUCTED WEIGHT EA	SHIP WT. EA (LBS)		
1	G2A		GIRDER							26,425.65	5.03	26,425.65		
1	w1	PL	5/8 x 46	82	2	7/8	M270	50W	T	03002	8,045.49	5.03	8,040.46	
1	t1	PL	1 1/4 x 18	41	2		M270	50W	T	04007	3,151.82	0.00	3,151.82	
1	t2	PL	1 1/4 x 18	41	0 15/16		M270	50W	T	04007	3,145.04	0.00	3,145.04	
1	b1	PL	2 1/4 x 18	41	0 13/16		M270	50W	T	04002	5,659.64	0.00	5,659.64	
1	b2	PL	2 1/4 x 18	41	0 15/16		M270	50W	T	04002	5,661.08	0.00	5,661.08	
1	x1p	PL	1 x 18	2	0 1/2		M270	50W	T	FILL PL	06008	125.05	0.00	125.05
2	x2c	PL	7/8 x 8 1/2	3	10		M270	50W	T		07001	97.01	0.00	97.01
8	x2m	PL	1/2 x 8 1/2	3	10		M270	50W	T		07003	55.44	0.00	55.44
<b>TOTAL WEIGHT THIS SHEET:</b>										<b>26425.65 lbs.</b>				

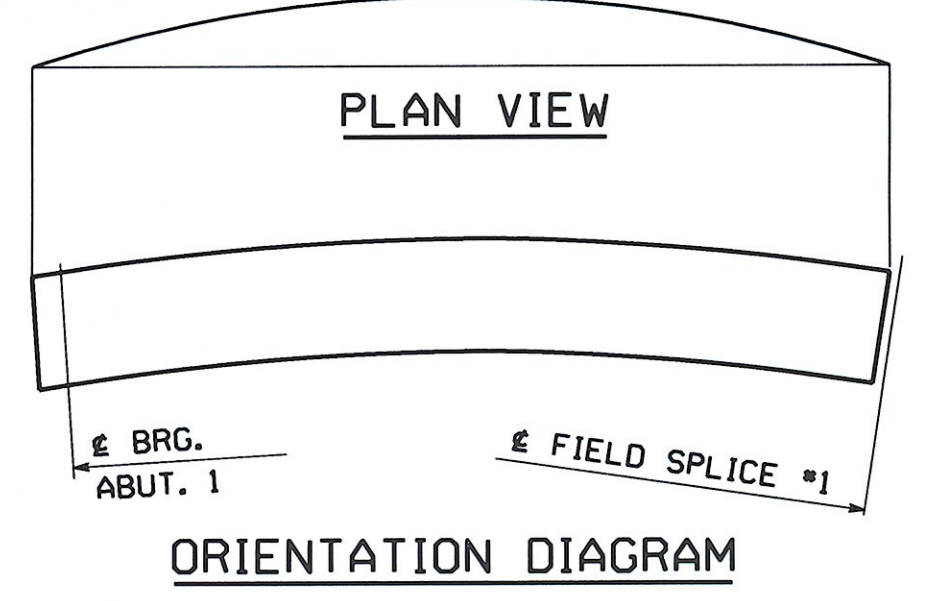

NO.	REVISION	BY	CHK'D	DATE
Holes 1 5/16" (L.N.)				
BOLTS NONE	<b>GIRDER G2A</b> VT ROUTE 100 (MINOR ARTERIAL) OVER WHITE RIVER VT ROUTE 100 STA. 141+39.00 TO STA. 143+61.00 TOWN OF STOCKBRIDGE, COUNTY OF WINDSOR, VERMONT STATE OF VERMONT AGENCY OF TRANSPORTATION			
COATING NONE	STATE CONT. OR REF. NO.	PROJECT NO. (STP) BR	FED. AID PROJ. NO.	
CODES:	30	013-4(21)		
SCALE N.T.S.	GENERAL CONTRACTOR	WINTERSET, INC.	HSS PROJ. MGR	DEB KUPRES
SHIPMT	DRAWING MANAGER	KREIDER (IH)	MADE BY	MAF
STATE	VT	HSS PROJECT NUMBER	HSS STRUCT. ID	DRAWING NUMBER
		S-1080077	A	2 OF 22

RECEIVED  
 AUG 18 2008  
 RESUBMIT APPROVED  
 BY RMH DATE 8/19/08

PH&ENG: 5004327 PRJ: 5004328 SHIP&RECT: 5004329  
 SHIPMENT 01  
 BY: MK-re:del  
 PLOTTED: 6/25/2008 3:38:31 PM