

DGCS = 9.44 ft²
 Agg Surface = 4.26 ft²
 Common EX = 12.70 ft²

TIMBER RIVER ROAD
 SUBBASE TRANSITION
 NTS

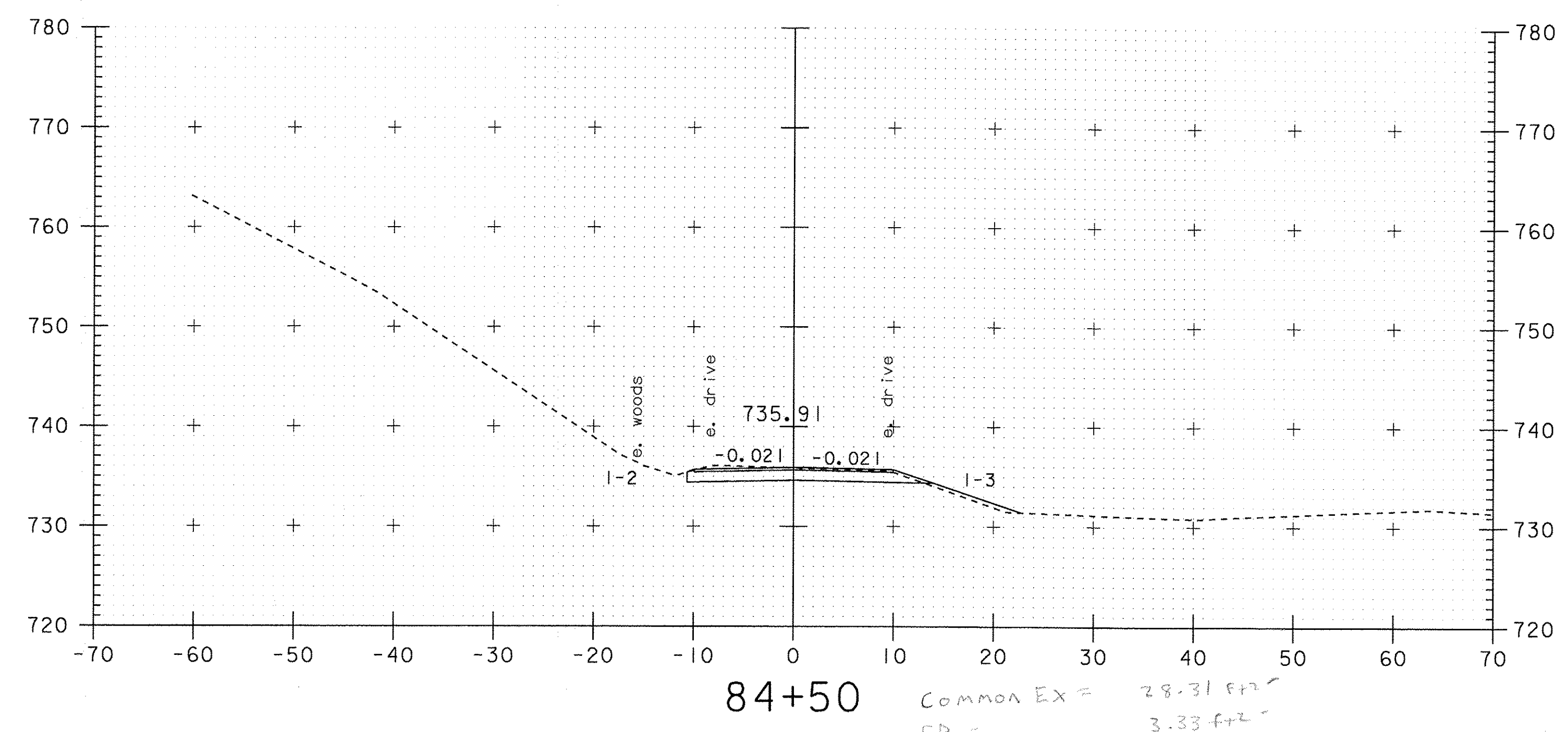

Common EX = 28.31 ft²
 EB = 3.33 ft²
 DGCS = 23.74 ft²
 Sand = 0 ft²
 Agg Surface = 4.76 ft²

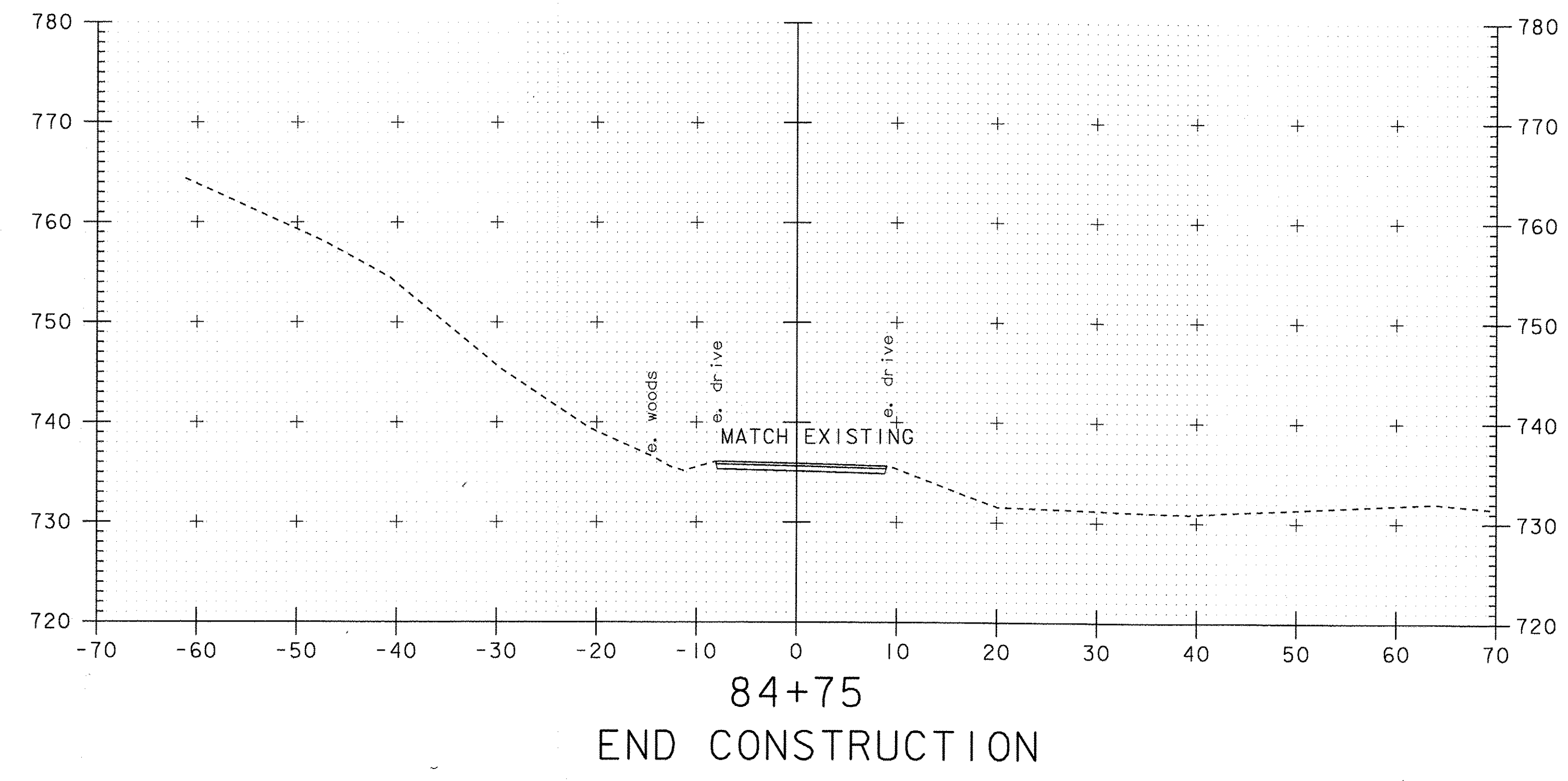
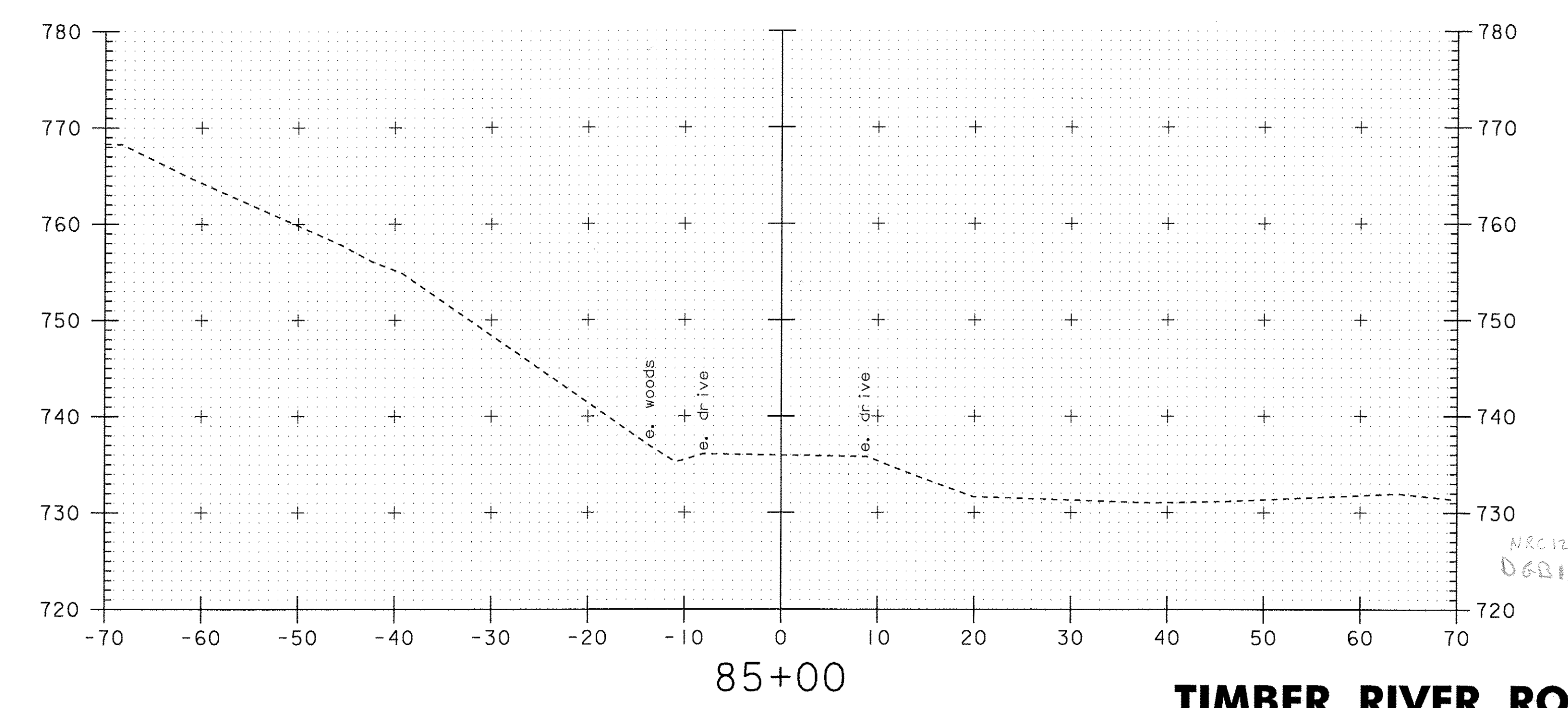

NRC 12/16/09
 DGB

TIMBER RIVER ROAD
 CROSS SECTIONS
 STA. 84+50 - STA. 85+00

PROJECT NAME-	STOCKBRIDGE
PROJECT NUMBER-	BRF 013-4 (21)
FILE NAME- /78f238/str5/df268xsl.dgn	PLOT DATE- 06-FEB-2008
PROJECT LEADER- K. HIGGINS	DRAWN BY- G. SHANGRAW
DESIGNED BY- T. SUMNER	CHECKED BY- T. FILLBACH
df23r4.i	SHEET 132 OF 144

