

16 - TOP GUSSET PLATES ~ mia
(@ END CROSSFRAMES)

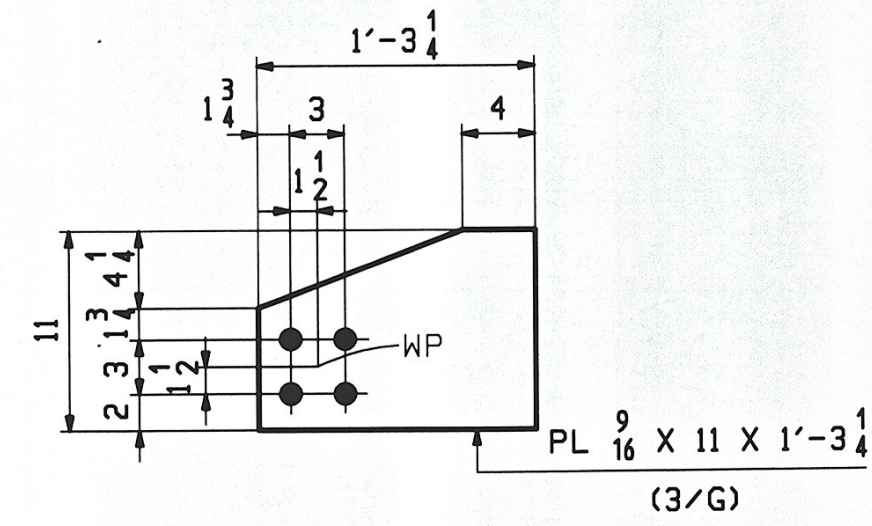

16 - BTM GUSSET PLATES ~ mib
(@ END CROSSFRAMES)

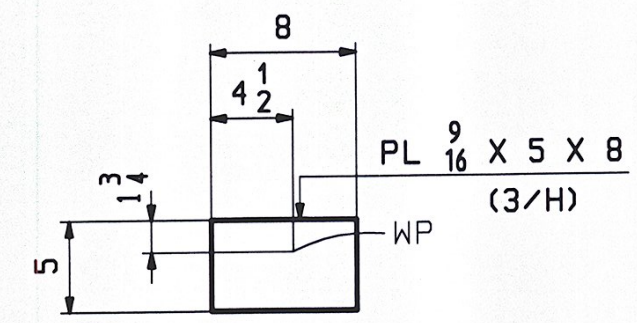

8 - CTR GUSSET PLATES ~ mic
(@ END CROSSFRAMES)

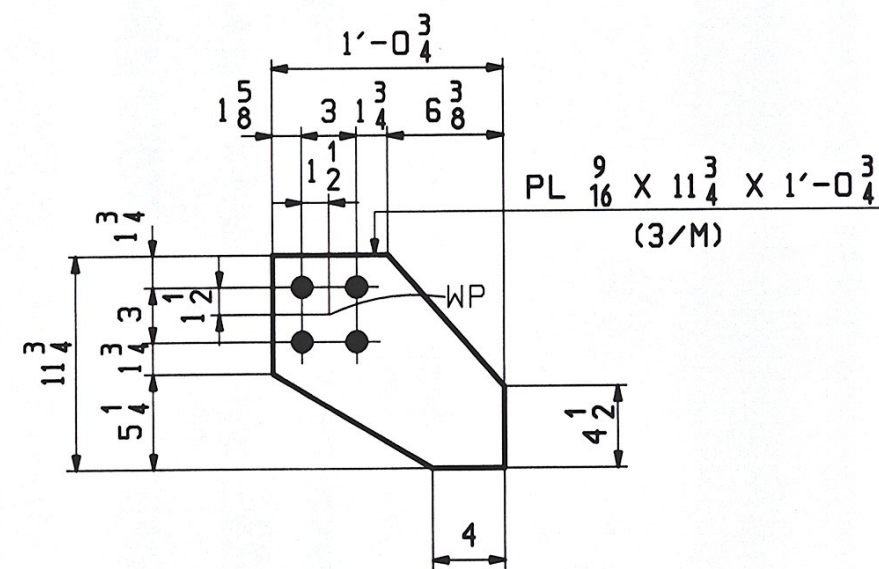

128 - TOP GUSSET PLATES ~ mid
(@ INT TYPE CF1 CROSSFRAMES)

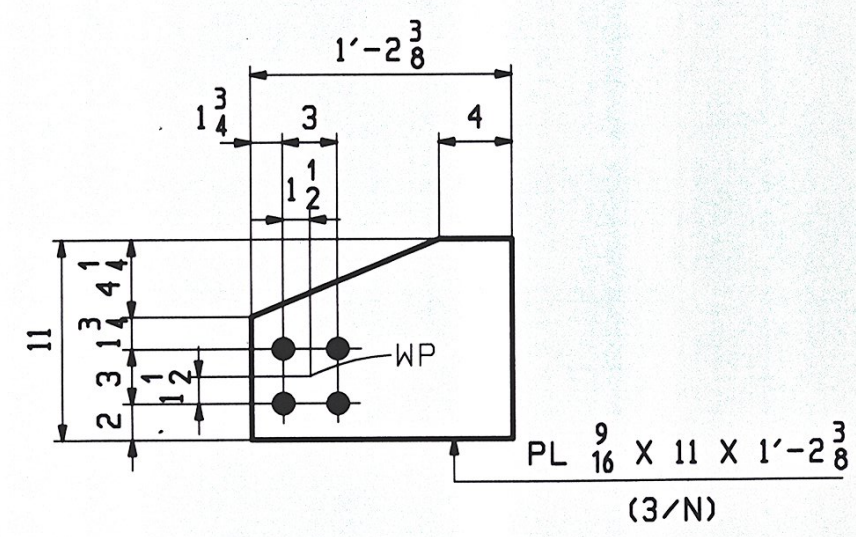

128 - BTM GUSSET PLATES ~ mif
(@ INT TYPE CF1 CROSSFRAMES)

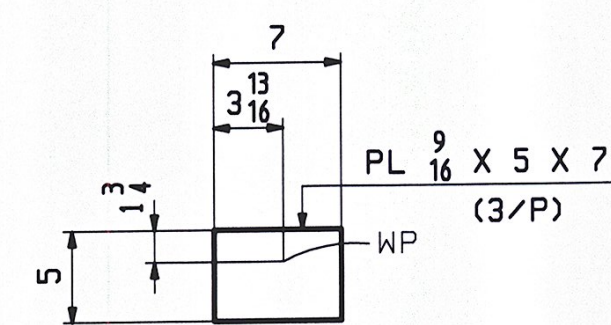

64 - CTR GUSSET PLATES ~ mig
(@ INT TYPE CF1 CROSSFRAMES)

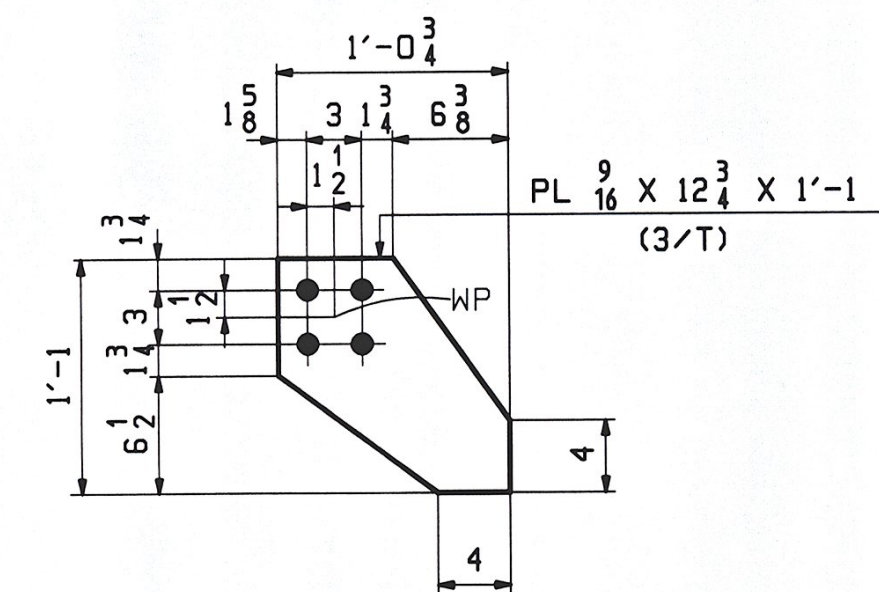

16 - TOP GUSSET PLATES ~ mih
(@ INT TYPE CF2 CROSSFRAMES)

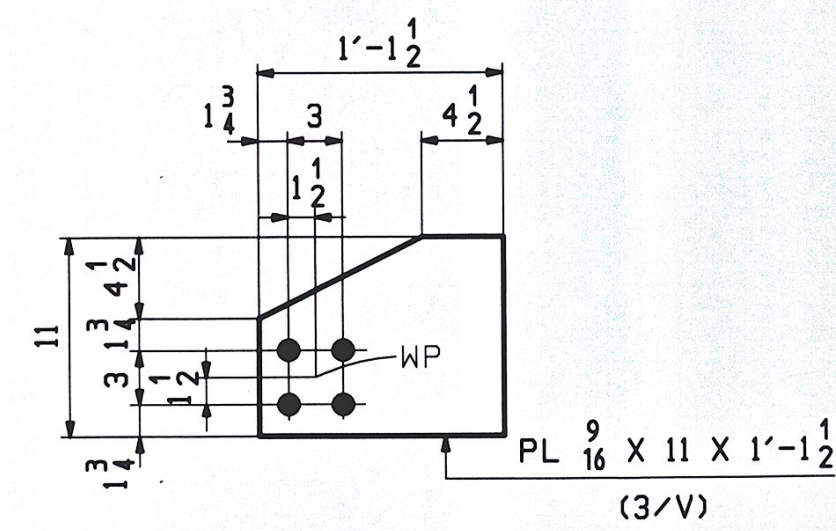

16 - BTM GUSSET PLATES ~ mik
(@ INT TYPE CF2 CROSSFRAMES)

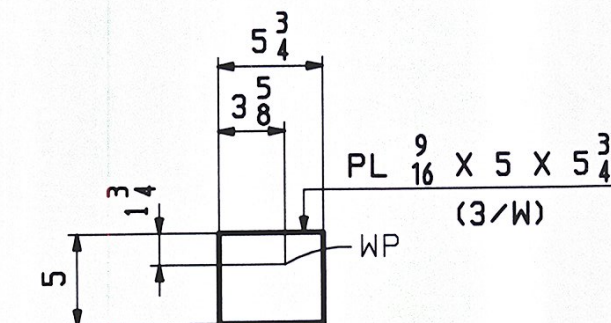

8 - CTR GUSSET PLATES ~ mim
(@ INT TYPE CF2 CROSSFRAMES)

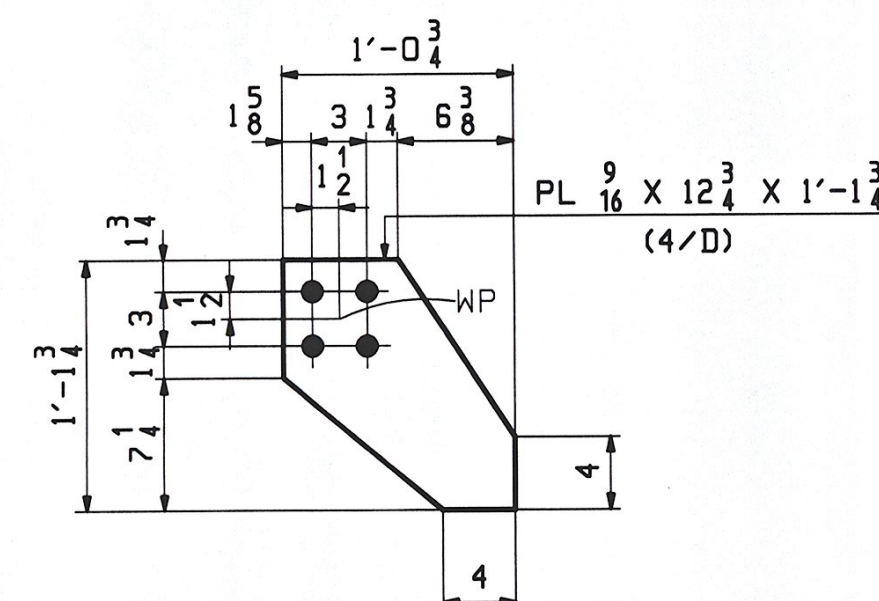

16 - TOP GUSSET PLATES ~ min
(@ INT TYPE CF3 CROSSFRAMES)

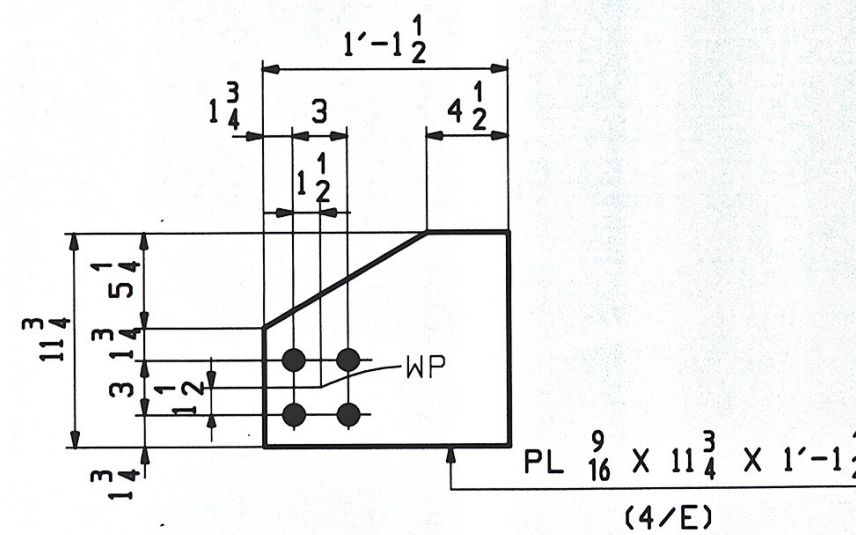

16 - BTM GUSSET PLATES ~ mip
(@ INT TYPE CF3 CROSSFRAMES)

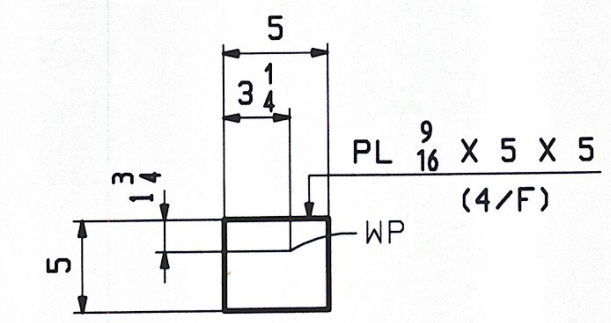

8 - CTR GUSSET PLATES ~ mis
(@ INT TYPE CF3 CROSSFRAMES)

REVISION
 DATE: 5/5/09
 BY: MFM
 11/5/09

NOTES:
 FOR GENERAL NOTES SEE DRAWING GNI.

				MAY 12 2009	
0				AUG 27 2009	
REV. DATE	REMARKS	DWN	CHK	APVL	SHOP
MATERIAL: M270-S0W (UN)		SURFACE PREP. & PAINT: SEE GNI		HOLES: 15/16" U.N.	
				SHOP BOLTS: NONE	
DESCRIPTION: CROSSFRAME STANDARDS					
CASCO BAY STEEL STRUCTURES, INC. 75 SPRING HILL ROAD SACO, MAINE 04072 PHONE (207) 282-7360 FAX. (207) 282-1179					
STRUCTURE: US RTE 2 OVER WINOOSKI RIVER WASHINGTON COUNTY, VT		DRAWN: TS	DATE: 08/13		
		CHKD: PCP	DATE: 08/19		
LOCATION: TOWNS OF MORETOWN ~ MIDDLESEX, VT		JOB NO. 421-1	DWG NO. M1		
PROJ NO. BRS 0284(14)		REV. 1			
CUSTOMER: WINTERSET INC.					

PCP Thu Aug 10 2009 09:00:57 AM c:\msd\work\2009\PL1.RVT