

**RAILING TRANSITION PLAN**

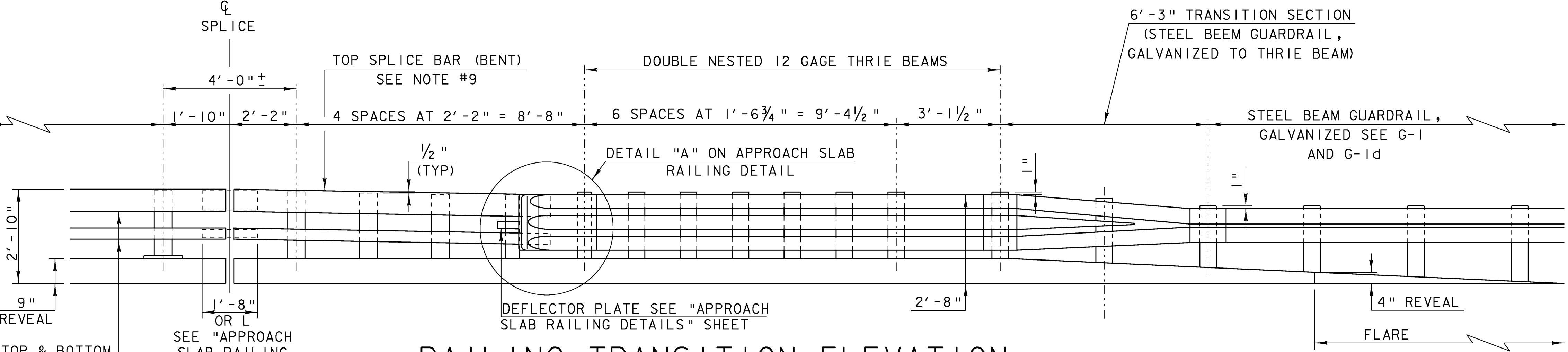

**RAILING TRANSITION ELEVATION**

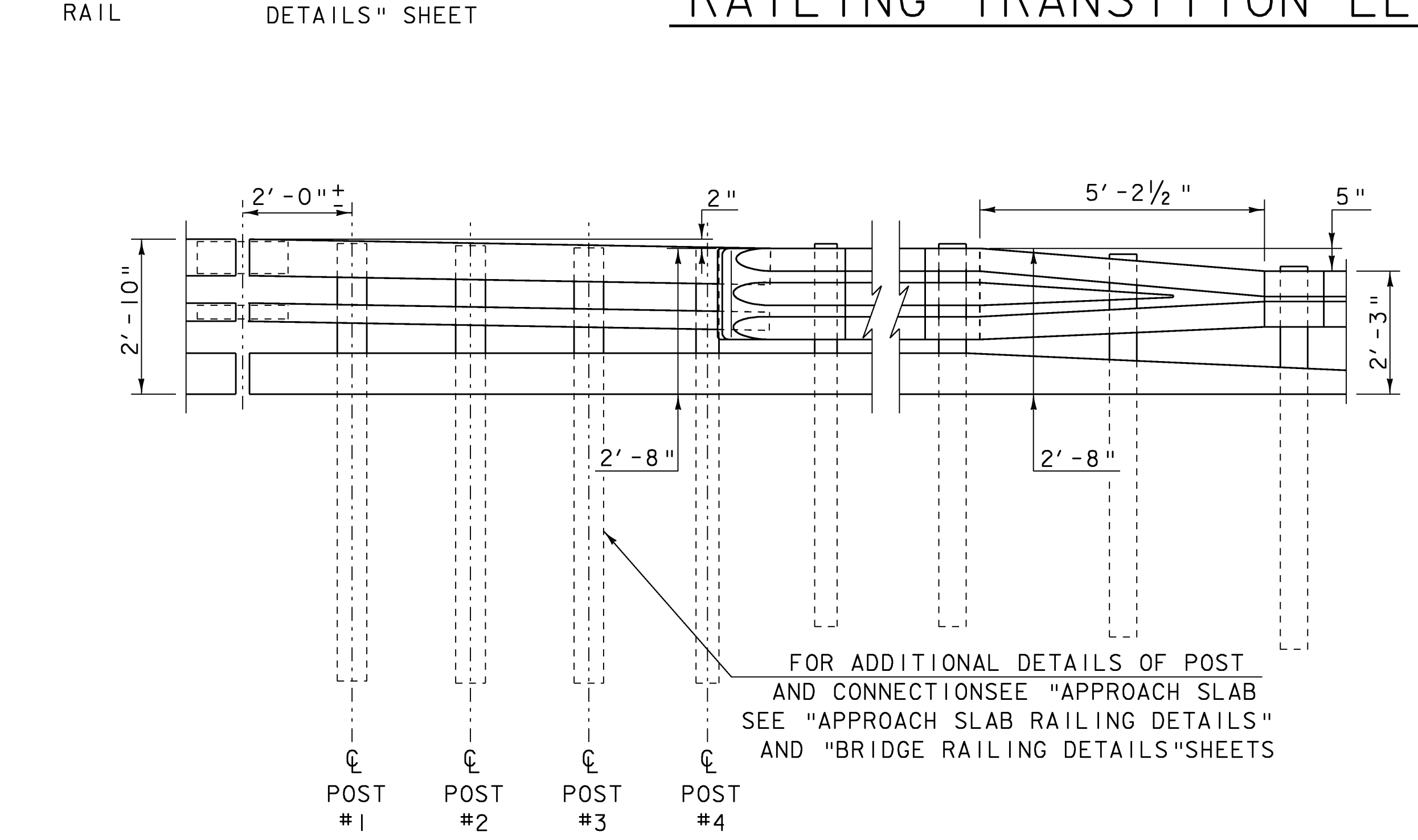

**ELEVATION**

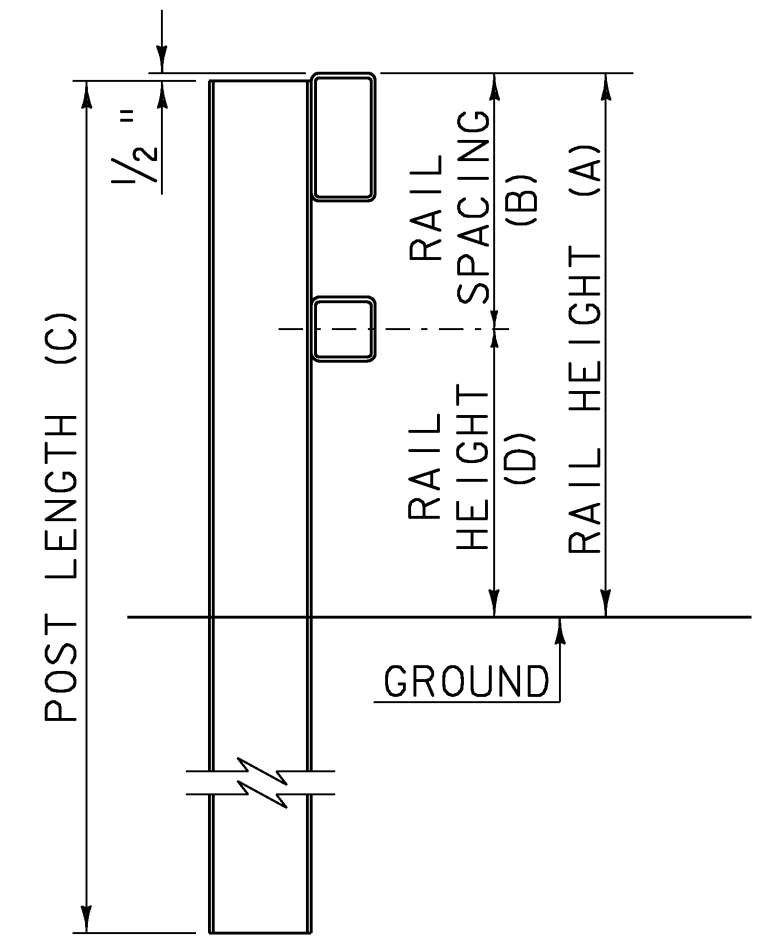

**TYPICAL SECTION**

POST NUMBER	RAIL HEIGHT (A)	RAIL SPACING (B)	POST LENGTH (C)	RAIL HEIGHT (D)
1	2' - 9 1/2"	1' - 3 3/4"	8' - 0"	1' - 5 3/4"
2	2' - 9"	1' - 3 1/2"	8' - 0"	1' - 5 1/2"
3	2' - 8 1/2"	1' - 3 5/16"	8' - 0"	1' - 5 5/16"
4	2' - 8"	1' - 2 7/8"	8' - 0"	1' - 5 1/8"

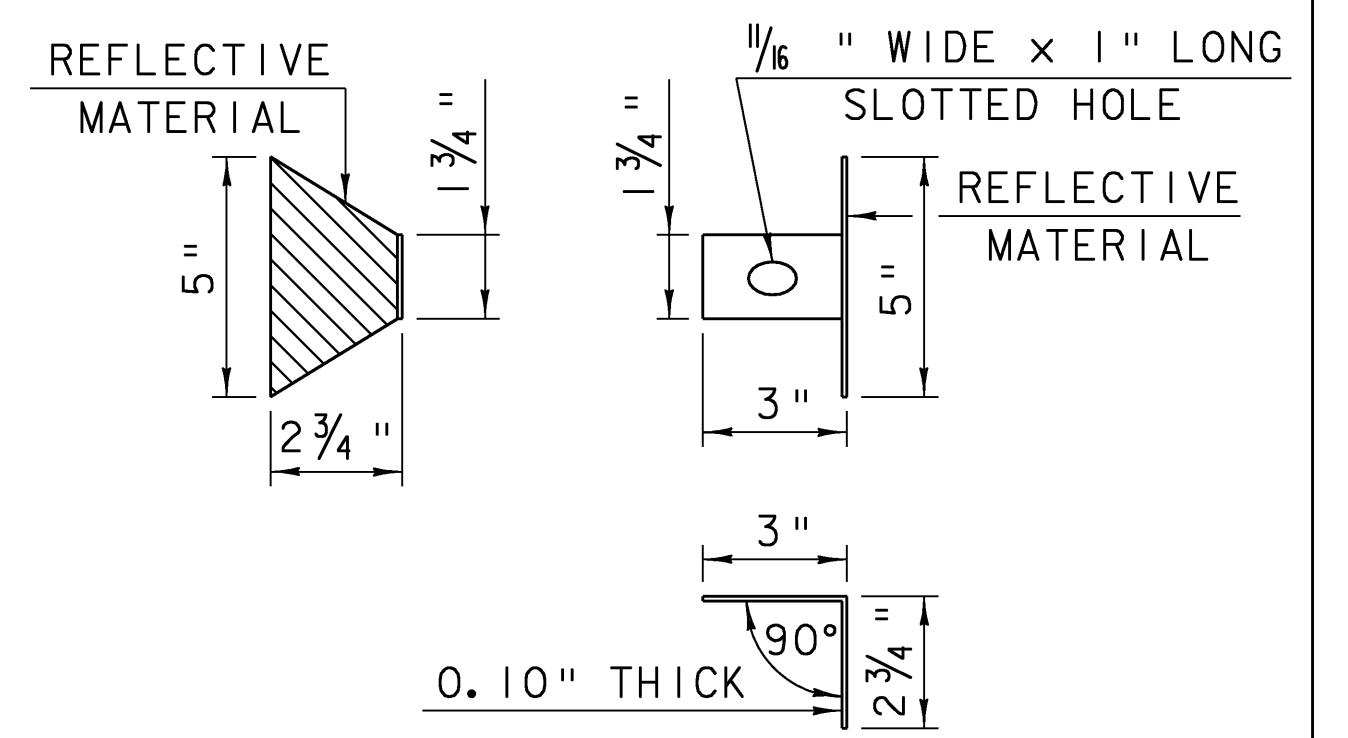

**DELINEATION DEVICE DETAILS**

**NOTES**

- REFER TO BRIDGE RAILING DETAILS AND APPROACH SLAB RAILING DETAILS FOR ADDITIONAL DETAILS, NOTES AND MATERIAL SPECIFICATIONS.
- PAYMENT FOR GUARD RAIL APPROACH SECTION - NETC 2 RAIL SHALL INCLUDE THE TERMINAL CONNECTOR, THE CONNECTION PLATE, THE DEFLECTOR PLATE, RAIL, POSTS, BLOCKS AND ATTACHMENT HARDWARE.
- THE REFLECTORIZED ALUMINUM DELINEATION IS TO BE ERECTED EVERY 30' (OR CLOSEST POST) WITH A 5/8" DIAMETER BOLT. DELINEATORS SHALL MEET SPECIFICATION REQUIREMENTS FOR ASTM B209 ALLOY 5052-H32.
- REFLECTIVE MATERIAL SHALL MEET REQUIREMENTS OF SUBSECTION 750.08 AND SHALL BE OF ENCAPSULATED LENS SILVER OR AMBER. AMBER IS TO BE INSTALLED ON THE DRIVER'S LEFT AND SILVER ON THEIR RIGHT.
- NOTE NOT USED.
- ALL APPROACH RAIL SPLICES SHALL BE LAPPED IN THE DIRECTION OF TRAFFIC FLOW.
- ALL BRIDGE APPROACH RAIL MATERIALS, DIMENSION SIZES AND NOTES SHALL BE THE SAME AS THOSE OF THE BRIDGE RAIL, UNLESS OTHERWISE NOTED.
- APPROACH RAIL BOLTS SHALL BE ASTM A307 GRADE A AND NUTS SHALL BE AASHTO M291 (ASTM A563 GRADE A OR BETTER (GALVANIZED)). WASHERS SHALL BE ASTM F844.
- WELD TOP SPLICE BAR TO FIT BEND. USE COMPLETE PENETRATION WELD (B-U2).
- THE CONCRETE CURB OFF OF THE APPROACH SLAB WILL BE PAID FOR AS ITEM 616.28, "CAST-IN-PLACE CONCRETE CURB, TYPE B." SEE STANDARD C-10.

**APPROACH RAILING DETAILS**

PROJECT NAME: MORETOWN-MIDDLESEX  
 PROJECT NUMBER: BRS 0284(I4)  
 FILE NAME: /78f219/str2/sf219frm.dgn PLOT DATE: 15-JUN-2009  
 PROJECT LEADER: EVANS-MONGEON DRAWN BY: G. ROKES  
 DESIGNED BY: S. SCRIBNER CHECKED BY: S. SCRIBNER  
 IPARM: s78f219typ.1 SHEET 74 OF 103