

1 CURTAIN WALL DIMENSIONAL ELEVATION
 NBS.1 VOL.: 1.93 cy WT.: 3.91 T 3/4" = 1'-0"

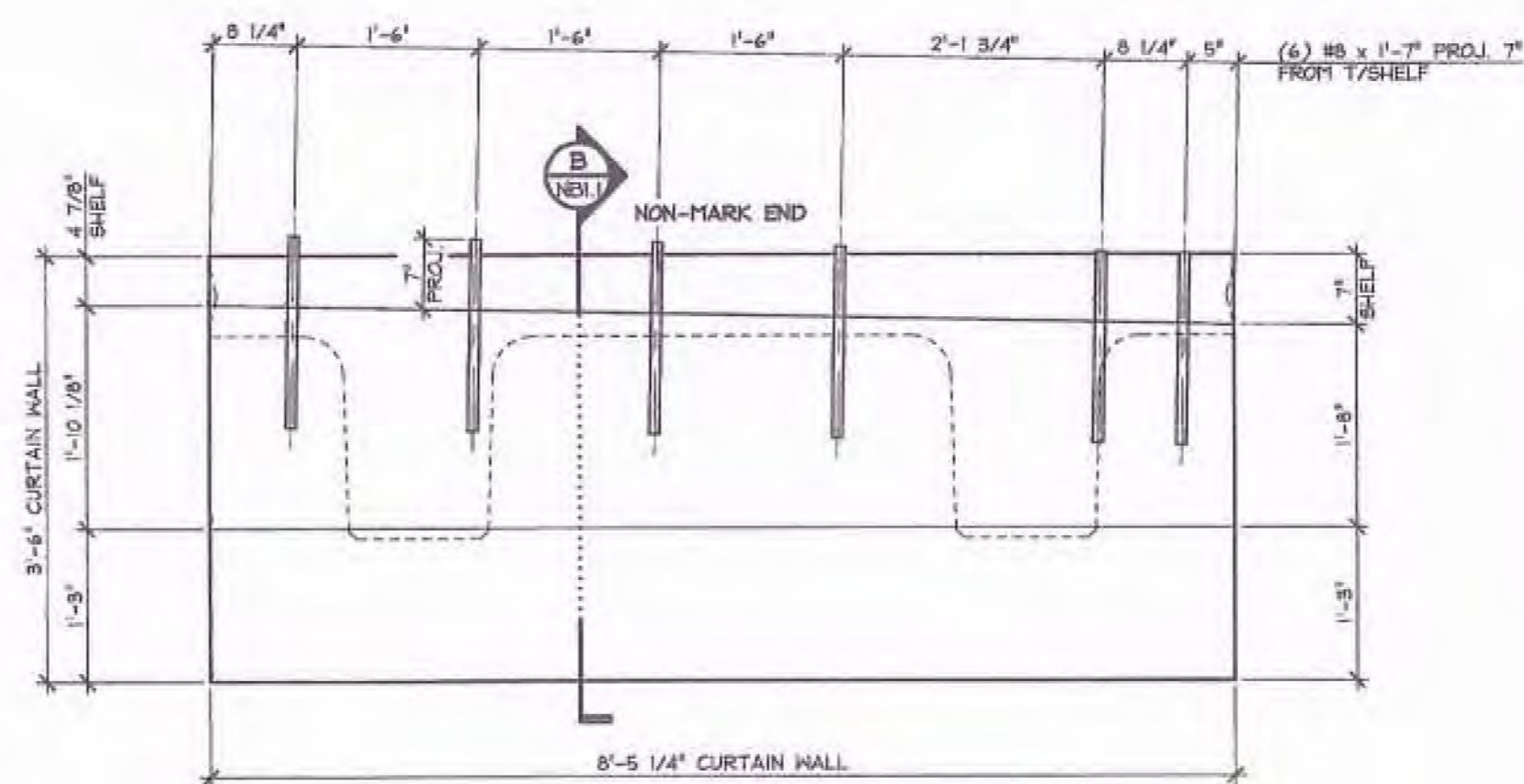

3 CURTAIN WALL DIMENSIONAL ELEVATION
 NBS.1 VOL.: 2.24 cy WT.: 4.54 T 3/4" = 1'-0"

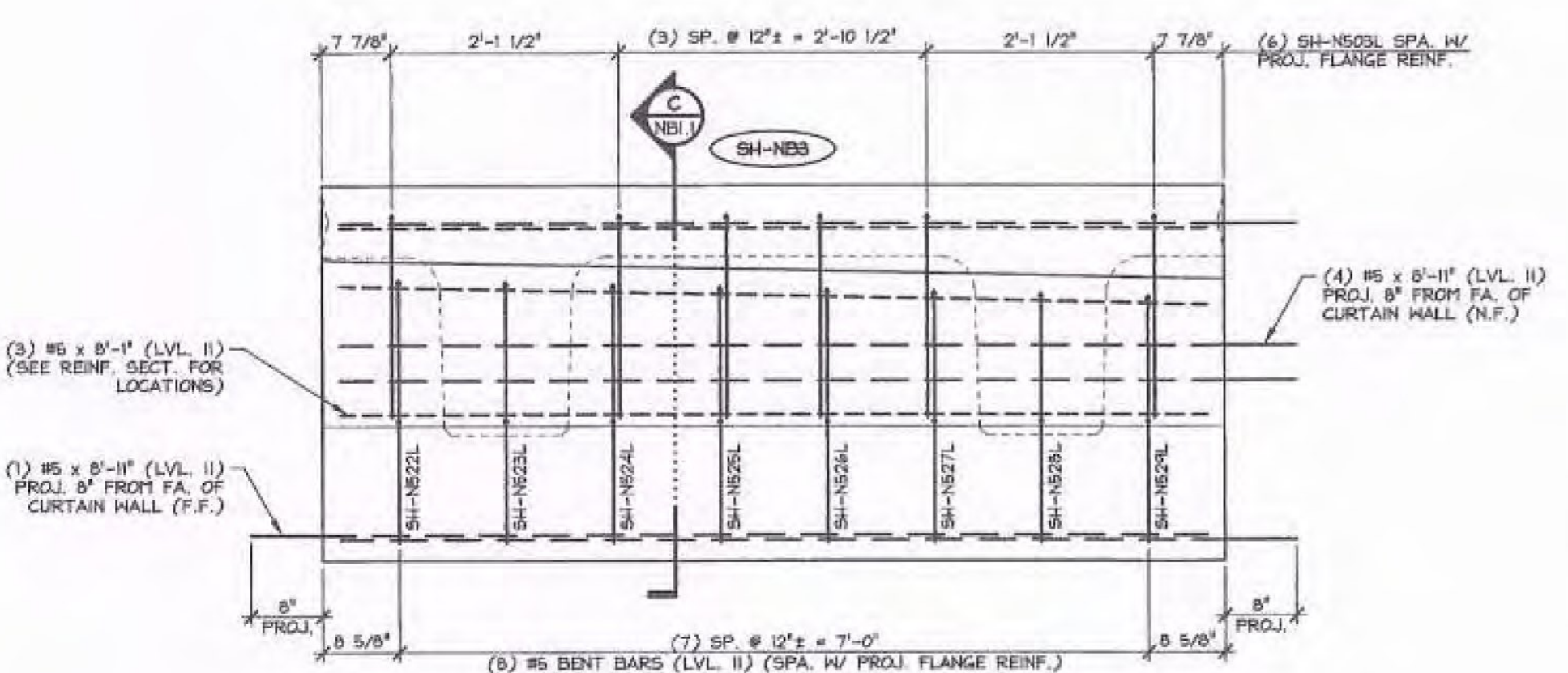

2 CURTAIN WALL DIMENSIONAL ELEVATION
 NBS.1 3/4" = 1'-0"

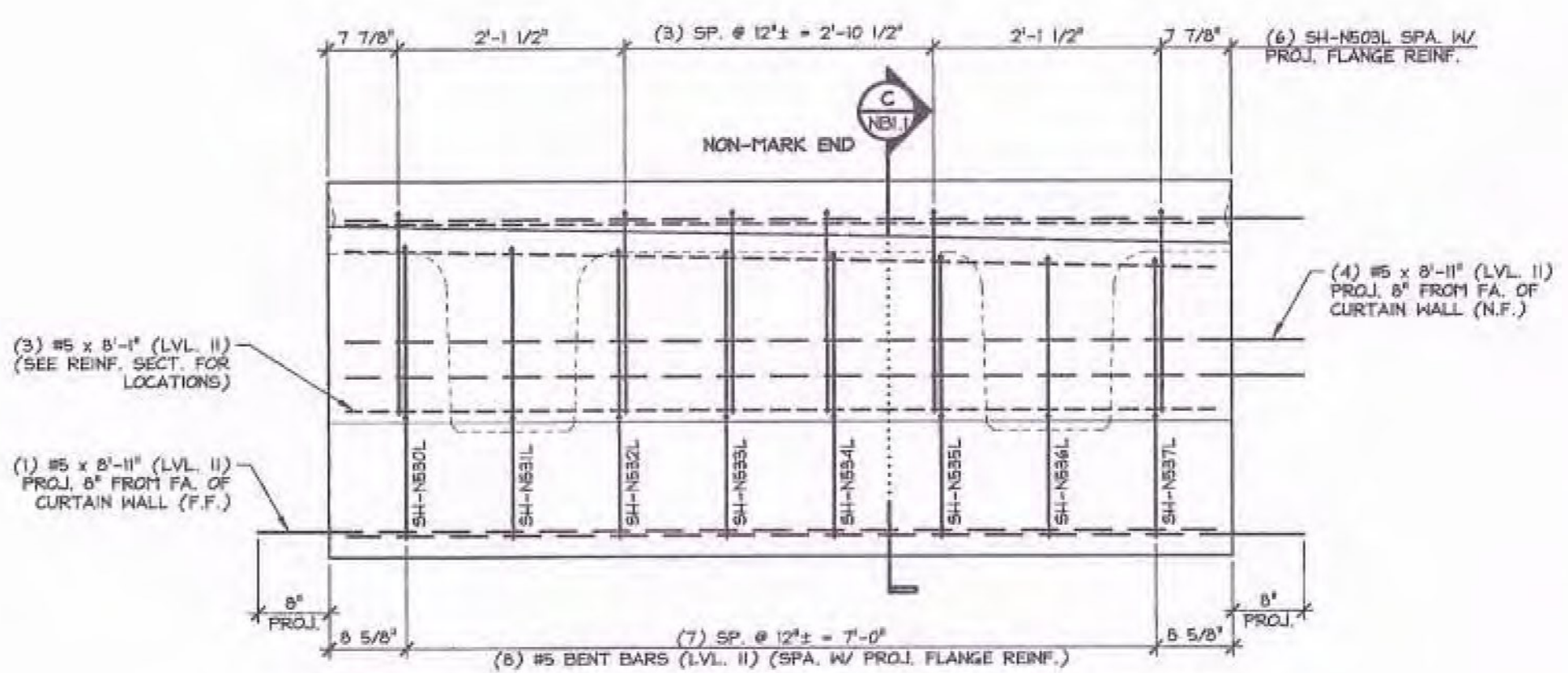

4 CURTAIN WALL DIMENSIONAL ELEVATION
 NBS.1 3/4" = 1'-0"

Vermont Agency of Transportation
RECEIVED
 ON: February 12, 2014
 and Checked for
CONFORMANCE
 BY: Jennifer Fitch DATE: 02/27/14

SHOP DRAWING REVIEW

REVIEWED AS REQUIRED BY THE CONSTRUCTION CONTRACT DOCUMENTS AND APPROVED, BUT ONLY FOR CONFORMANCE TO THE DESIGN CONCEPT OF THE WORK, AND SUBJECT TO FURTHER LIMITATIONS AND REQUIREMENTS CONTAINED IN THE CONSTRUCTION CONTRACT DOCUMENTS.

REJECTED REVISE AND RESUBMIT FINISH AS CORRECTED

CORRECTIONS OR COMMENTS MADE ON THE SHOP DRAWINGS DURING THIS REVIEW DO NOT RELIEVE CONTRACTOR FROM COMPLIANCE WITH REQUIREMENTS OF THE DRAWINGS AND SPECIFICATIONS. THIS CHECK IS ONLY FOR REVIEW OF GENERAL CONFORMANCE WITH THE DESIGN CONCEPT OF THE PROJECT AND GENERAL COMPLIANCE WITH THE INFORMATION GIVEN IN THE CONTRACT DOCUMENTS. THE CONTRACTOR IS RESPONSIBLE FOR CONFIRMING AND CORRELATING ALL QUANTITIES AND DIMENSIONS; SELECTING FABRICATION PROCESSES AND TECHNIQUES OF CONSTRUCTION; COORDINATING HIS WORK WITH THAT OF ALL OTHER TRADES; AND PERFORMING HIS WORK IN A SAFE AND SATISFACTORY MANNER.

VHB Vanasse Hangen Brustlin, Inc.
 Job Number: 57438.00
 Reviewed By: J. Moore
 Date: 2-14-14

46.07 T = NEXT BEAM
 3.91 T = CURTAIN WALL (MARK END)
 4.54 T = CURTAIN WALL (NON-MARK END)
 54.5 T = TOTAL BEAM WT.

SUBMITTED
 FEB 12 2014
 J.P. CARRARA & SONS, INC.
 MIDDLEBURY, VT 05753

MARK: SH-NB3 QTY.: 1

MATERIAL LIST / CURTAIN WALL				
ITEM	MARK	DESCRIPTION	QTY./CURTAIN WALL	
			MARK END	NON-MARK END
1	SH-NB23L	#5 BENT BAR (LEVEL II, DUAL COATED)	6	6
2	SH-NB22L	#5 BENT BAR (LEVEL II, DUAL COATED)	1	
3	SH-NB23L	#5 BENT BAR (LEVEL II, DUAL COATED)	1	
4	SH-NB24L	#5 BENT BAR (LEVEL II, DUAL COATED)	1	
5	SH-NB25L	#5 BENT BAR (LEVEL II, DUAL COATED)	1	
6	SH-NB26L	#5 BENT BAR (LEVEL II, DUAL COATED)	1	
7	SH-NB27L	#5 BENT BAR (LEVEL II, DUAL COATED)	1	
8	SH-NB28L	#5 BENT BAR (LEVEL II, DUAL COATED)	1	
9	SH-NB29L	#5 BENT BAR (LEVEL II, DUAL COATED)	1	
10	SH-NB30L	#5 BENT BAR (LEVEL II, DUAL COATED)		1
11	SH-NB31L	#5 BENT BAR (LEVEL II, DUAL COATED)		1
12	SH-NB32L	#5 BENT BAR (LEVEL II, DUAL COATED)		1
13	SH-NB33L	#5 BENT BAR (LEVEL II, DUAL COATED)		1
14	SH-NB34L	#5 BENT BAR (LEVEL II, DUAL COATED)		1
15	SH-NB35L	#5 BENT BAR (LEVEL II, DUAL COATED)		1
16	SH-NB36L	#5 BENT BAR (LEVEL II, DUAL COATED)		1
17	SH-NB37L	#5 BENT BAR (LEVEL II, DUAL COATED)		1
18		#5 x 8'-1" (LVL. II, DUAL COATED)	3	3
19		#5 x 8'-1" (LVL. II, DUAL COATED)	5	5
20				
21		#8 x 1'-7" (LEVEL II, DUAL COATED)	6	6
22				
23				
24				
25				

APPROVAL STAMP:	J.P. CARRARA & SONS INC. Precast & Prestress Manufacturer <small>2464 OGDEN ST., MIDDLEBURY, VERMONT 05753 Phone: (802)388-6301 Fax: (802)388-0010</small>	T. BUCK CONSTRUCTION CONTRACTOR AUBURN, MAINE
	STATE OF VERMONT AGENCY OF TRANSPORTATION COUNTY OF ADDISON	DATE: OCT. 9, 2013 SCALE: NOTED
	TOWN OF MIDDLEBURY ROUTE NO. VT 125, EAST MIDDLEBURY GORGE BRIDGE NO. 13 PROJECT NO.: RS 0174(B)	CHKD: DFTM: B.L. JOB NO: 23411-013
	PRECAST CURTAIN WALL DETAILS	DWG. NO: NBS.1