

Drawing Number	Revision Number	Ship Mark	Piece Mark	Qty	Type of Material	Size of Material	Grade	Length	Finish	Notes
137		137TL1		4				Total weight:		2157 kg
137		137TL1	ma137	16	L Angles	89x89x7.9	M270M-GR345	8143		41
137		137TL1	x154pa	4	PL Plate	8x373	M270M-GR345	8143		42
137		137TL2		4				Total weight:		2161 kg
137		137TL2	mb137	16	L Angles	89x89x7.9	M270M-GR345	8159		41
137		137TL2	x154pb	4	PL Plate	8x373	M270M-GR345	8159		42

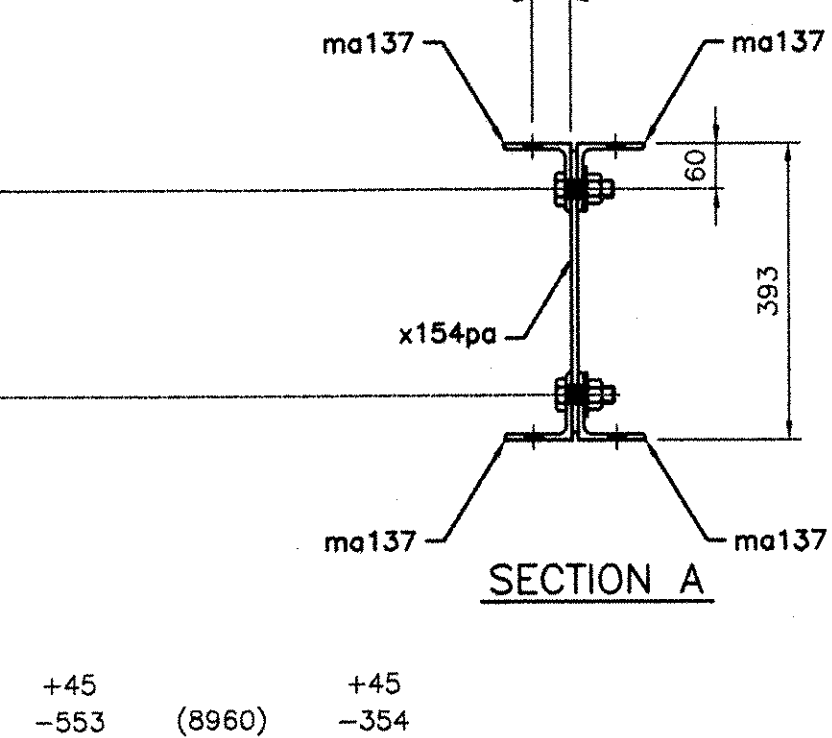

4 -TOP LATERAL BRACE ASSEMBLIES - 137TL1

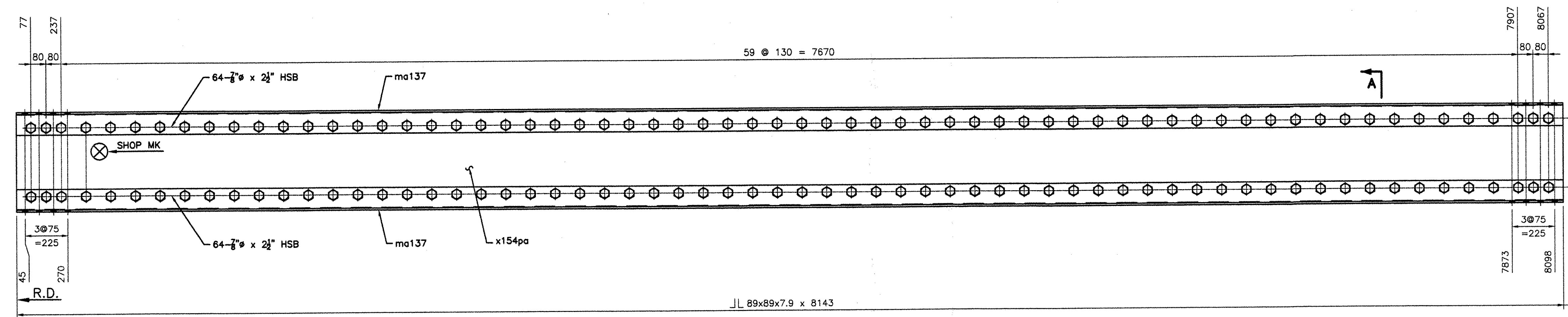
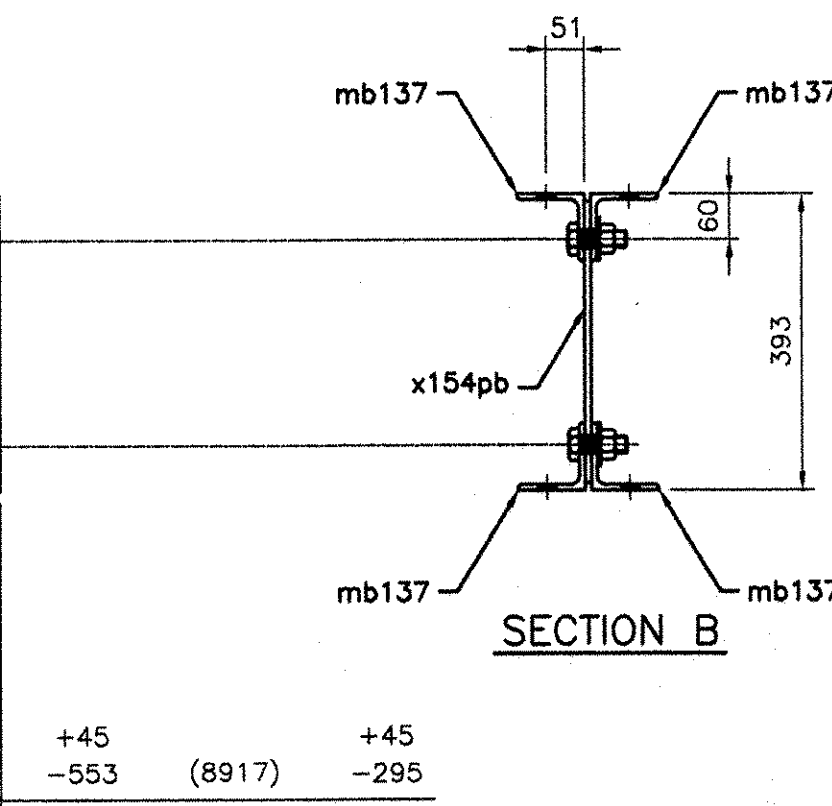
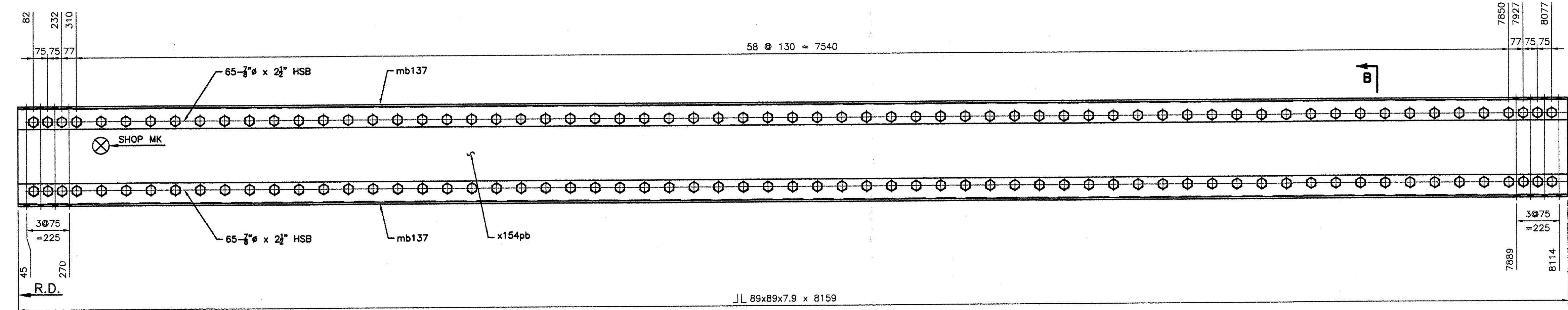

4 -TOP LATERAL BRACE ASSEMBLIES - 137TL2

BOLTS LIST		
QTY	DESCRIPTION	LENGTH
	SHOP BOLTS LIST	
1032	7/8" HSB	2 1/2

- NOTES:
- 1- GENERAL NOTES: SEE GN101
 - 2- HOLES: 15/16" (24#) (UN)
 - 3- ALL HS BOLTS SHALL BE A325 TYPE 1 GALVANIZED C/W 1 NUT & 1 WASHER (UN)
 - 4- ALL STEEL SHALL BE GALVANIZED, SEE GN101
 - 5- ALL SHOP BOLTS SHALL BE HAND TIGHTEN
 - 6- ALL HOLES SHALL BE "CNC" DRILLED (UN)
 - 7- WIRE-BRUSH PREPARATION 3" OF OPEN HOLES FOR FAYING SURFACES PRIOR TO BOLTING

RESERVED FOR STAMPS

REV	DATE	DESCRIPTION	QTY	DATE	ISSUED TO	FOR
			8	4/8/05	F.W. Whitcomb Construction	Approval

NOTICE
This drawing shall not be used or reproduced in any manner, nor shall any similar drawings or structures be made therefrom, nor shall the information thereon be used for any purpose other than that for which it is released without the written consent of an officer of EASTERN BRIDGE LLC.

EASTERN BRIDGE LLC
RURAL RTE 2, BOX 302
CLAREMONT, NH 03743
603-542-5202

PROJECT: ROUTE 100 OVER THE WEST RIVER
 LOCATION: TOWN OF JAMAICA
 ENGINEER: CLD CONSULTING ENGINEERS
 CUSTOMER: VERMONT A. O. T.
 DRAWING TITLE: TOP LATERAL BRACINGS
 DRAWN BY: BR 03/01/05 JOB NUMBER: 5075 SHEET NUMBER: 137
 CHECKED BY: GG 04/04/05