

APPROACH SLAB NO. 1

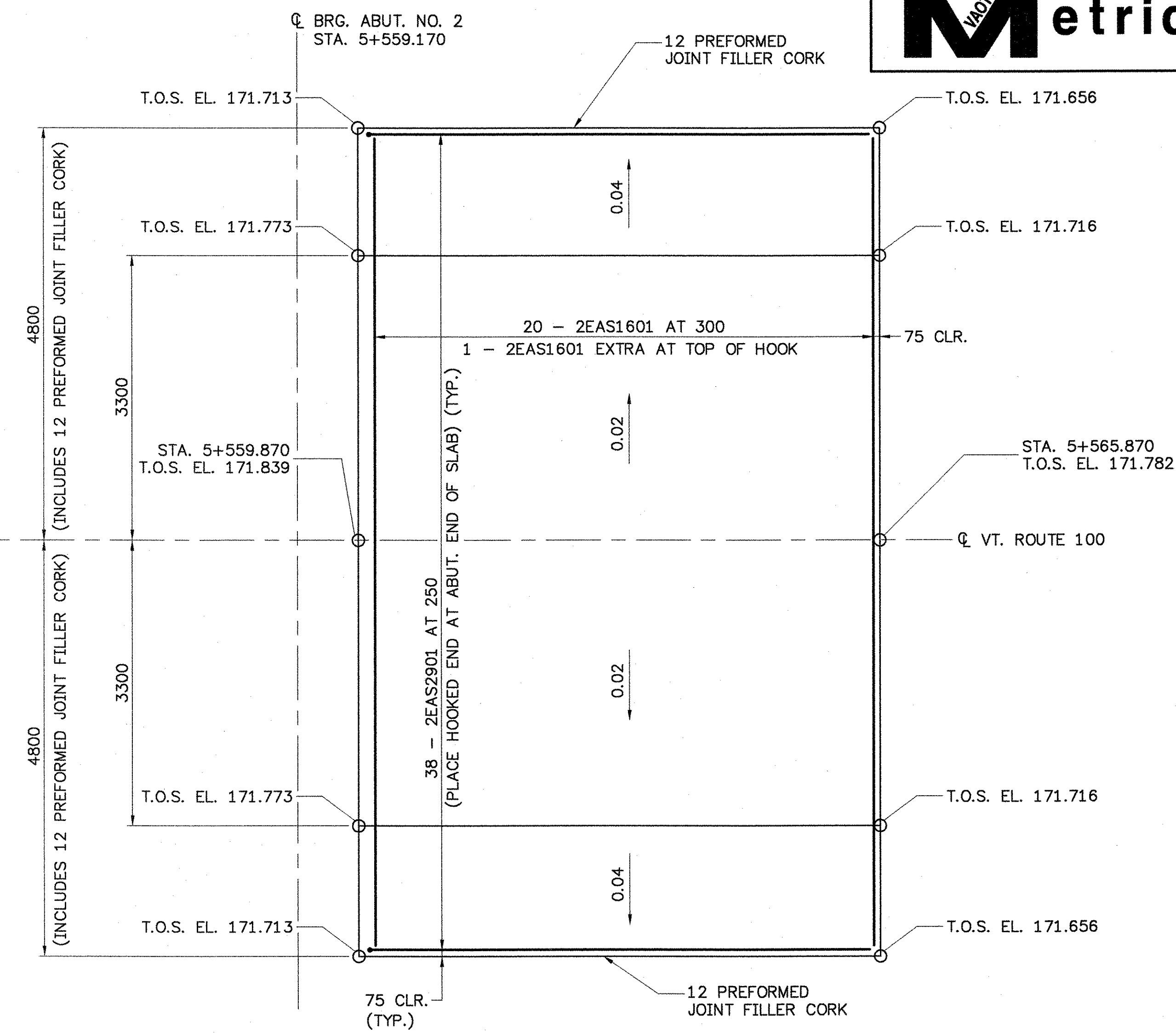

APPROACH SLAB NO. 2

APPROACH SLAB PLAN
SCALE 1:40

NOTE: T.O.S. DENOTES TOP OF SLAB

NOTE: TWO COATS OF POLYURETHENE MEMBRANE SHALL BE PLACED 100 WIDE ALONG THE APPROACH SLAB. THE SHEET MEMBRANE WATERPROOFING (MOD. TORCH APPLIED) AND THE POLYURETHENE MEMBRANE SHALL OVERLAP 50. SEE SECTION 519.05(B) OF THE 2001 STANDARD SPECIFICATIONS.

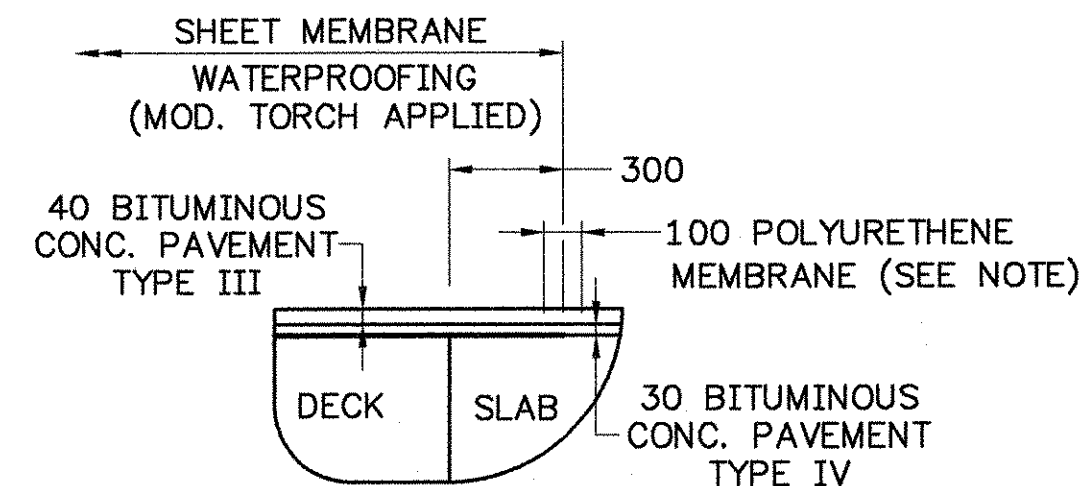

DETAIL FOR SHEET MEMBRANE
(ABUTMENT NO. 2 SHOWN, ABUTMENT NO. 1 SIMILAR)
SCALE 1:20

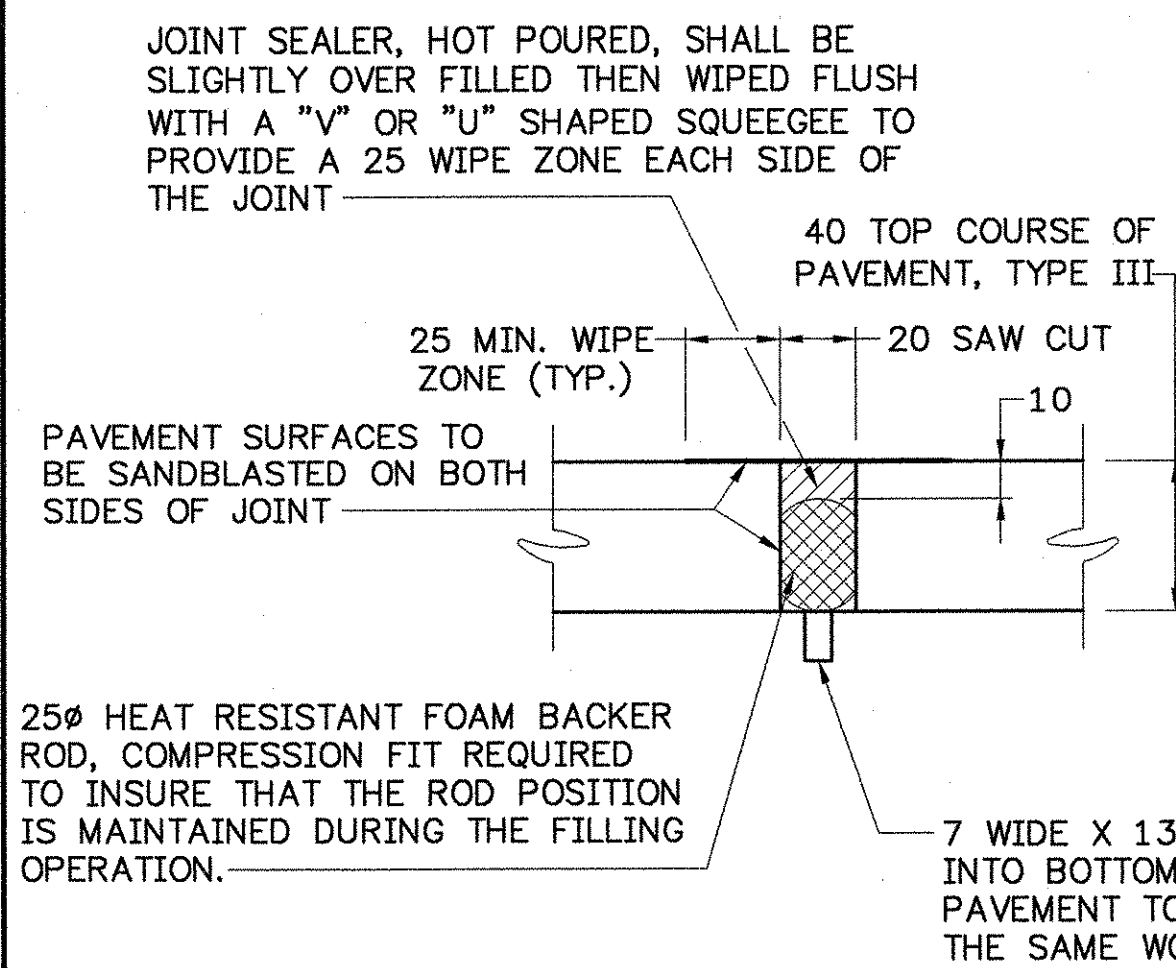

SAW CUT JOINT DETAIL
SCALE 1:2

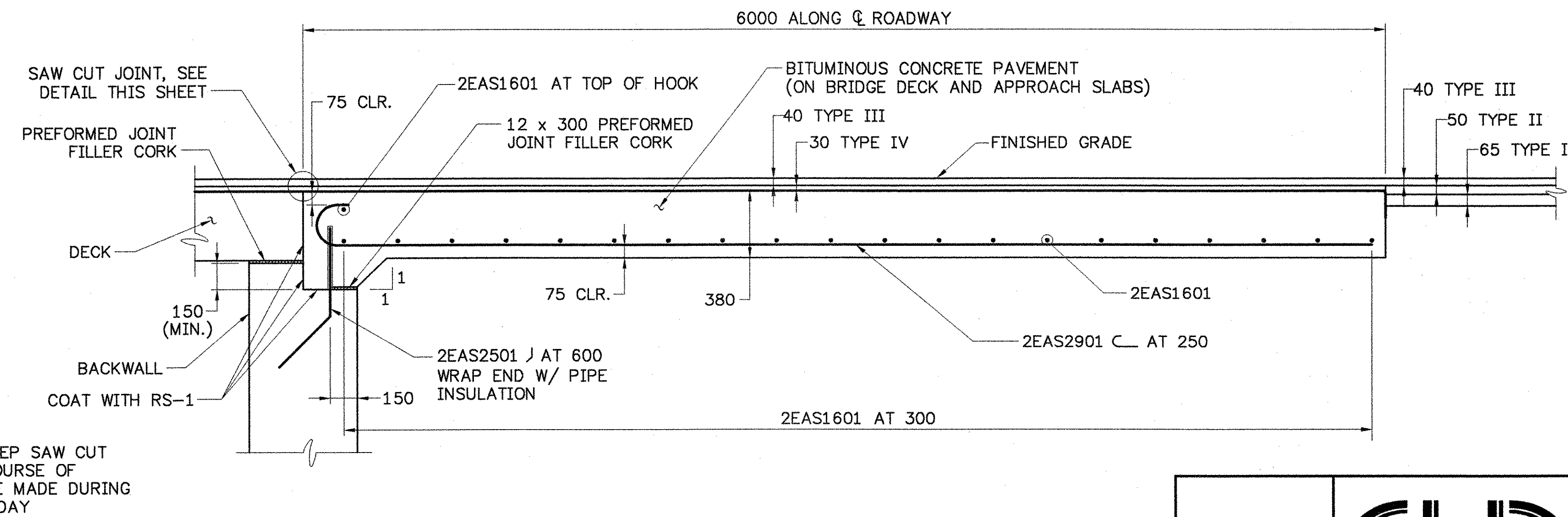

APPROACH SLAB DETAIL
SCALE 1:20

540 Commercial St.
Manchester, NH 03101
PH: (603) 668-8223
FAX: (603) 668-8802
E-MAIL: CLD@CLDENGINEERS.COM

STATE OF VERMONT AGENCY OF TRANSPORTATION			
Town Of	JAMAICA	Bridge No.	80
Highway No.	VT. ROUTE 100	Log Sta.	
		Surv. Sta.	
VT. ROUTE 100 OVER THE WEST RIVER			
APPROACH SLAB DETAILS			
Designed By	JH	Drawn By	MWS
Checked By	RMR	Date	2/02
		Bridge Design Supervisor	LMM Date 2/02
PROJECT	JAMAICA	PROJECT NO.	BRF 013-1(8)
I.G.C. Info.			
Bridge Sheet No.		Sheet	85 Of 116

9028APP.dwg (1=1)