

STEEL BEAM GUARDRAIL
 STA 5+600.0 TO 5+642.8 LT
 STA 5+600.0 TO 5+612.4 RT
 STA 3+994.0 TO 4+005.4 RT (VT ROUTE 100/30)

MODIFIED ECCENTRIC LOADER TERMINAL
 STA 5+612.4 TO 5+623.8 RT
 STA 5+642.8 TO 5+654.2 LT
 STA 4+005.4 TO 4+016.8 RT (VT ROUTE 100/30)

CONSTRUCT DRIVE
 STA 5+630 RT - 4.2 m WIDE PAVED

EXCAVATION OF SURFACES & PAVEMENTS
 STA 5+748 RT TO 5+765 RT

REMOVAL & DISP. OF GUARDRAIL
 STA 5+600 TO 5+644 LT
 STA 3+994 TO 4+002 LT (VT ROUTE 100/30)

**KONOPAS, DOROTHY M.
 WONDROFSKI, HERMAN F.**

CURVE DATA
 Δ = 22°13'20"
 R = 422.10
 T = 82.898
 L = 163.71
 E = 8.06
 BANK = 0.045

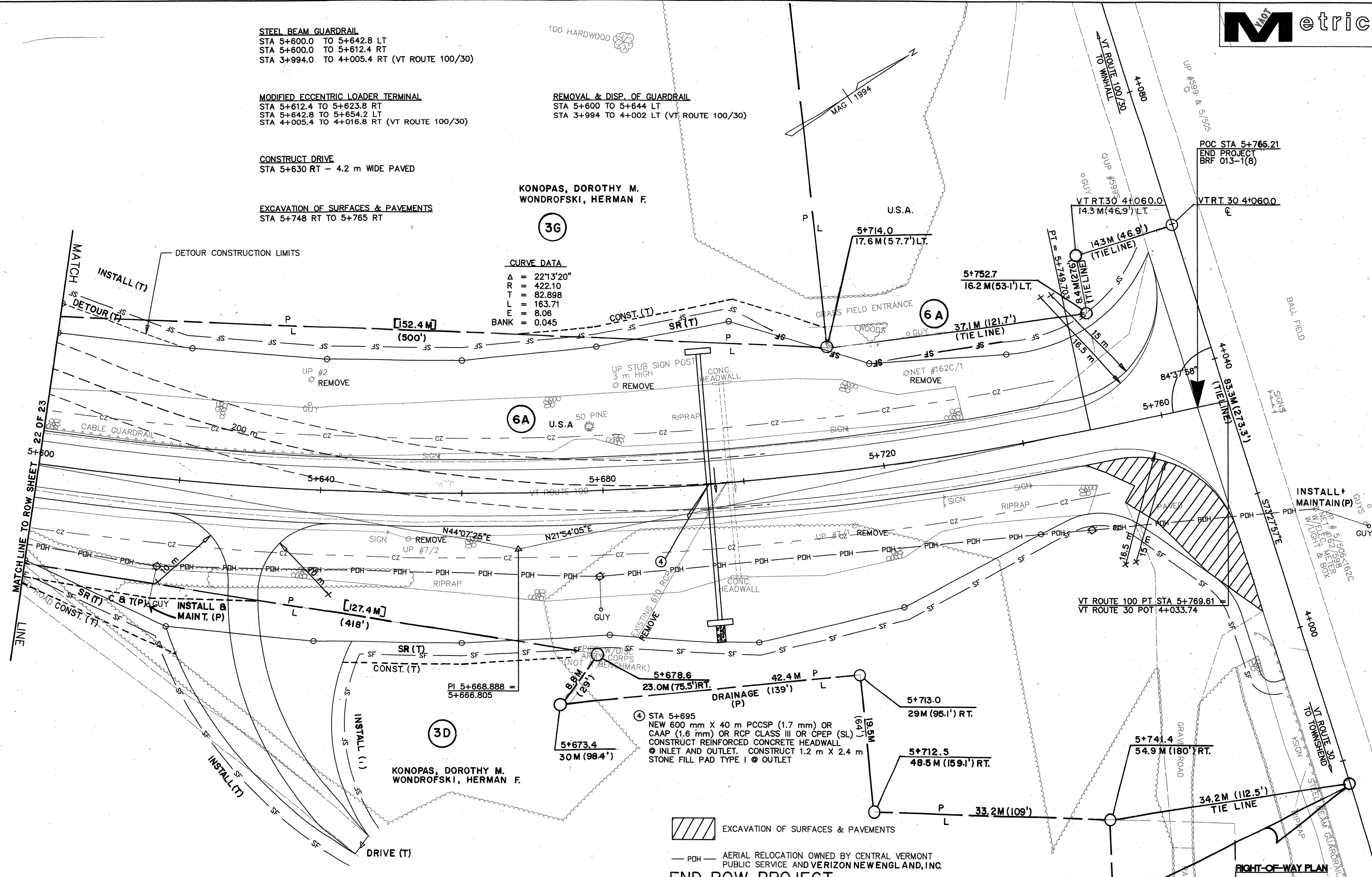

EXCAVATION OF SURFACES & PAVEMENTS
 AERIAL RELOCATION OWNED BY CENTRAL VERMONT PUBLIC SERVICE AND VERIZON NEW ENGL AND, INC.

END ROW. PROJECT
BRF 013-1(8) STA. VT. RTE. 30 3+076.7 CL.

LINES SHOWN ON THIS PLAN AS EXISTING PROPERTY LINES (P/L) ARE BELIEVED TO BE ACCURATE BUT SHOULD NOT BE RELIED UPON FOR PURPOSES UNRELATED TO THE STATE OF VERMONT'S ACQUISITION OF LAND AND RIGHTS FOR THIS PROJECT.

DATUM

VERTICAL	NGVD 1929
HORIZONTAL	N/A

SF = SILT FENCE
 FC = FILTER CURTAIN
 □ = HAY BALE

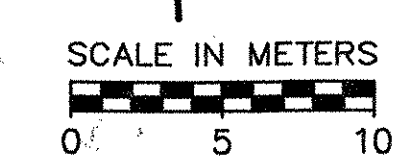

RIGHT-OF-WAY PLAN

SURVEYED BY	CLD	DATE	10/94
DRAWN BY	SMC	DATE	10/97
SQUAD LEADER	JAW		
DESIGN FILE NO.	90284		
IPARM	DATE		
FILE	PLOTTED		
PROJ. NAME	JAMAICA		
PROJ. NO.	BRF 013-1(8)		