

BORING NO. B-1

ELEV. 103.5

DEPTH	BLOWS ON CASING	STANDARD PENETRATION TEST NUMBER	MOISTURE	COLOR	LABORATORY CLASSIFICATION OF SOIL
0					LL PI
10	3		W	Br	No Sample
19			M	Br	A-4 Silty Silt
20	3		"	Gr	No Sample
21	1		M to W	"	A-6 Silty Clay 39 19
22	0		"	"	A-6 Silty Clay 40 19
23	1		"	"	A-4 Silt 25 NV
24	0		"	"	A-4 Silt 26 NV
25	1		"	"	A-4 Clayey Silt 25 8
26	1		"	"	A-4 Clayey Silt 27 8
27	3		"	"	A-6 Silty Clay 31 13
28	1		"	"	A-7-6 Clay 55 34
29	25		"	"	A-4 Silt ML NV
30	8		"	"	A-1-a Sandy Gravel
31			"	"	No Sample
32	98		"	"	Boulders
33	100 for 0.2		"	"	A-1-a Sandy Gravel
34	100 for 0.2		"	"	Boulders
35	100 for 0.2		"	"	Boulders
36	100 for 0.2		"	"	A-2-4 Silty Sand
37					Hole Stopped at 80.3' in silty sand & boulders
38					NLTD

BORING NO. B-2

ELEV. 105.8

BOTTOM OF WING #2

ELEV. 90.0

DEPTH	BLOWS ON CASING	STANDARD PENETRATION TEST NUMBER	MOISTURE	COLOR	LABORATORY CLASSIFICATION OF SOIL
0					LL PI
10					Boulders
11					Boulders
12					Boulders
13	7		M	Br	A-7-6 Clay 44 24
14	1		"	Gr	A-7-6 Clay 43 24
15	2		"	"	A-7-6 Clay 42 27
16	2		W	"	A-4 Silt 28 5
17	1		"	"	No Sample
18	3		M to W	"	A-4 Clayey Silt 26 8
19	2		"	"	A-4 Clayey Silt 27 7
20	3		"	"	A-6 Silty Clay 38 16
21	5		"	"	No Sample
22	63		W	Br	A-4 Silt
23			M	Cr	A-2-4 Silty Sand
24	65		"	"	A-2-4 Silty Sand
25			"	"	A-2-4 Silty Sand
26			"	"	A-2-4 Silty Sand
27					Hole stopped at 72.3' in silty sand

BORING NO. B-3

ELEV. 105.2

BOTTOM OF WING #3

ELEV. 90.0

DEPTH	BLOWS ON CASING	STANDARD PENETRATION TEST NUMBER	MOISTURE	COLOR	LABORATORY CLASSIFICATION OF SOIL
0					LL PI
10					No Samples
20	5		M	Cr	A-6 Silty Clay 37 19
21	5		"	"	A-6 Silty Clay 39 18
22	7		M to W	"	A-4 Silt 24 4
23	2		W	"	A-7-6 Clay 47 27
24	1		"	"	No Sample
25	1		"	"	A-4 Clayey Silt 30 10
26	2		"	"	No Sample
27	27		M to W	"	A-2-4 Silty Gravel
28	78		"	"	A-1-b Silty Gravel
29	98		"	"	No Sample
30			"	"	A-2-4 Silty Sand
31					Hole stopped at 57.5' in silty sand HP

BORING NOMENCLATURE

STANDARD PENETRATION BORINGS:
 SAMPLER OUTSIDE DIAMETER 2"
 SAMPLER INSIDE DIAMETER 1 3/8"
 WEIGHT OF HAMMER 140 LBS
 HAMMER FALL 30"

No	STATION	OFFSET	GROUND ELEVATION
B-1	223+0	Et. 20'	103.5
B-2	224+78	Et. 15'	105.8
B-3	226+26	Lt. 17'	105.2
B-4	228+0	Et. 15'	103.8
B-5	228+0	Lt. 18'	103.5
B-6	224+0	Et. 30'	100.8

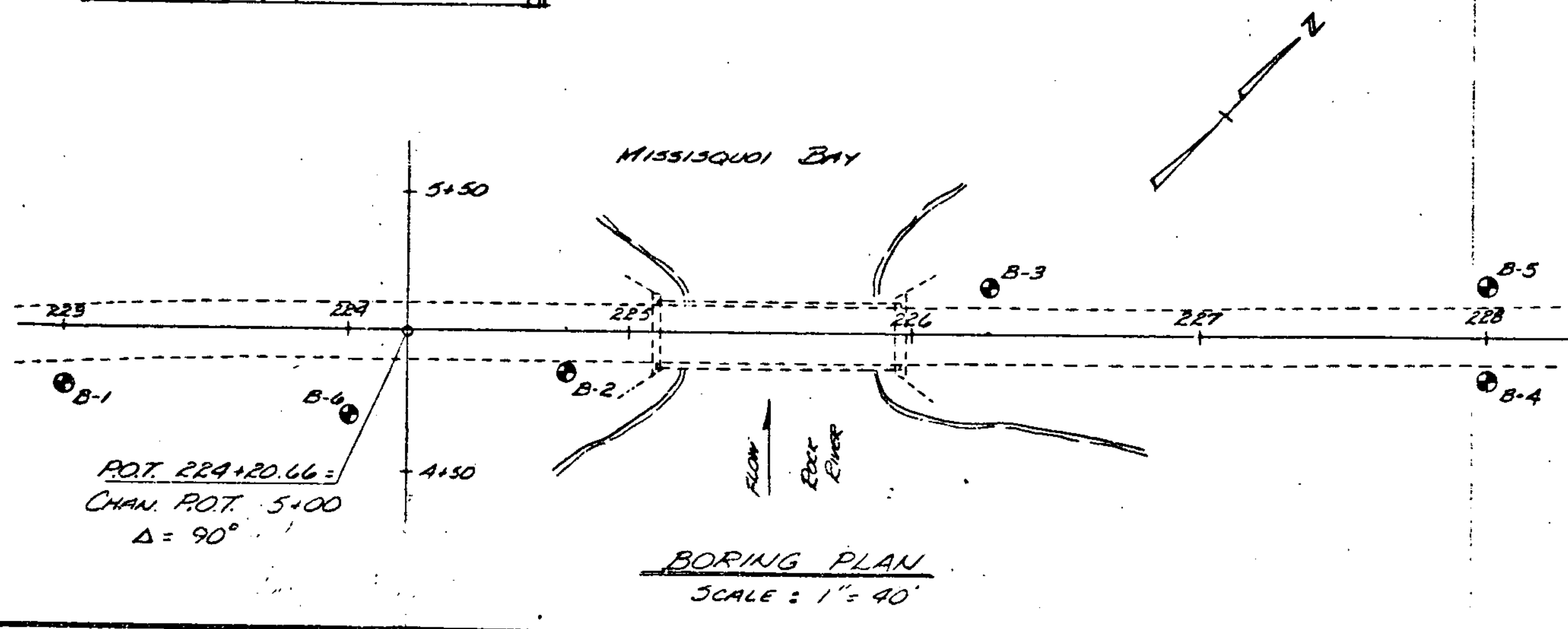

STATE OF VERMONT
AGENCY OF TRANSPORTATION

TOWN OF HIGHGATE Bridge No. 182
 Log Sta. 225+52.0

HIGHWAY NO. U.S. RTE. #7 Surv. Sta. 225+53.0
U.S. RTE #7 OVER ROCK RIVER

BORING LOGS

Designed by G.V. SPILAK Drawn by M. GARCIA
 Checked by A. EDWARDS date 10/83 Bridge Design Supervisor R.S. HAUPT date _____

PROJECT HIGHGATE PROJECT NO. B25 0285(1)5
 Bridge Sheet No. 32102 Sheet 15 of 64